

CURVED LINE TABLE				
NO.	CHORD		RADIUS	ARC
	BEARING	DIST.		
1	336° 08' 37"	26.694	350.0	26.7
2	340° 30' 52"	26.694	350.0	26.7
3	344° 53' 07"	26.694	350.0	26.7
4	349° 15' 22"	26.694	350.0	26.7
5	353° 37' 37"	26.694	350.0	26.7
6	357° 59' 53"	26.694	350.0	26.7
7	179° 27' 03"	9.333	365.0	9.333
8	176° 48' 40"	24.296	365.0	24.3
9	172° 59' 48"	24.296	365.0	24.3
10	169° 10' 56"	24.296	365.0	24.3
11	165° 22' 03"	24.296	365.0	24.3
12	161° 38' 50"	23.096	365.0	23.1
13	158° 01' 16"	23.096	365.0	23.1
14	154° 23' 42"	23.096	365.0	23.1
15	177° 51' 22"	23.094	300.0	23.1
16	150° 46' 08"	23.096	365.0	23.1
17	148° 29' 06"	6.0	365.0	6.0

G.N. M.G.A.

(SE) EASEMENT TO DRAIN SEWAGE VARIABLE WIDTH
 (DE) EASEMENT TO DRAIN WATER VARIABLE WIDTH
 LOT 520 IS BENEFITED BY AN EASEMENT TO DRAIN WATER VARIABLE WIDTH CREATED BY D.P. 1076055
 (RB) RESTRICTIONS ON THE USE OF LAND (D.P.1076055)
 (DV) EASEMENT TO DRAIN WATER VARIABLE WIDTH (D.P.1079636)

REFERENCE MARK TABLE				
COR	BEARING	DIST.	FROM	ORIGIN
BT	129° 40' 14"	20.894	S.S.M.145122 FD.	
BU	280° 34' 15"	13.538	D.H. & W FD	
BV	341° 25' 30"	23.596	D.H. & W FD	
BW	232° 15'	4.804	D.H. & W FD	
BX	222° 26'	14.19	D.H. & W FD	
BV	115° 23' 25"	22.535	P.M.124305 FD.	
BX	188° 20'	0.914	G.I. PIPE FD	D.P.229283
FC	219° 07' 50"	3.989	S.S.M.145130 FD.	D.P.1079636
EA	122° 00' 40"	19.03	S.S.M.145132	
EB	329° 04'	6.583	D.H. & W	
EB	295° 53' 40"	12.81	D.H. & W	
EC	339° 59' 10"	9.873	D.H. & W	
EC	268° 14' 10"	11.483	D.H. & W	
ED	231° 32' 20"	4.255	S.S.M.145131	
EF	162° 47'	23.922	D.H. & W FD.	D.P.1079636
EF	203° 04'	15.173	D.H. & W FD.	D.P.1079636

P.M. / S.S.M. CONNECTIONS			
FROM	TO	BEARING	DISTANCE
S.S.M.145122	S.S.M.145132	275° 11' 20"	91.899
S.S.M.145132	P.M.124305	43° 22' 12"	66.868
P.M.124305	S.S.M.145122	141° 17' 56"	72.935
P.M.129249	S.S.M.145130	13° 33' 54"	35.385
S.S.M.145130	S.S.M.145131	337° 55' 11"	121.401
P.M.124305	P.M.129249	180° 02' 19"	315.785 M.G.A.
S.S.M.145131	S.S.M.145132	180° 02' 20"	315.778 OBS'D
S.S.M.145131	S.S.M.145132	356° 01' 10"	120.565

DP1079638

Registered: 14-3-2005

This is sheet 2 of my plan in 2 sheets dated 24-02-2005

MARGUS A. RATSEP DATE 24-2-2005
 VOERMAN & RATSEP, P.O. BOX 16, BATHURST
 Surveyor registered under the Surveying Act, 2002

This is sheet 2 of my plan of 24 sheets covered by subdivision certificate No. 6105 of 25-2-2005

Authorised Person/General Manager/Registered Practitioner

For use where space is insufficient in any panel on Plan Form 2

SEE REPLACEMENT SHEET 4 THIS SHEET FOR SEALS & SIGNATURES ONLY

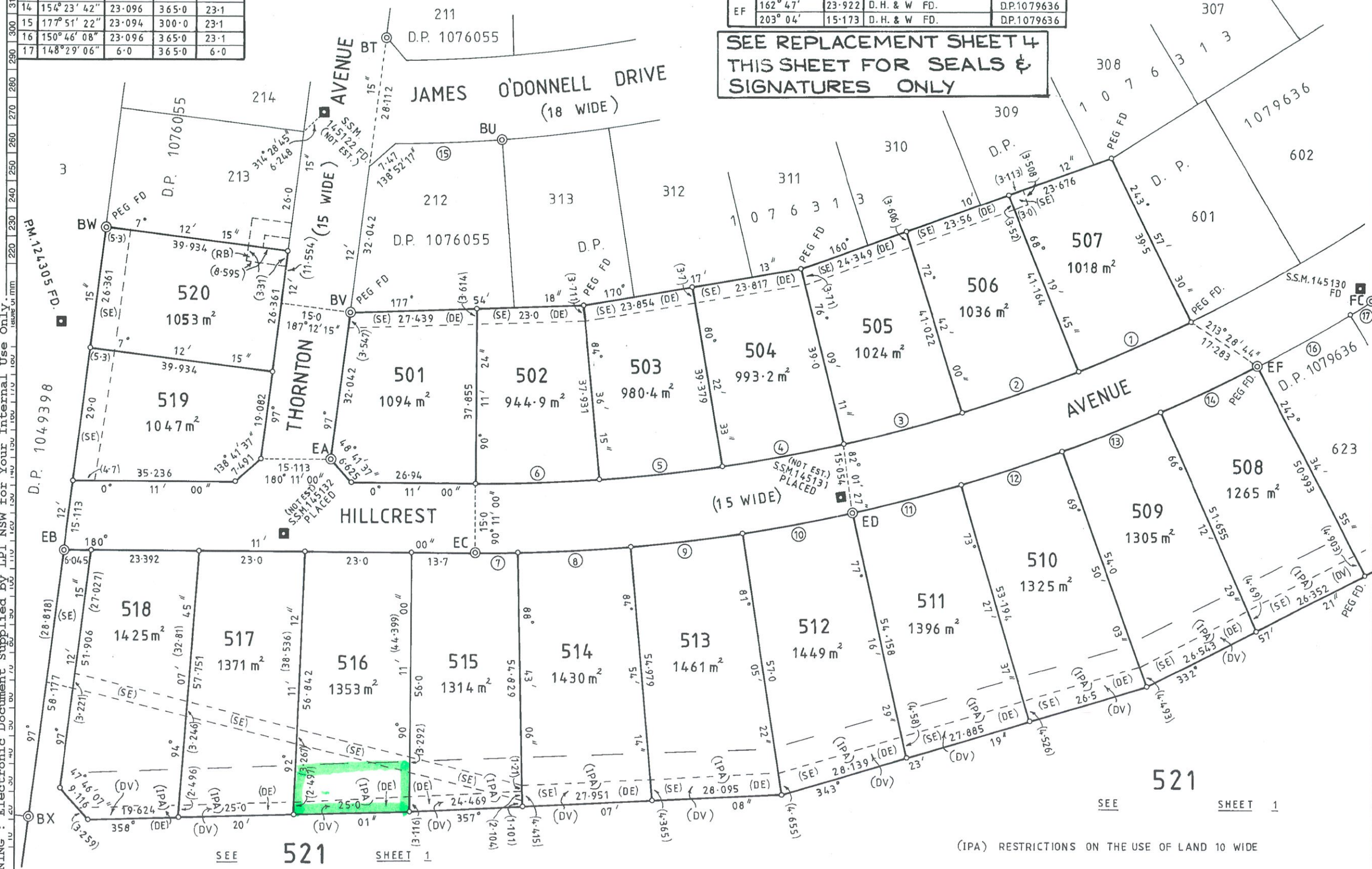

SEE SHEET 1

(IPA) RESTRICTIONS ON THE USE OF LAND 10 WIDE

Reduction Ratio 1: 600