

PROPOSED SERVICE STATION AT 353 MAIN STREET LITHGOW NSW 2790 FOR MAIN STREET CAP PTY LTD .

GENERAL NOTES

- G1. THESE DRAWINGS ARE TO BE READ IN CONJUNCTION WITH ARCHITECTURAL AND OTHER CONSULTANTS DRAWINGS AND SPECIFICATIONS. ANY DISCREPANCIES ARE TO BE REFERRED TO THE ARCHITECT BEFORE PROCEEDING WITH THE WORK.
- G2. DIMENSIONS SHALL NOT BE OBTAINED BY SCALING THE STRUCTURAL DETAILS AND ALL DIMENSIONS TO BE VERIFIED BY THE BUILDER PRIOR TO COMMENCEMENT OF THE WORK.
- G3. REFER TO ARCHITECTURAL DRAWINGS FOR SLAB LEVELS AND ARCHITECTURAL DETAILS.
- G4. DURING CONSTRUCTION THE BUILDER IS RESPONSIBLE FOR MAINTAINING THE STRUCTURE IN A STABLE CONDITION WITHOUT OVERSTRESSING ANY PART.
- G5. COMPLY WITH AS 3660 PROTECTION OF BUILDING FROM SUBTERRANEAN TERMITES.
- G6. ALL WORKMANSHIP AND MATERIALS TO BE IN ACCORDANCE WITH THE BUILDING CODE OF AUSTRALIA.

STORM WATER NOTES:

1. STORM WATER DRAINAGE SHALL BE GENERALLY IN ACCORDANCE WITH CURRENT AUSTRALIAN STANDARDS AND LITHGOW CITY COUNCIL SPECIFICATIONS.
2. PRIOR TO COMMENCEMENT OF WORKS THE CONTRACTOR SHALL SATISFY HIMSELF OF THE CORRECT LOCATION OF EXISTING SERVICES WHETHER INDICATED OR NOT ON THE PLANS. ANY DAMAGE TO EXISTING SERVICES SHALL BE RECTIFIED AT THE CONTRACTORS EXPENSE.
3. TRAFFIC MANAGEMENT MEASURES HAVE TO BE IMPLEMENTED AND MAINTAINED DURING CONSTRUCTION, ALL IN ACCORDANCE WITH COUNCIL'S REQUIREMENTS. THE CONTRACTOR SHALL MAINTAIN SAFE PEDESTRIAN ACCESS ALONG THE FOOTPATH.
4. THE CONTRACTOR SHALL EFFECT TEMPORARY DRAINAGE MEASURES TO AVOID LOCALIZED PONDING OF SURFACE RUN-OFF.
5. REFER TO ARCHITECT'S DRAWINGS FOR ALL DETAILS (LEVELS, GRADING ETC.) OF DRIVEWAYS, CONCRETE AND PAVED AREAS, AND RETAINING WALL TYPES AND LOCATIONS.
6. REFER TO LANDSCAPE ARCHITECT'S DRAWINGS FOR DETAILS AND EXTENT OF ALL LANDSCAPED AREAS.
7. ALL SWT PIPES ARE UPVC AT 1.0% MINIMUM GRADE (UNO).
8. SWT PITS CAN BE PRE-CAST SIZED AS FOLLOWS:
450mm SQ. UP TO 600mm DEEP
600mm SQ. UP TO 1000mm DEEP
9. ALL PITS LOCATED IN TRAFFICABLE AREAS, (IE, DRIVEWAYS) TO HAVE MEDIUM DUTY GRATED COVERS SUITABLE FOR WITHSTANDING LOADS ASSOCIATED WITH SMALL TRUCKS.
10. PROVIDE STEP IRONS TO ALL PITS GREATER THAN 1.2m DEEP.
11. THE CONTRACTOR SHALL IMPLEMENT ALL SOIL EROSION AND SEDIMENT CONTROL MEASURES PRIOR TO COMMENCEMENT OF WORKS.
12. TOPSOIL SHALL BE STRIPPED DN STOCKPILED OUTSIDE HAZARD AREAS SUCH AS DRAINAGE LINES. THIS TOPSOIL IS TO BE RESPREAD LATER ON AREAS TO BE REVEGETATED.
13. THE CONTRACTOR SHALL REGULARLY MAINTAIN ALL SEDIMENT AND EROSION CONTROL DEVICES AND REMOVE ACCUMULATED SILT FROM SUCH DEVICES. ALL SILT REMOVED SHALL BE DISPOSED OF AS DIRECTED BY THE SUPERINTENDENT. THE PERIOD FOR MAINTAINING THESE DEVICES SHALL BE AT LEAST UNTIL ALL DISTURBED AREAS ARE REVEGETATED AND FURTHER AS MAY BE DIRECTED BY THE SUPERINTENDENT OR COUNCIL.
14. THE CONTRACTOR SHALL MAINTAIN DUST CONTROL UNTIL FINAL COMPLETION OF WORKS.

RAINWATER TANK NOTES (IF APPLICABLE)

- R1. THE TANK IS TO BE INSTALLED IN ACCORDANCE WITH THE MANUFACTURER'S SPECIFICATIONS. THE TANK SHALL BE ENCLOSED AND ANY INLET TO THE TANK SHALL BE SCREENED OR FILTERED TO PREVENT THE ENTRY OF FOREIGN MATTERS OR CREATURES AND FITTED WITH MEASURES TO PREVENT MOSQUITO BREEDING.
- R2. THE RAIN TANK SHALL BE FITTED WITH A FIRST-FLUSH-DEVICE THAT CAUSES THE INITIAL RUN-OFF FROM ANY RAIN EVENT TO BYPASS THE TANK IN ORDER TO REDUCE THE POLLUTANTS ENTERING THE TANK.
- R3. A SIGN SHALL BE AFFIXED TO THE TANK CLEARLY STATING THAT THE WATER IN THE TANK IS RAINWATER AND ALL TAPS AND RAINWATER TANK APERTURES SHALL BE SIMILARLY MARKED.
- R4. DISTRIBUTION PIPES, BOTH BELOW AND ABOVE GROUND, FROM THE RAINWATER TANK SHALL BE CONTINUOUSLY MARKED "RAINWATER" IN ACCORDANCE WITH AS1345 OR OTHERWISE ABOVE-GROUND DISTRIBUTION PIPES SHALL BE CLEARLY LABELED "RAINWATER" WITH ADHESIVE PIPE MARKERS MADE IN ACCORDANCE WITH AS1345 AND BELOW-GROUND DISTRIBUTION PIPES SHALL HAVE IDENTIFICATION TAPE/PIPE SLEEVE CONTINUOUSLY MARKED "RAINWATER" IN ACCORDANCE WITH AS2648.
- R5. THE TANK SHALL COMPLY WITH AUSTRALIAN STANDARD AS/NZS 2179-1944-SPECIFICATIONS FOR RAIN WATER GOODS, ACCESSORIES AND FASTENERS.
- R6. IF THE TANK IS METAL IT SHALL COMPLY WITH AUSTRALIAN STANDARDS AS 2180-1986-METAL RAINWATER GOODS SELECTION AND INSTALLATION.

PUMP OUT NOTES (IF APPLICABLE)

1. THE PUMPS SHALL BE PROGRAMMED TO WORK ALTERNATIVELY SO AS TO ALLOW BOTH PUMPS TO HAVE EQUAL OPERATIONAL LOAD AND PUMP LIFE.
2. A LOW LEVEL FLOAT SHALL BE PROVIDED TO ENSURE THAT THE MINIMUM REQUIRED WATER LEVEL IS MAINTAINED WITH IN THE SUMP AREA. IN THIS REGARD THIS FLOAT WILL FUNCTION AS AN OFF SWITCH FOR THE PUMPS.
3. THE SECOND FLOAT SHALL BE PROVIDED 300MM ABOVE THE MINIMUM WATER LEVEL, WHEREBY ONE OF THE PUMPS WILL OPERATE AND DRAIN THE TANK TO THE LEVEL OF THE LOW-LEVEL FLOAT.
4. A THIRD FLOAT SHALL BE PROVIDED AT A HIGHER LEVEL WHICH IS APPROXIMATELY THE ROOF OF THE TANK. THIS FLOAT SHOULD START THE OTHER PUMP THAT IS NOT OPERATING AND ACTIVATE THE ALARM.
5. AN ALARM SYSTEM SHALL BE PROVIDED WITH A FLASHING STROBE LIGHT AND A PUMP FAILURE SIGN WHICH ARE TO BE LOCATED AT THE DRIVEWAY ENTRANCE TO THE BASEMENT LEVEL. THE ALARM SYSTEM SHALL BE PROVIDED WITH A BATTERY BACK-UP IN CASE OF POWER FAILURE.

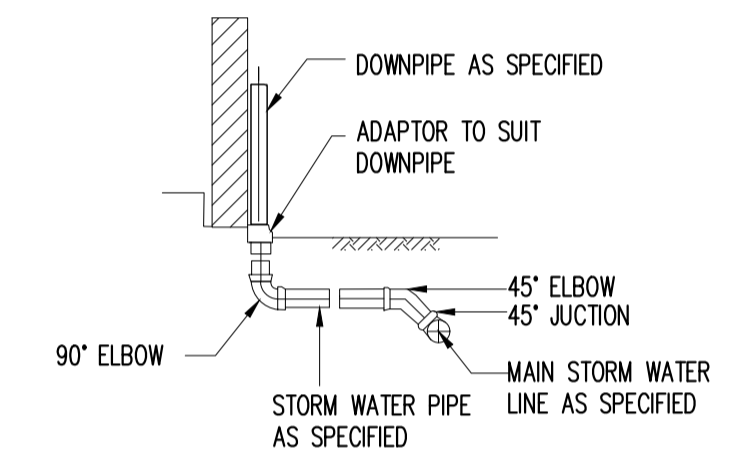

TYPICAL DETAIL- DOWN PIPE CONNECTION
SCALE N.T.S.

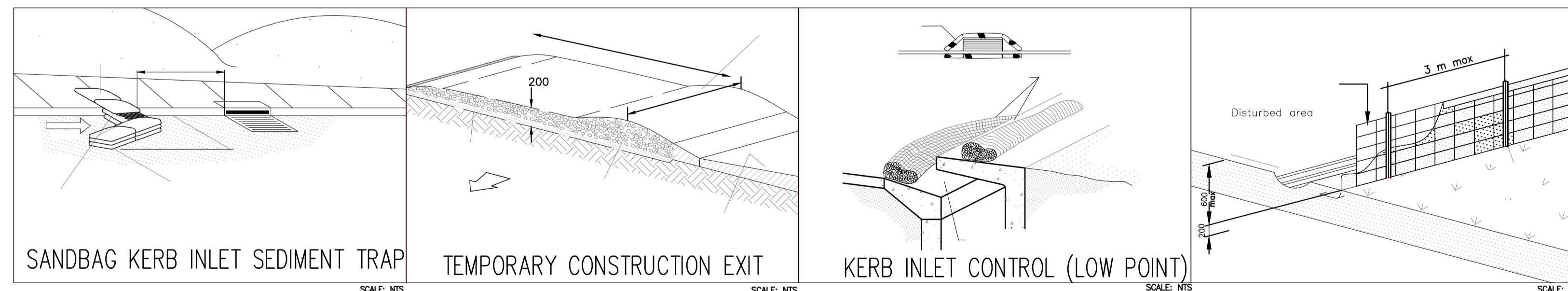

neillydavies consulting engineers Suite 12-15/141 Walker St, North Sydney
Tel: (02) 9922 5501 Email: info@neillydavies.com.au
ABN 71121623550

COPYRIGHT
THIS DOCUMENT IS & SHALL REMAIN THE PROPERTY OF NEILLY DAVIES & PARTNERS CONSULTING ENGINEERS. THE DOCUMENT MAY ONLY BE USED FOR THE PURPOSE FOR WHICH IT WAS COMMISSIONED. IT MUST NOT BE USED, REPRODUCED OR COPIED IN WHOLE OR IN PART WITHOUT PRIOR WRITTEN CONSENT OF THE COMPANY.

PROJECT STATUS		FOR DEVELOPMENT APPLICATION (DA)	
CLIENT		MAIN STREET CAP PTY LTD	
PROJECT ADDRESS		PROPOSED SERVICE STATION AT 353 MAIN STREET LOTHGOW NSW 2790	
SHEET INFO		CONSTRUCTION NOTES - HYDRAULIC	
DESIGNED	ST	DRAFTED	SJ
CHECKED		APPROVED	B.M
SHEET NO	C01	SCALES	AS SHOWN
START DATE		START DATE	22-12-2023
PLT DATE		PLT DATE	18-12-2024
SHEET SIZE	A0	DO NOT ATTEMPT TO SCALE FROM THESE DRAWINGS	
PROJECT NO		J240025	

A	ST	SJ	BM	18-12-24	FOR DEVELOPMENT APPLICATION (DA)
REV	DESIGNED	DRAWN	APPROVED	DATE	DESCRIPTION

IMPERVIOUS AREA	
TOTAL SITE AREA	= 2075.88 SQ m.
EXISTING DEVELOPMENT	=
ROOF AREA	= 0.00 SQ m
PAVED AREA	= 29.77 SQ m.
POOL AREA	= 0.00 SQ m.
TOTAL IMPERVIOUS AREA	= 29.77 SQ m.
IMPERVIOUS AREA %	= 1.43 %
PROPOSED DEVELOPMENT	=
ROOF AREA	= 346.82 SQ m.
PAVED AREA	= 1492.33 SQ m.
POOL AREA	= 0.00 SQ m.
TOTAL IMPERVIOUS AREA	= 1839.15 SQ m.
IMPERVIOUS AREA %	= 88.59 %

LEGEND	
	NETWORK FOR STORMWATER
	NETWORK FOR OIL SEPARATOR
	PROPOSED 100# DOWN PIPE
	GRATED DRAIN
	INVERT LEVEL = RL 45.50
	FALL DIRECTION
	BOUNDARY LINE
	PROPOSED LEVEL
	EXISTING LEVEL
	PROPOSED SURFACE INLET PITS
	ROOF

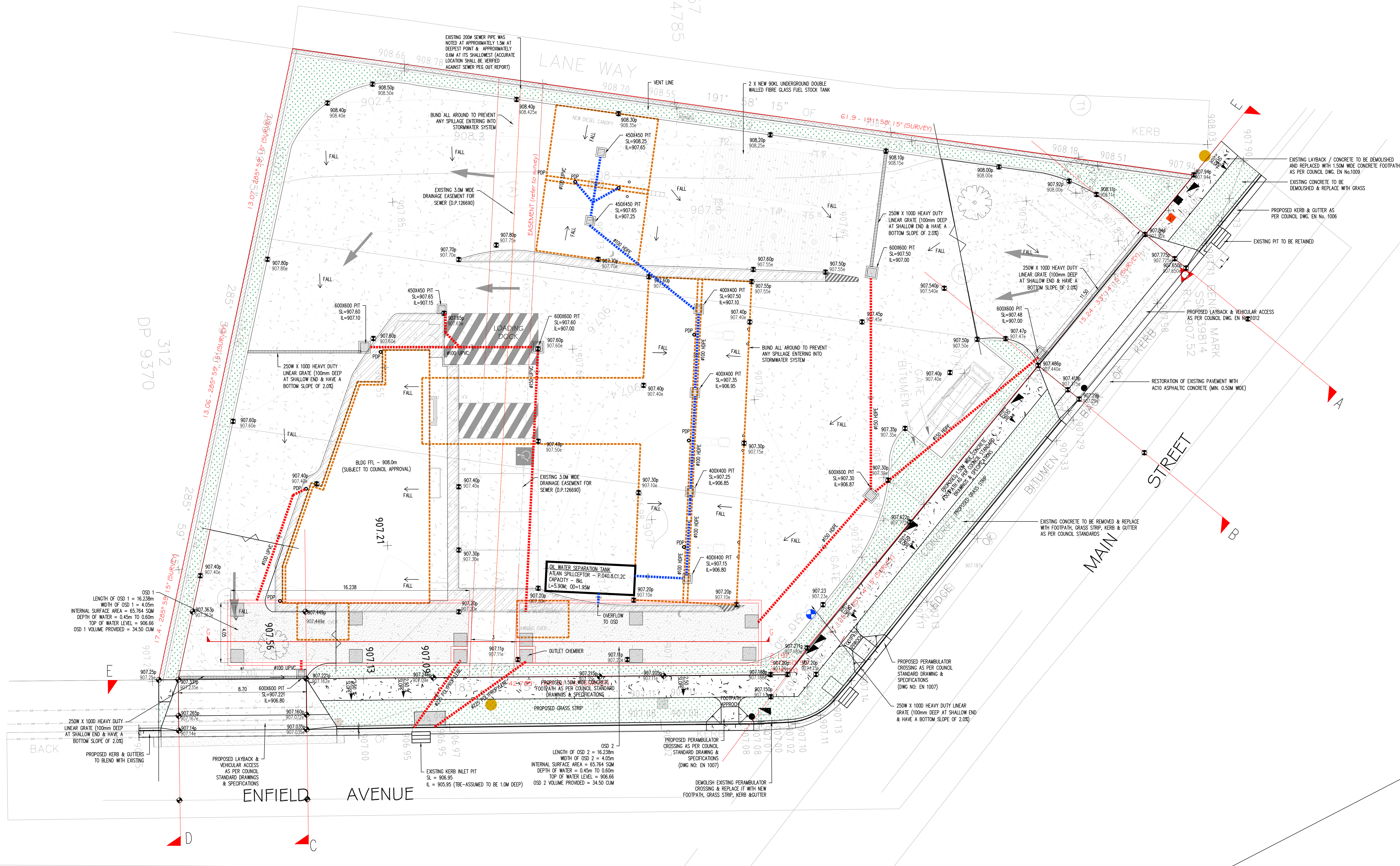

NOTES:

- ALL WORKS TO BE CONSTRUCTED TO THE REQUIREMENTS AND SATISFACTION OF COUNCIL.
- PRIOR TO COMMENCEMENT OF ANY SITE WORKS, THE BUILDER/PLUMBER IS TO EXPOSE ALL SERVICES IN THE FULL WIDTH OF THE FOOTPATH TO ENSURE THERE ARE NO OBSTRUCTIONS IN THE LINE OF THE DRAINAGE DISCHARGE PIPE.
- THE DRAINAGE CONTRACTOR IS TO LOCATE AND RELOCATE AS NECESSARY ALL SERVICES ON SITE.
- THE BUILDER IS TO VERIFY ALL LEVELS ON SITE PRIOR TO COMMENCING CONSTRUCTION.
- SILT FENCE IS TO BE ERRECTED PRIOR TO COMMENCING WORK. FENCE TO BE MAINTAINED IN WORKING ORDER DURING TIME OF CONSTRUCTION.
- W.A.E. DRAWING BY A REGISTERED SURVEYOR IS REQUIRED PRIOR TO CERTIFICATION OF DRAINAGE.
- ALL DOWNPIPES ARE TO BE Ø100 U/L/D.
- ALL PIPES TO BE Ø100 uPVC U/L/D WITH 1% MIN. SLOPE.
- POLYMER STORM WATER PIPS SHALL BE USED, TO COUNCIL'S STANDARDS.
- THESE PLANS SHALL BE READ IN CONJUNCTION WITH THE ARCHITECTURAL PLANS & FLOOD RISK ASSESSMENT REPORT. ANY DEVIATIONS NOTICED, SHALL BE VERIFIED WITH ENGINEER FOR FURTHER CLARIFICATION.

NOTES:

- THE EXISTING GUTTER & ROAD LEVELS ARE INTERPOLATED FROM DETAILS IN THE SURVEY. THESE LEVELS ARE TO BE VERIFIED PRIOR TO THE COMMENCEMENT OF ANY WORKS ON SITE.
- NECESSARY APPROVAL FROM COUNCIL SHALL BE OBTAINED PRIOR TO THE COMMENCEMENT OF ANY WORKS ON SITE.
- THESE DRAWINGS ARE TO BE REVIEWED IN CONJUNCTION WITH THE ARCHITECTURAL DRAWINGS. ANY DEVIATION NOTICED TO BE CLARIFIED BY OFFICE, BEFORE CARRYING OUT THE WORKS.
- UNDERGROUND SERVICES SHALL BE PROTECTED AT ALL TIMES AND DIAL BEFORE YOUR DIG.
- THE DETAILS OF THE LAYBACK & LEVELS ON THE PROPERTY BOUNDARY ARE TO BE APPROVED BY THE COUNCIL.

DRIVEWAY LAYOUT PLAN – ENTRY FROM MAIN STREET

SCALE 1:100



		Suite 12-15/141 Walker St, North Sydney Tel: (02) 9922 5501 Email: info@neillyd Davies.com.au		COPYRIGHT THIS DOCUMENT IS & SHALL REMAIN THE PROPERTY OF NEILLY DAVIES & PARTNERS CONSULTING ENGINEERS. THE DOCUMENT MAY ONLY BE USED FOR THE PURPOSE FOR WHICH IT WAS COMMISSIONED. IT MUST NOT BE USED, REPRODUCED OR COPIED IN WHOLE OR IN PART WITHOUT PRIOR WRITTEN CONSENT OF THE COMPANY.			
PROJECT STATUS		FOR DEVELOPMENT APPLICATION (DA)					
CLIENT		MAIN STREET CAP PTY LTD					
PROJECT ADDRESS		PROPOSED SERVICE STATION AT 353 MAIN STREET LOTHGOW NSW 2790					
SHEET INFO		DRIVEWAY LAYOUT PLAN, DETAILS & STORMWATER MANAGEMENT PLAN					
DESIGNED	ST	DRAWN	SJ	CHECKED	B.M	NOT VALID UNLESS SIGNED AND MARKED AS FOR CONSTRUCTION.	
SHEET NO	C02	SCALES	AS SHOWN	START DATE	22-12-2023	PLOT DATE	18-12-2024
SHEET SIZE	A0	DO NOT ATTEMPT TO SCALE FROM THESE DRAWINGS			PROJECT NO	J240025	

A	ST	SJ	BM	18-12-24
REV	DESIGNED	DRAWN	APPROVED	DATE

FOR DEVELOPMENT APPLICATION (DA)

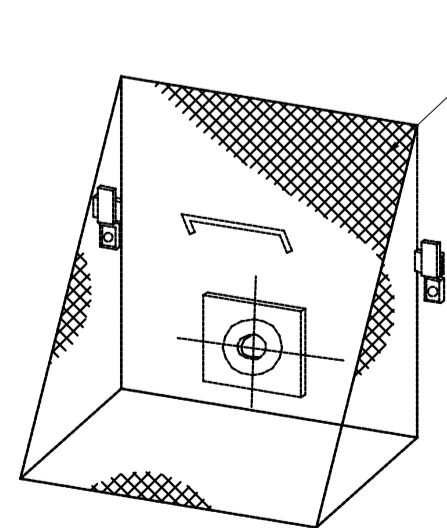
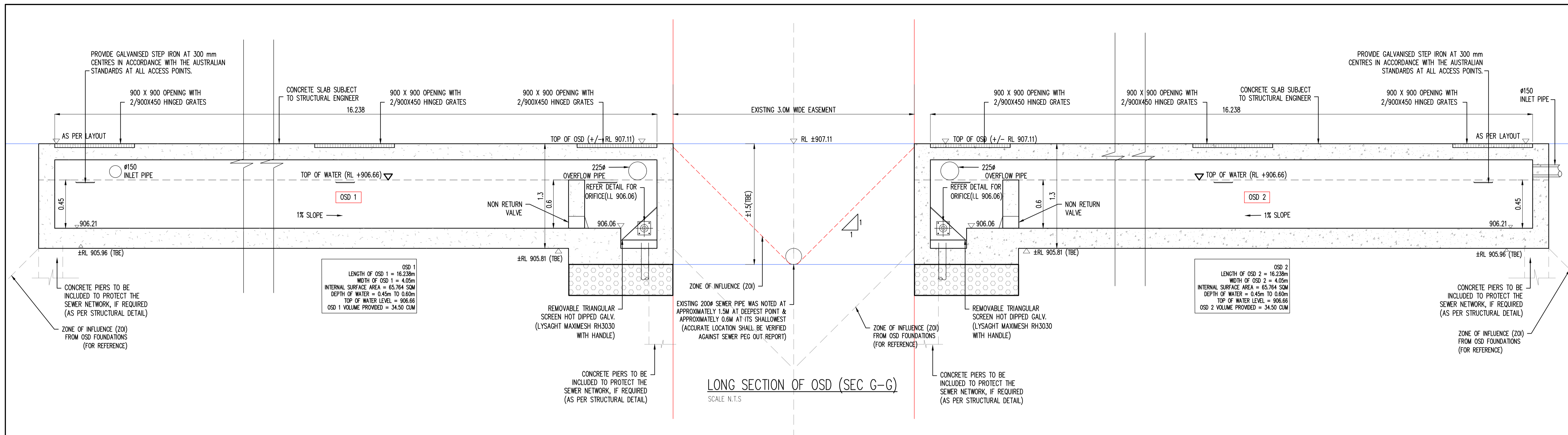

NOTE:
- the screen shall be a minimum of 100mm from the face of the orifice and attached (generally on a sliding mechanism) to the wall;
- the screen should be positioned as close as possible to the vertical, but not less than 45 degrees to the horizontal
- the minimum surface area of the debris screen shall be 50 times the area of the outlet pipe or orifice;

TRASH SCREEN DETAIL
SCALE: 1:20

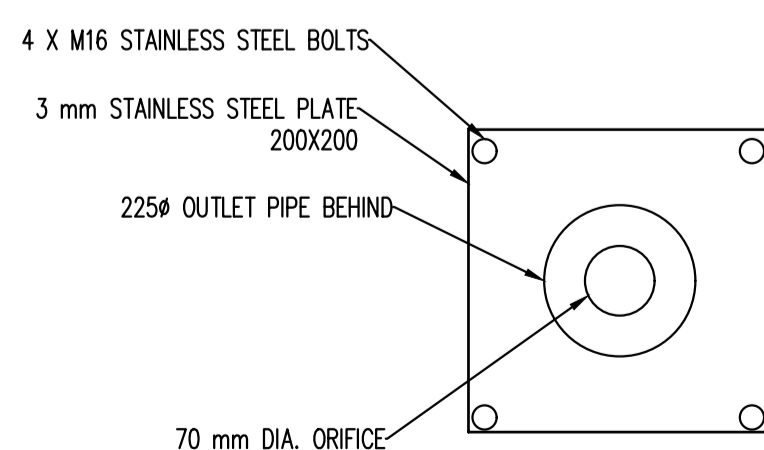

ORIFICE PLATE (OSD 1 & 2)
SCALE: N.T.S.

REV	DESIGNED	DRAWN	APPROVED	DATE
A	ST	SJ	BM	18-12-24

FOR DEVELOPMENT APPLICATION (DA)



Suite 12-15/141 Walker St, North Sydney Tel: (02) 9922 5501 Email: info@neillydavies.com.au ABN 71121623550		COPYRIGHT THIS DOCUMENT IS & SHALL REMAIN THE PROPERTY OF NEILLY DAVIES & PARTNERS CONSULTING ENGINEERS. THE DOCUMENT MAY ONLY BE USED FOR THE PURPOSE FOR WHICH IT WAS COMMISSIONED. IT MUST NOT BE USED, REPRODUCED OR COPIED IN WHOLE OR IN PART WITHOUT PRIOR WRITTEN CONSENT OF THE COMPANY.	
PROJECT STATUS: FOR DEVELOPMENT APPLICATION (DA)			
CLIENT: MAIN STREET CAP PTY LTD			
PROJECT ADDRESS: PROPOSED SERVICE STATION AT 353 MAIN STREET LOTHGOW NSW 2790			
SHEET INFO: OSD DETAILS			
DESIGNED: ST	DRAWN: SJ	CHECKED: B.M.	SIGNED: NOT VALID UNLESS SIGNED AND MARKED AS 'FOR CONSTRUCTION.'
SHEET NO: C03	SCALE: AS SHOWN	START DATE: 22-12-2023	PLOT DATE: 18-12-2024
SHEET SIZE: A0	DO NOT ATTEMPT TO SCALE FROM THESE DRAWINGS		PROJECT NO: J240025

SPECIFICATIONS

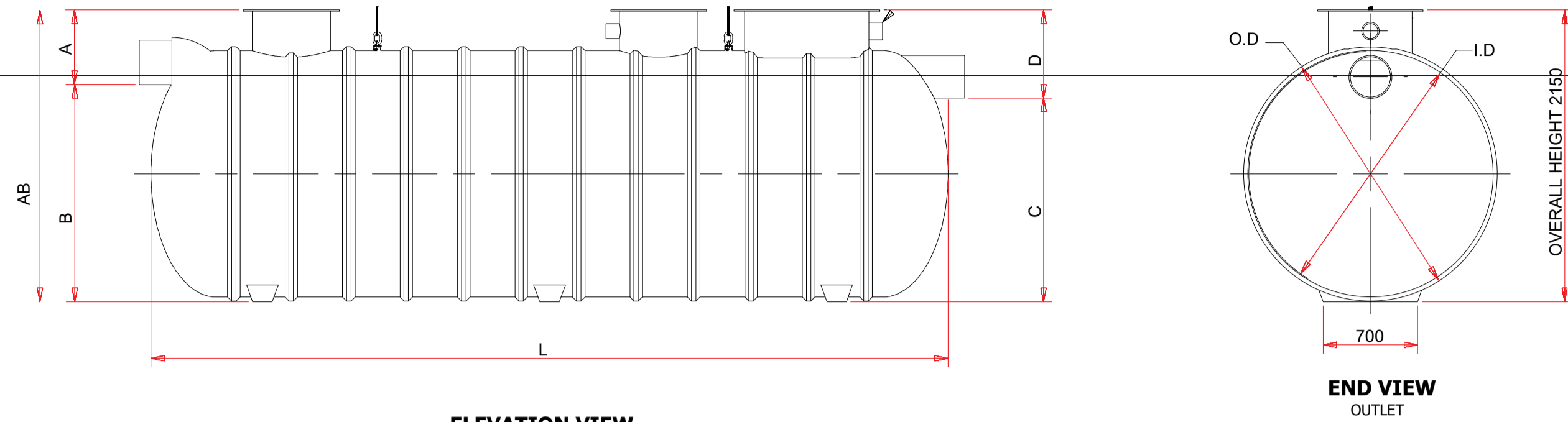

ELEVATION VIEW

END VIEW
OUTLET

100 Series Tanks - 900 mm Internal Diameter																	
P.002.C1.2C	2 LPS	120	400	820	1220	800	420	1700	930	900	100	2	450 ID	-	-	250	800
200 Series Tanks - 1200 mm Internal Diameter																	
P.004.C1.2C	4 LPS	330	460	1100	1560	1080	480	2600	1350	1200	150	2	600 ID	-	-	1,000	2,050
P.006.C1.2C	6 LPS	400	425	1135	1560	1095	465	3035	1350	1200	150	2	600 ID	-	-	1,300	2,550
P.008.C1.2C	8 LPS	450	460	1100	1560	1060	500	3800	1350	1200	150	2	600 ID	-	-	1,900	3,200
P.010.C1.2C	10 LPS	500	450	1110	1560	1060	500	4600	1350	1200	150	2	600 ID	-	-	2,500	3,900
P.013.C1.2C	13 LPS	550	446	1114	1560	1040	520	5800	1350	1200	150	3	600 ID	-	-	3,000	4,800
P.015.L.C1.2C	15 LPS	600	425	1135	1560	1065	495	6500	1350	1200	150	3	600 ID	-	-	3,400	5,400
300 Series Tanks - 1850 mm Internal Diameter																	
P.015.S.C1.2C	15 LPS	650	620	1630	2250	1600	650	3000	1950	1850	300	1	600 ID	1	900 x 600	3,500	5,500
P.020.C1.2C	20 LPS	850	625	1625	2250	1585	665	4000	1950	1850	300	1	600 ID	1	900 x 600	3,900	7,300
P.030.C1.2C	30 LPS	1100	660	1590	2250	1575	675	4860	1950	1850	300	1	600 ID	1	900 x 600	5,500	10,800
P.040.8.C1.2C	40 LPS	1180	550	1600	2150	1500	650	5900	1950	1800	300	1	600 ID	1	900 x 600	8,000	13,400
P.040.C1.2C	40 LPS	1240	650	1600	2250	1550	700	6540	1950	1850	300	2	600 ID	1	900 x 600	9,000	14,400
P.050.L.C1.2C	50 LPS	1400	650	1600	2250	1520	730	8500	1950	1850	300	2	600 ID	1	900 x 600	10,000	18,000
P.060.L.C1.2C	60 LPS	1550	650	1600	2250	1500	750	10,000	1950	1850	300	2	600 ID	1	900 x 600	11,200	21,600
P.070.L.C1.2C	70 LPS	1700	650	1600	2250	1500	750	11,600	1950	1850	300	2	600 ID	1	900 x 600	12,400	25,200
400 Series Tanks - 2480 mm Internal Diameter																	
P.050.S.C1.2C	50 LPS	1400	720	2230	2950	2150	800	4680	2600	2480	375	1	600 ID	1	900 x 600	9,000	18,000
P.060.S.C1.2C	60 LPS	1560	550	2400	2950	2220	730	5500	2600	2480	375	1	600 ID	1	900 x 600	10,700	21,600
P.070.S.C1.2C	70 LPS	1710	750	2200	2950	2150	800	6550	2600	2480	375	3	600 ID	1	900 x 600	12,400	25,200
P.080.C1.2C	080 LPS	2000	600	2350	2950	2250	700	7500	2600	2480	375	3	600 ID	1	900 x 600	14,900	29,600
P.090.C1.2C	090 LPS	2300	715	2235	2950	2150	800	8400	2600	2480	375	3	600 ID	1	1200 x 600	16,200	32,400
P.100.C1.2C	100 LPS	2550	710	2240	2950	2150	800	9000	2600	2480	375	3	600 ID	1	1200 x 600	17,700	35,700
P.110.C1.2C	110 LPS	2650	700	2250	2950	2150	800	9600	2600	2480	375	3	600 ID	1	1200 x 600	18,300	38,200
P.120.C1.2C	120 LPS	2750	570	2400	2970	2300	670	10,230	2600	2480	375	3	600 ID	1	1200 x 600	21,700	43,200
P.150.C1.2C	150 LPS	3360	670	2280	2950	2150	800	13,420	2600	2480	375	4	600 ID	1	1200 x 600	27,700	54,000
P.180.C1.2C	180 LPS	3580	650	2300	2950	2150	800	15,400	2600	2480	375	5	600 ID	1	1200 x 600	32,500	64,800
P.200.C1.2C	200 LPS	4150	555	2395	2950	2230	720	16,500	2600	2480	375	5	600 ID	1	1200 x 600	36,200	72,000

PROPOSED OIL WATER SEPARATION TANK
 ATLAN SPILLCEPTOR – P.040.8.C1.2C
 CAPACITY – 8kL
 L=5.90M; OD=1.95M

A	Invert Level - Depth from top of manhole to base of inlet pipe.
B	Depth from base of inlet pipe to base of tank feet.
A&B	Overall depth of tank, from top of manhole to base of tank feet.
C	Depth from base of outlet pipe to base of tank feet.
D	Invert Level - Depth from top of manhole to base of outlet pipe.
L	Overall length tank.
OD	Overall outside diameter of tank including ribs.
ID	Internal diameter of tank.
S&L	"S" is Short Series Tank & "L" is Long Series Tank.

Atlan Flowrate Calculator

CUSTOMER: Neillydavies Site Type: Station DATE: _____

ARI Selection

When Selecting the site location use the [Elvis - Place Names](#) search to gain the correct Latitude and Longitude.
 Once the latitude and Longitude has been selected, this is to be loaded into the [Rainfall IFD Data](#) website.

Site Details

Location: 353 Main St, Lithgow
 Project Name: 353 Main St, Lithgow
 Latitude: -35.0703
 Longitude: 147.3655
 ARI Selected: 20 Years

Flow Rate Calculations

Formula: Catchment area m2 x rain intensity in millimetres per hour x 0.00028 = treatment flow rate in litres per second (LPS).

Under canopy Area (m2) 225 m2
 rain Driven (m2) 24.75 m2
 Open Catchment Area (m2) 225 m2
 1:20yr MM per Hour of Rain 142 mm/hr
 Flow Rate (LPS) 9.93 LPS

Summary

The flow rate for the 353 Main St, Lithgow project in 153 Main St, Lithgow is 9.93 LPS



neillydavies		Suite 12-15/141 Walker St, North Sydney Tel: (02) 9922 5501 Email: info@neillydavies.com.au		COPYRIGHT THIS DOCUMENT IS & SHALL REMAIN THE PROPERTY OF NEILLY DAVIES & PARTNERS CONSULTING ENGINEERS. THE DOCUMENT MAY ONLY BE USED FOR THE PURPOSE FOR WHICH IT WAS COMMISSIONED. IT MUST NOT BE USED, REPRODUCED OR COPIED IN WHOLE OR IN PART WITHOUT PRIOR WRITTEN CONSENT OF THE COMPANY.	
PROJECT STATUS		FOR DEVELOPMENT APPLICATION (DA)			
CLIENT		MAIN STREET CAP PTY LTD			
PROJECT ADDRESS		PROPOSED SERVICE STATION AT 353 MAIN STREET LOTHGOW NSW 2790			
SHEET INFO		OIL WATER SEPARATOR SPECIFICATIONS			
DESIGNED	ST	DRAFTED	SJ	CHECKED	B.M
SHEET NO	C04	SCALES	AS SHOWN	START DATE	22-12-2023
SHEET SIZE	A0	DO NOT ATTEMPT TO SCALE FROM THESE DRAWINGS		PROJECT NO	J240025

A	ST	SJ	BM	18-12-24	FOR DEVELOPMENT APPLICATION (DA)
REV	DESIGNED	DRAWN	APPROVED	DATE	DESCRIPTION

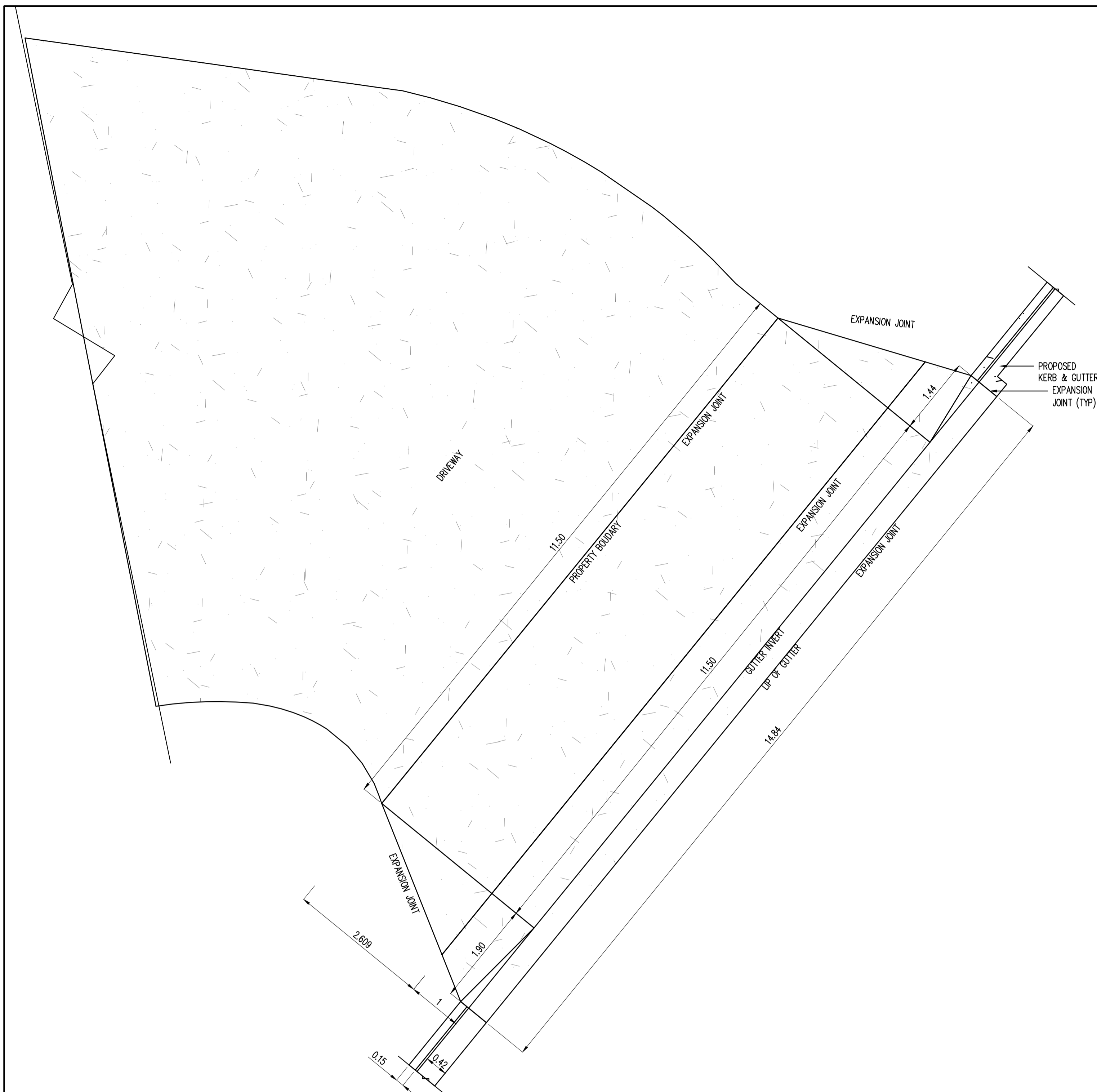

CONCRETE LAYBACK DETAILS AT MAIN STREET

SCALE 1:50
NOTE: TO BE APPROVED BY LITHGOW CITY COUNCIL

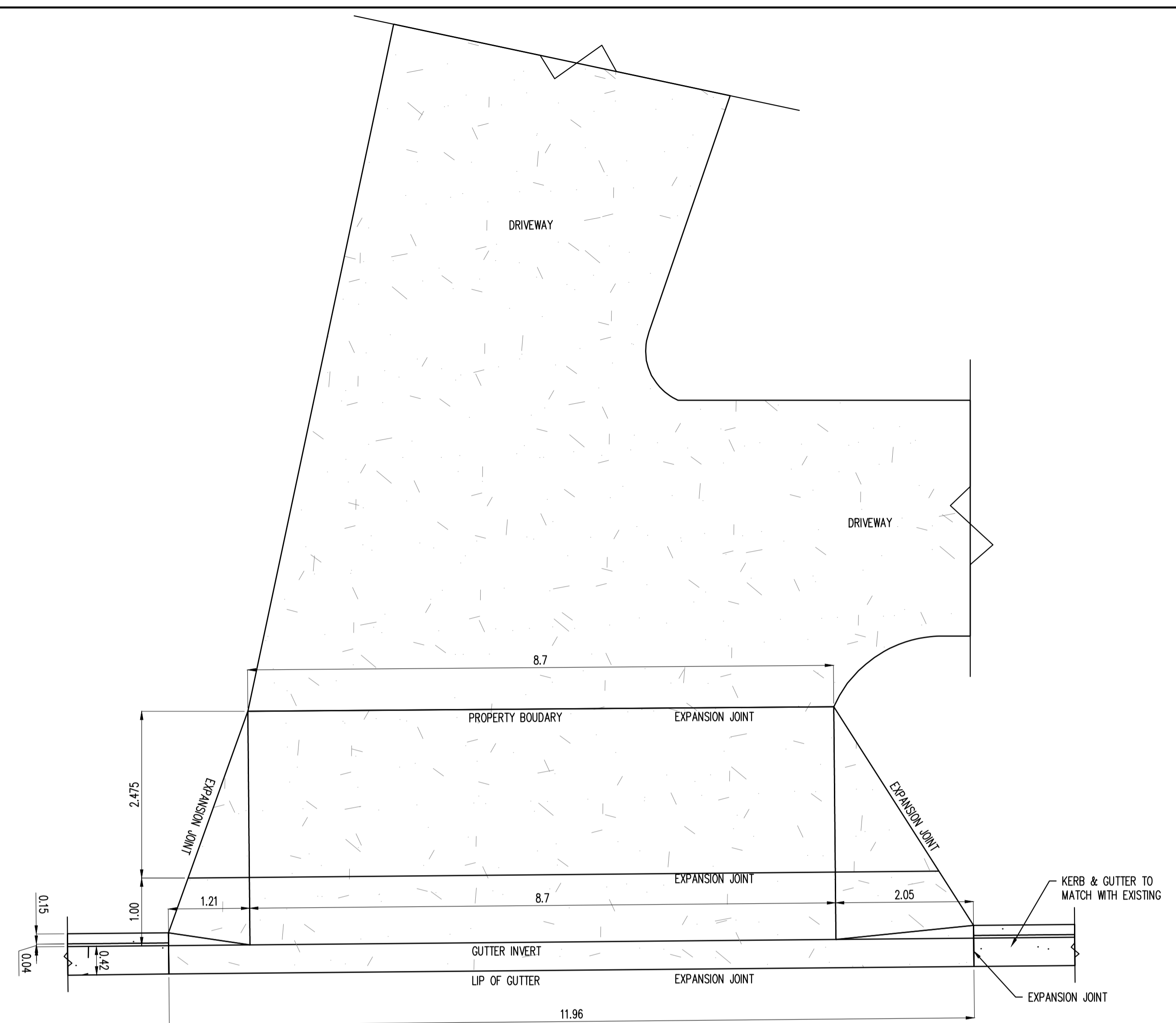

CONCRETE LAYBACK DETAILS FOR ENFIELD AVENUE

SCALE 1:50
NOTE: TO BE APPROVED BY LITHGOW CITY COUNCIL

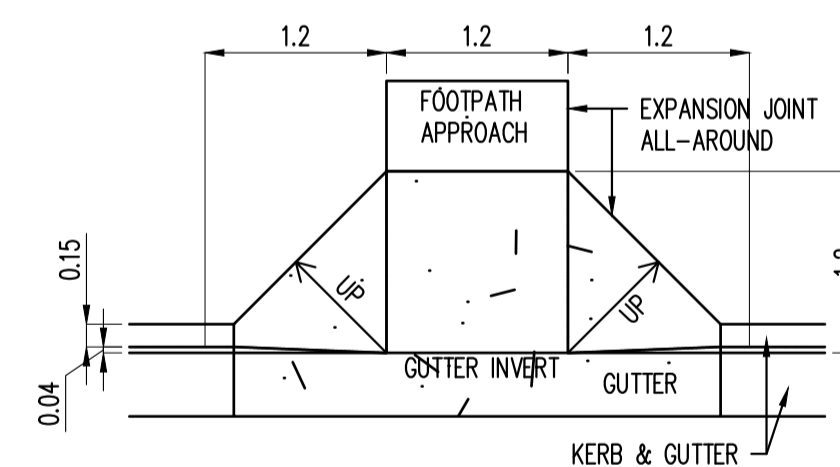

PERAMBULATOR CROSSING

SCALE 1:50
NOTE: TO BE APPROVED BY LITHGOW CITY COUNCIL

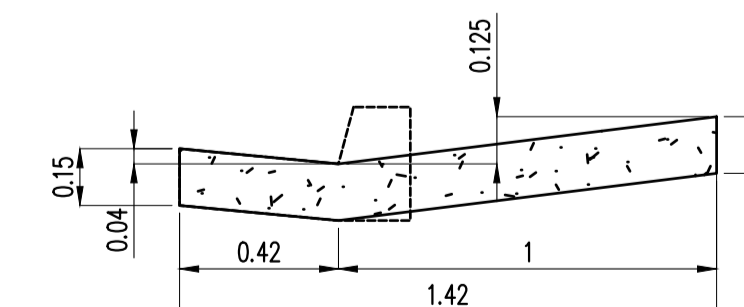

TYP SECTION OF LAYBACK

SCALE 1:20
NOTE: LAYBACK TO BE APPROVED BY LITHGOW CITY COUNCIL



neillyd Davies Suite 12-15/141 Walker St, North Sydney consulting engineers Tel: (02) 9922 5501 Email: info@neillyd Davies.com.au ABN 71121623550		COPYRIGHT THIS DOCUMENT IS & SHALL REMAIN THE PROPERTY OF NEILLY DAVIES & PARTNERS CONSULTING ENGINEERS. THE DOCUMENT MAY ONLY BE USED FOR THE PURPOSE FOR WHICH IT WAS COMMISSIONED. IT MUST NOT BE USED, REPRODUCED OR COPIED IN WHOLE OR IN PART WITHOUT PRIOR WRITTEN CONSENT OF THE COMPANY.	
PROJECT STATUS		FOR DEVELOPMENT APPLICATION (DA)	
CLIENT		MAIN STREET CAP PTY LTD	
PROJECT ADDRESS		PROPOSED SERVICE STATION AT 353 MAIN STREET LOTHGOW NSW 2790	
SHEET INFO		CONCRETE LAYBACK PLAN & DETAILS	
DESIGNED	DRAWN	CHECKED	SIGNED
ST	SJ	B.M	NOT VALID UNLESS SIGNED AND MARKED AS 'FOR CONSTRUCTION'
SHEET NO	SCALES	START DATE	PILOT DATE
C05	AS SHOWN	22-12-2023	18-12-2024
SHEET SIZE	DO NOT ATTEMPT TO SCALE FROM THESE DRAWINGS		PROJECT NO
A0			J240025

A	ST	SJ	BM	18-12-24	FOR DEVELOPMENT APPLICATION (DA)
REV	DESIGNED	DRAWN	APPROVED	DATE	DESCRIPTION

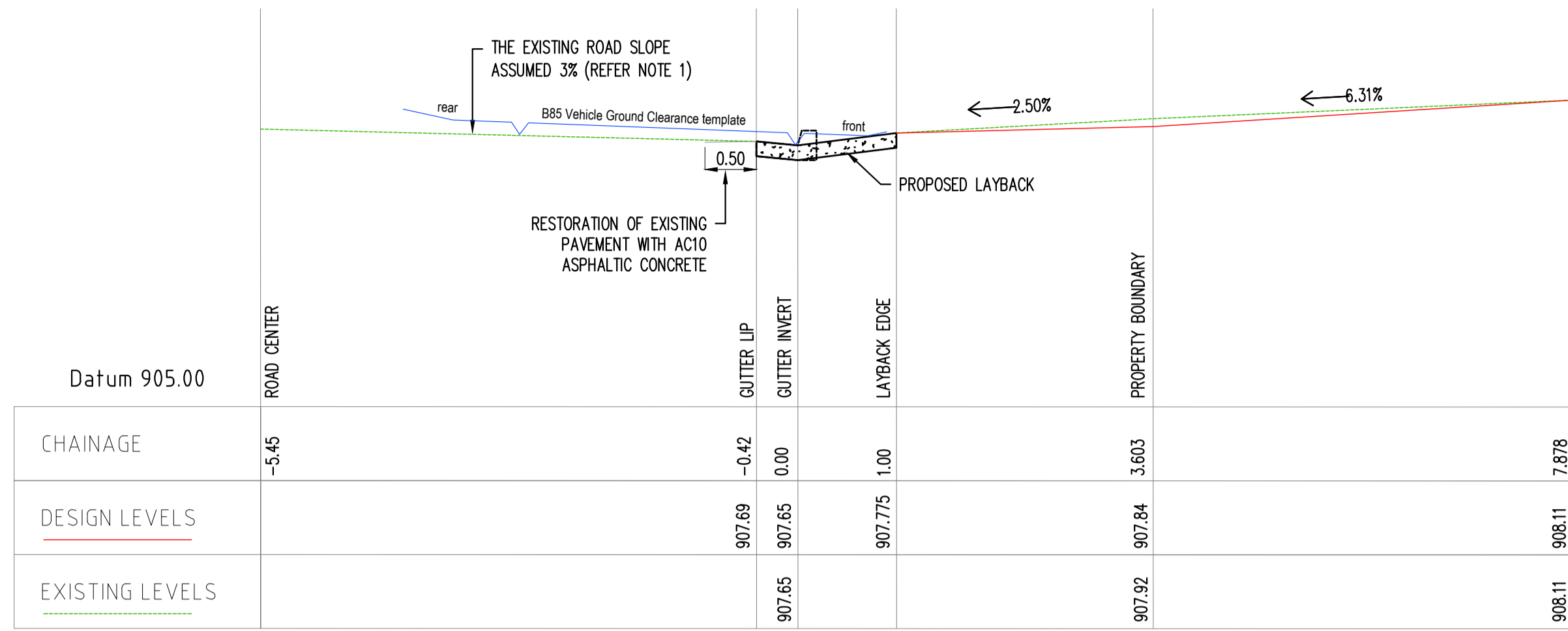

VEHICULAR CROSSING LONG SECTION A – FOR MAIN STREET
SCALE 1:50

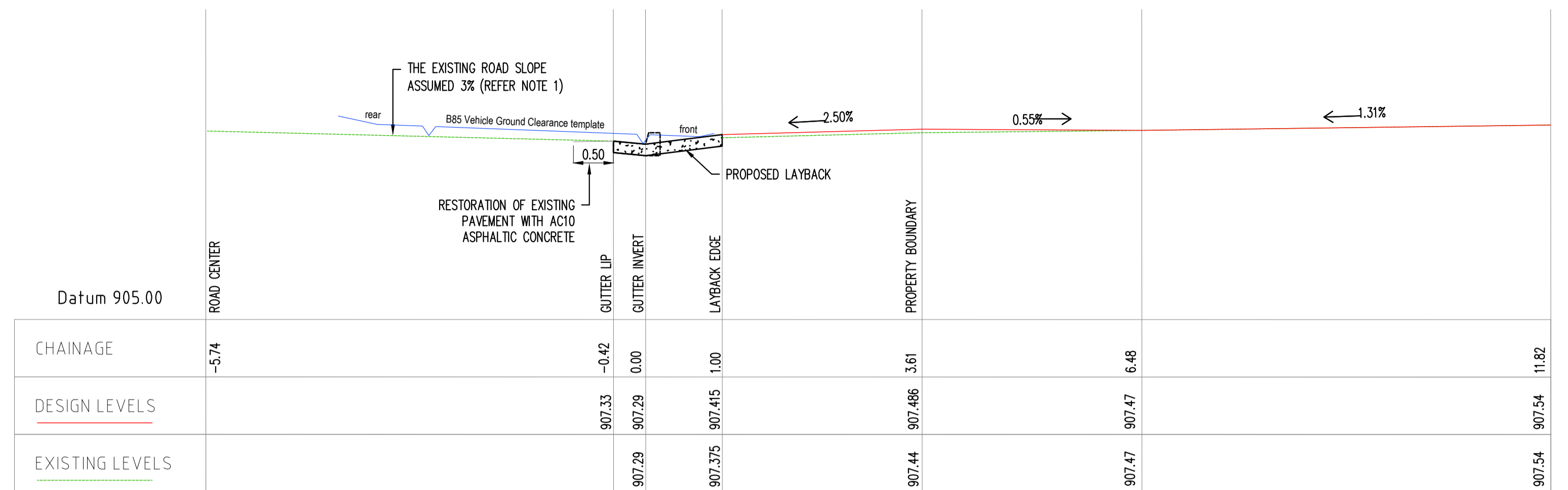

VEHICULAR CROSSING LONG SECTION B – FOR MAIN STREET
SCALE 1:50

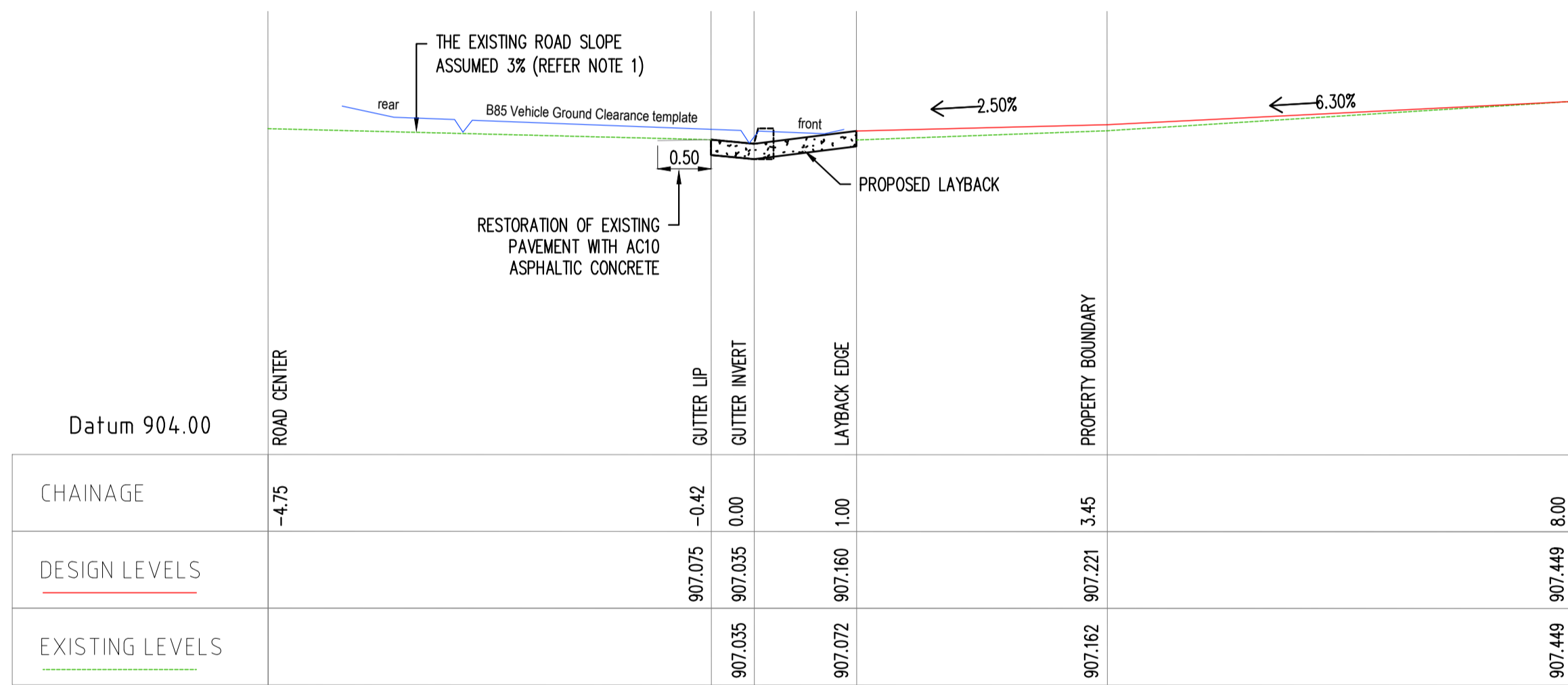

VEHICULAR CROSSING LONG SECTION C – FOR ENFIELD AVENUE
SCALE 1:50

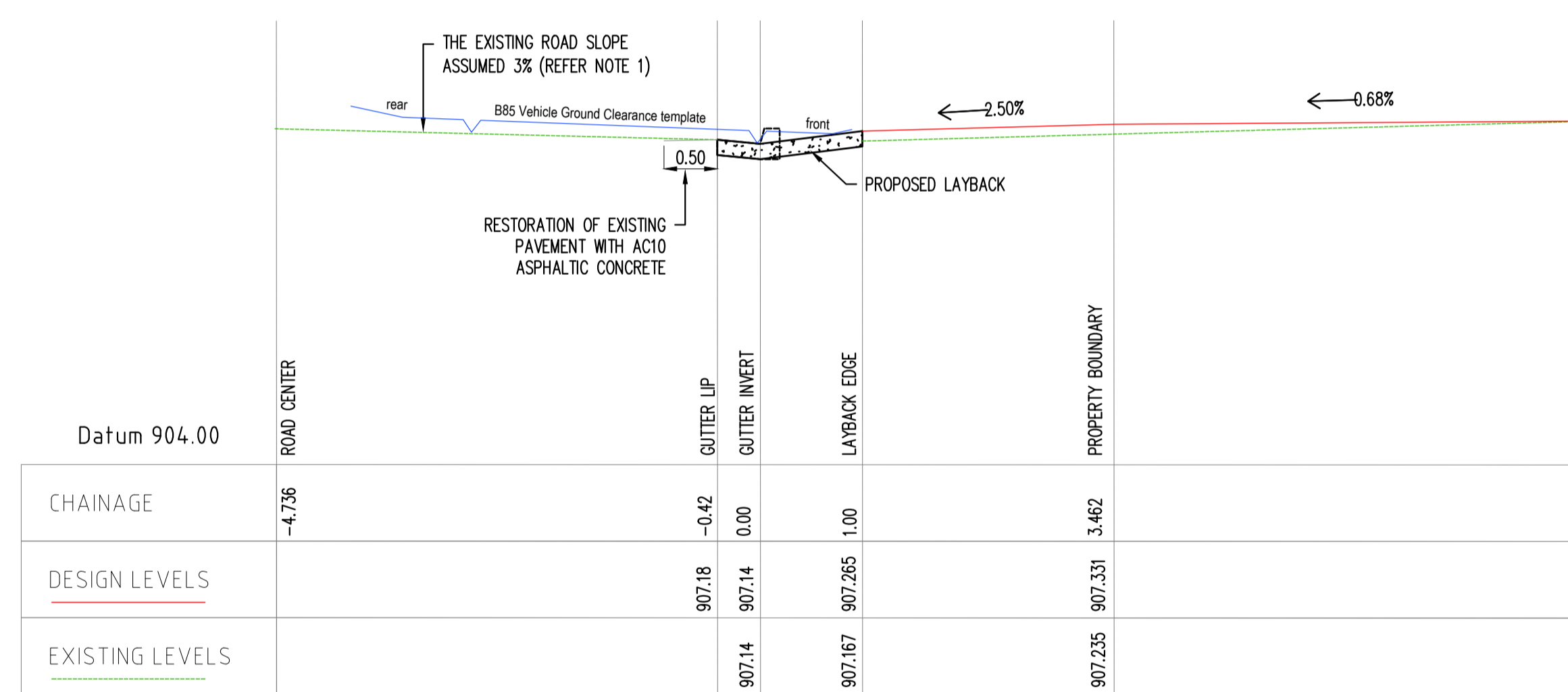

VEHICULAR CROSSING LONG SECTION D – FOR ENFIELD AVENUE
SCALE 1:50



neillydavies Suite 12-15/141 Walker St, North Sydney
Tel: (02) 9922 5501
Email: info@neillydavies.com.au

ABN 71121623550

PROJECT STATUS: FOR DEVELOPMENT APPLICATION (DA)

CLIENT: MAIN STREET CAP PTY LTD

PROJECT ADDRESS: PROPOSED SERVICE STATION AT 353 MAIN STREET LOTHGOW NSW 2790

SHEET INFO: VEHICULAR CROSSING LONG SECTIONS

DESIGNED: ST	DRAWN: SJ	CHECKED: B.M	SIGNED: NOT VALID UNLESS SIGNED AND MARKED AS 'FOR CONSTRUCTION.'
SHEET NO: C06	SCALES: AS SHOWN	START DATE: 22-12-2023	PLOT DATE: 18-12-2024
SHEET SIZE: A0	DO NOT ATTEMPT TO SCALE FROM THESE DRAWINGS		PROJECT NO: J240025

A	ST	SJ	BM	18-12-24	
REV	DESIGNED	DRAWN	APPROVED	DATE	DESCRIPTION

FOR DEVELOPMENT APPLICATION (DA)

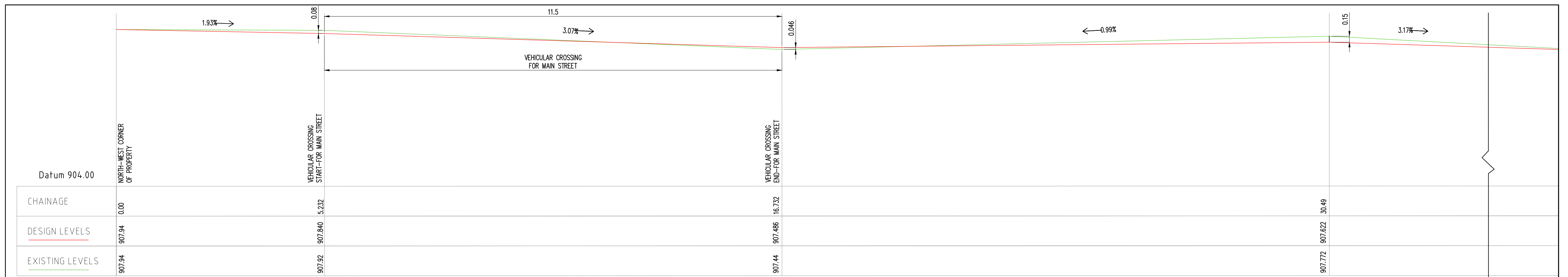

FOOTPATH LONG SECTION E – FOR MAIN STREET ALONG PROPERTY BOUNDARY (CONTINUED -----)

SCALE 1:50

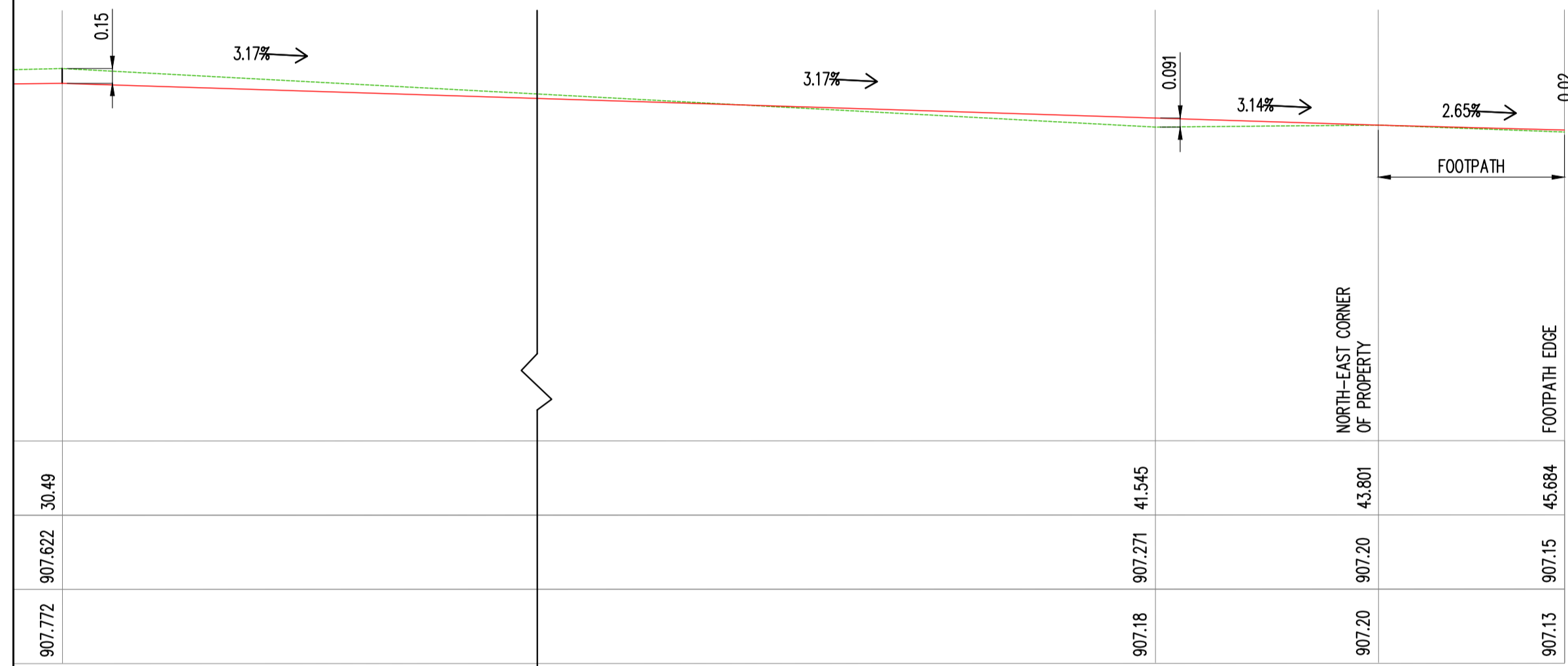

FOOTPATH LONG SECTION E – FOR MAIN STREET ALONG PROPERTY BOUNDARY

SCALE 1:50

		Suite 12-15/141 Walker St, North Sydney Tel: (02) 9922 5501 Email: info@neillyd Davies.com.au		<small>COPYRIGHT</small> THIS DOCUMENT IS & SHALL REMAIN THE PROPERTY OF NEILLY DAVIES & PARTNERS CONSULTING ENGINEERS. THE DOCUMENT MAY ONLY BE USED FOR THE PURPOSE FOR WHICH IT WAS COMMISSIONED. IT MUST NOT BE USED, REPRODUCED OR COPIED IN WHOLE OR IN PART WITHOUT PRIOR WRITTEN CONSENT OF THE COMPANY.		
PROJECT STATUS: FOR DEVELOPMENT APPLICATION (DA)						
CLIENT: MAIN STREET CAP PTY LTD						
PROJECT ADDRESS: PROPOSED SERVICE STATION AT 353 MAIN STREET LOTHGOW NSW 2790						
SHEET INFO: FOOTPATH LONG SECTION						
DESIGNED	ST	DRAFTED	SJ	CHECKED	B.M	
SHEET NO	C07	SCALES	AS SHOWN	START DATE	22-12-2023	
SHEET SIZE	A0	DO NOT ATTEMPT TO SCALE FROM THESE DRAWINGS			PROJECT NO	J240025



REV	ST	SJ	BM	18-12-24	FOR DEVELOPMENT APPLICATION (DA)
-----	----	----	----	----------	----------------------------------

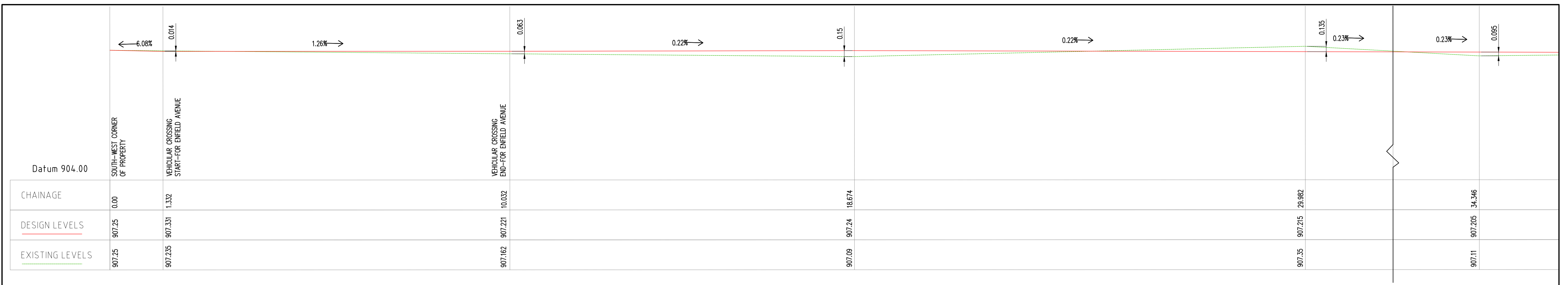

FOOTPATH LONG SECTION F – FOR ENFIELD AVENUE ALONG PROPERTY BOUNDARY (CONTINUED ----)
SCALE 1:50

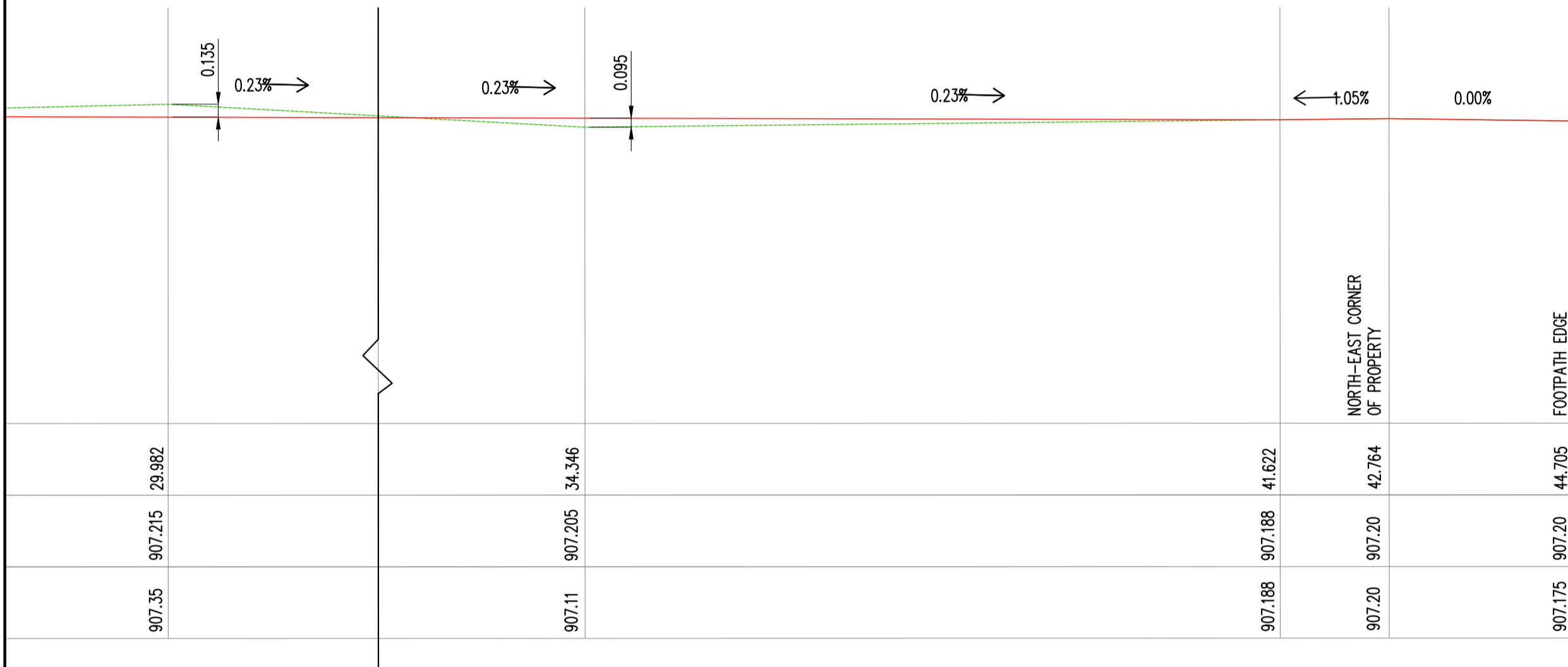

FOOTPATH LONG SECTION F – FOR ENFIELD AVENUE ALONG PROPERTY BOUNDARY
SCALE 1:50

Suite 12-15/141 Walker St, North Sydney Tel: (02) 9922 5501 Email: info@neillydavies.com.au ABN 71121623550		<small>COPYRIGHT</small> THIS DOCUMENT IS & SHALL REMAIN THE PROPERTY OF NEILLY DAVIES & PARTNERS CONSULTING ENGINEERS. THE DOCUMENT MAY ONLY BE USED FOR THE PURPOSE FOR WHICH IT WAS COMMISSIONED. IT MUST NOT BE USED, REPRODUCED OR COPIED IN WHOLE OR IN PART WITHOUT PRIOR WRITTEN CONSENT OF THE COMPANY.	
PROJECT STATUS: FOR DEVELOPMENT APPLICATION (DA)			
CLIENT: MAIN STREET CAP PTY LTD			
PROJECT ADDRESS: PROPOSED SERVICE STATION AT 353 MAIN STREET LOTHGOW NSW 2790			
SHEET INFO: FOOTPATH LONG SECTIONS			
DESIGNED: ST	DRAFTED: SJ	CHECKED: B.M	SIGNED: NOT VALID UNLESS SIGNED AND MARKED AS 'FOR CONSTRUCTION'.
SHEET NO: C08	SCALES: AS SHOWN	START DATE: 22-12-2023	PLOT DATE: 18-12-2024
SHEET SIZE: A0	[DO NOT ATTEMPT TO SCALE FROM THESE DRAWINGS]		PROJECT NO: J240025



A	ST	SJ	BM	18-12-24	FOR DEVELOPMENT APPLICATION (DA)
REV	DESIGNED	DRAFTED	APPROVED	DATE	DESCRIPTION

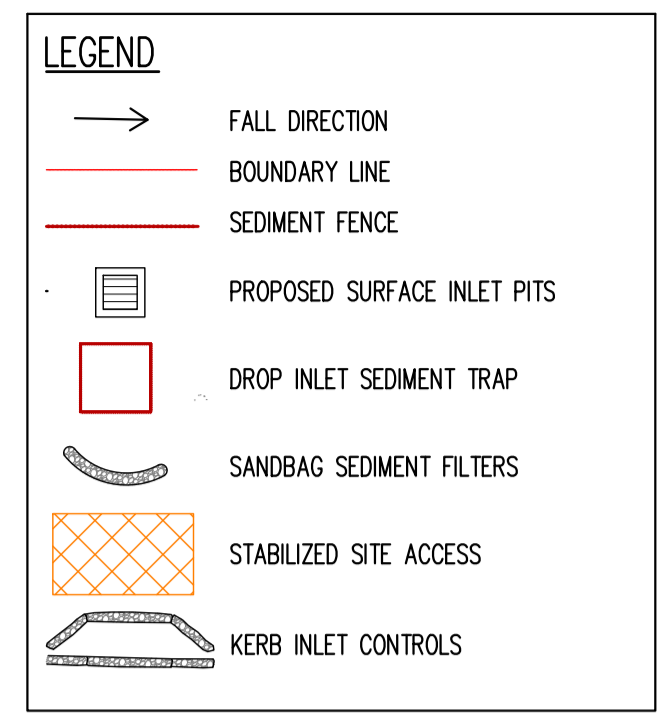
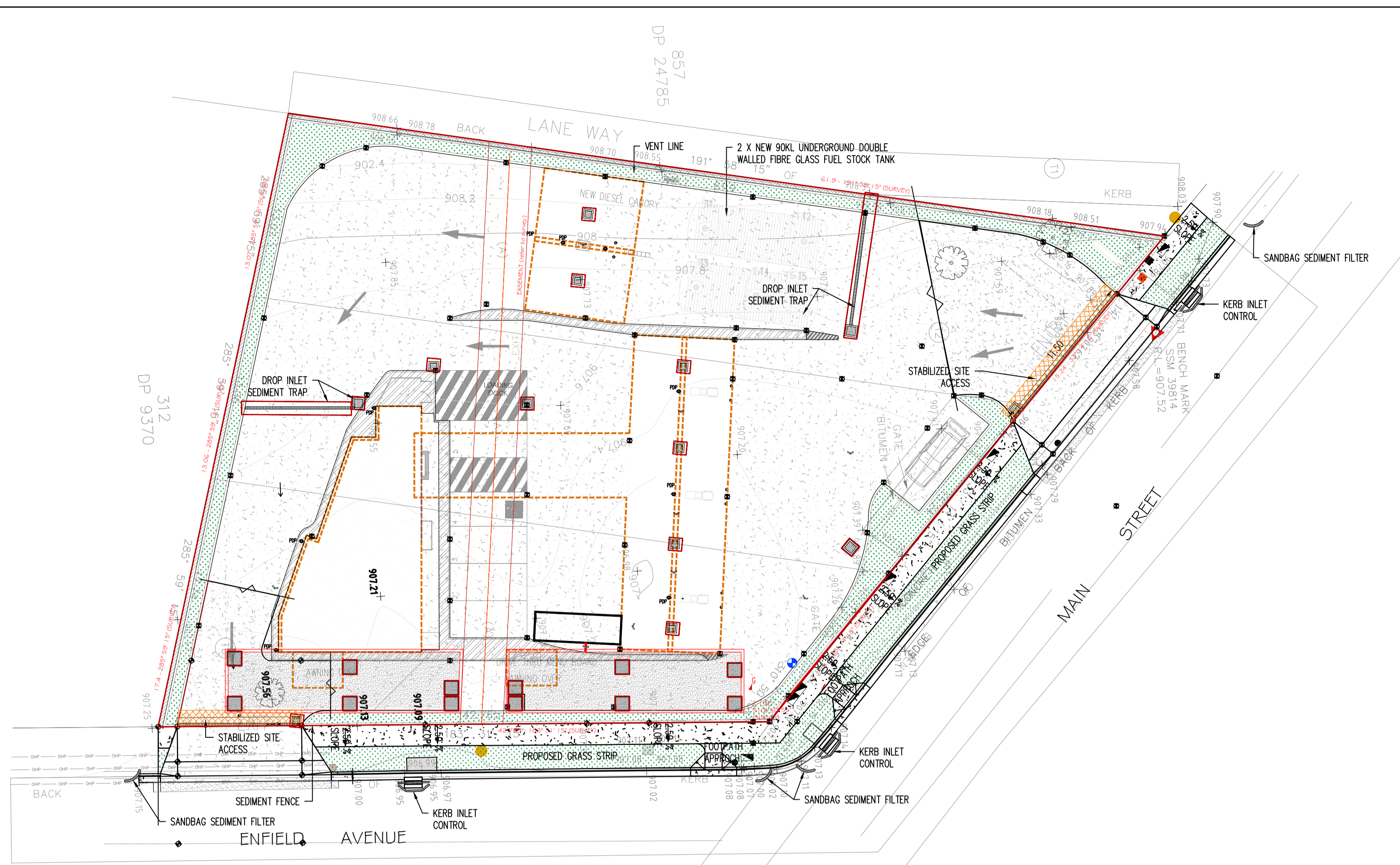

EROSION & SEDIMENT CONTROL NOTES

1. THIS PLAN SHALL BE READ IN CONJUNCTION WITH THE ARCHITECTURAL AND ENGINEERING PLANS AND ANY OTHER PLANS OR WRITTEN INSTRUCTIONS THAT MAY BE ISSUED.
2. THE CONTRACTOR SHALL ENSURE THAT ALL SOIL AND WATER MANAGEMENT WORKS ARE LOCATED AS SHOWN ON THIS DRAWINGS.
3. PROTECT ALL NEW PITS FROM SEDIMENT INFILTRATION PROGRESSIVELY, AS THEY ARE CONSTRUCTED.
4. ALL DOWNSTREAM STORM WATER PITS ARE TO BE PROTECTED FROM SEDIMENT INFILTRATION DURING CONSTRUCTION.
5. ALL SUB-CONTRACTORS ON SITE SHALL BE MADE AWARE OF OTHER RESPONSIBILITIES IN MINIMISING THE POTENTIAL FOR SOIL EROSION AND POLLUTION TO WATER COURSES AND WHERE PRACTICAL, THE SOIL EROSION HAZARD ON THE SITE SHALL BE KEPT AS LOW AS POSSIBLE. TO ACHIEVE, WORKS SHOULD BE CARRIED OUT AS FOLLOWS:
 - INSTALL ANY NECESSARY SECURITY/BOUNDARY FENCES FOR THE SITE.
 - CONSTRUCT "SILT" FENCING AND DETAILED ALONG BOTH DOWNSLOPE BOUNDARIES.
6. DURING WINDY WEATHER LARGE UNPROTECTED AREAS SHALL BE KEPT MOIST BY SPRINKLING WITH WATER TO KEEP DUST UNDER CONTROL.
7. FINAL SITE LANDSCAPING SHALL BE UNDERTAKEN AS SOON AS POSSIBLE AND WITHIN TWENTY WORKING DAYS FROM COMPLETION OF CONSTRUCTION ACTIVITIES.
8. SAND USED IN THE CONCRETE CURING PROCESS SHALL BE REMOVED ASAP, AND WITHIN 10 WORKING DAYS FROM PLACEMENT.
9. WATER SHALL BE PREVENTED FROM ENTERING THE PERMANENT DRAINAGE SYSTEM, UNLESS IT IS RELATIVELY SEDIMENT-FREE.
10. TEMPORARY SOIL AND WATER MANAGEMENT STRUCTURES SHALL BE REMOVED ONLY AFTER THE LANDS THEY ARE PROTECTING ARE REHABILITATED.
11. THE CONTRACTOR SHALL PROVIDE ACCEPTABLE RECEPTORS FOR CONCRETE AND MORTAR SLURRIES, PAINTS, ACID WASHINGS, LIGHT-WEIGHT WASTE MATERIALS AND LITTER.
12. RECEPTORS FOR CONCRETE AND MORTARS SLURRIES, PAINTS, ACID WASHINGS LIGHT-WEIGHT WASTE MATERIALS AND LITTER ARE TO BE EMPTIED AS NECESSARY. DISPOSAL OF WASTE SHALL BE IN A MANNER APPROVED BY THE SITE SUPERINTENDENT.
13. EVERY WEEK FOR THE DURATION OF WORKS THE CONTRACTOR SHOULD INSPECT THE SITE FOR THE FOLLOWING ITEMS:
 - ENSURE DRAINS OPERATE EFFECTIVELY, AND INITIATE REPAIR OR MAINTENANCE AS REQUIRED.
 - REMOVE SPILLED SAND (OR OTHER MATERIALS) FROM HAZARD AREAS, INCLUDING LANDS CLOSER THAN 2 METER FROM AREAS OF CONCENTRATED OR HIGH VELOCITY FLOWS SUCH AS WATER COURSES, OVERLAND FLOW PATHS, GUTTERS, PAVED AREAS, DRIVEWAY AND ROADS.
 - CONSTRUCT ADDITIONAL EROSION AND/OR SEDIMENT WORK IS NECESSARY TO ENSURE THE DESIRED PROTECTION IS GIVEN TO DOWNSLOPE LANDS AND WATERWAYS, I.E. MAKE ONGOING CHANGE TO THE PLAN.
14. MAINTAIN EROSION AND SEDIMENT CONTROL MEASURES IN A FUNCTION CONDITION UNTIL ALL EARTHWORK ACTIVITIES ARE COMPLETED AND THE SITE REHABILITATED.
15. REMOVE TEMPORARY SOIL CONSERVATION STRUCTURES AS A LAST ACTIVITY IN THE REHABILITATION PROGRAMME.
16. THE CONTRACTOR SHALL KEEP A LOG BOOK, MAKING ENTRIES AT LEAST WEEKLY, AND AFTER RAINFALL AND/OR SITE CLOSURE. RECORD:
 - THE VOLUME OF ANY RAINFALL EVENTS
 - THE CONDITION OF ANY SOIL AND WATER MANAGEMENT WORKS
 - REMEDIAL WORKS

EROSION & SEDIMENT CONTROL PLAN
SCALE 1:200

Suite 12-15/141 Walker St, North Sydney Tel: (02) 9922 5501 Email: info@neillyd Davies.com.au ABN 71121623550		THIS DOCUMENT IS & SHALL REMAIN THE PROPERTY OF NEILLY DAVIES & PARTNERS CONSULTING ENGINEERS. THE DOCUMENT MAY ONLY BE USED FOR THE PURPOSE FOR WHICH IT WAS COMMISSIONED. IT MUST NOT BE USED, REPRODUCED OR COPIED IN WHOLE OR IN PART WITHOUT PRIOR WRITTEN CONSENT OF THE COMPANY.	
PROJECT STATUS		FOR DEVELOPMENT APPLICATION (DA)	
CLIENT		MAIN STREET CAP PTY LTD	
PROJECT ADDRESS		PROPOSED SERVICE STATION AT 353 MAIN STREET LOTHGOW NSW 2790	
SHEET INFO		EROSION & SEDIMENT CONTROL PLAN	
DESIGNED	DRAFTED	CHECKED	SIGNED
ST	SJ	B.M	NOT VALID UNLESS SIGNED AND MARKED AS 'FOR CONSTRUCTION'.
SHEET NO	SCALES	START DATE	PLAT DATE
C09	AS SHOWN	22-12-2023	18-12-2024
SHEET SIZE	DO NOT ATTEMPT TO SCALE FROM THESE DRAWINGS		PROJECT NO
A0			J240025



A	ST	SJ	BM	18-12-24	FOR DEVELOPMENT APPLICATION (DA)
REV	DESIGNED	DRAWN	APPROVED	DATE	DESCRIPTION