

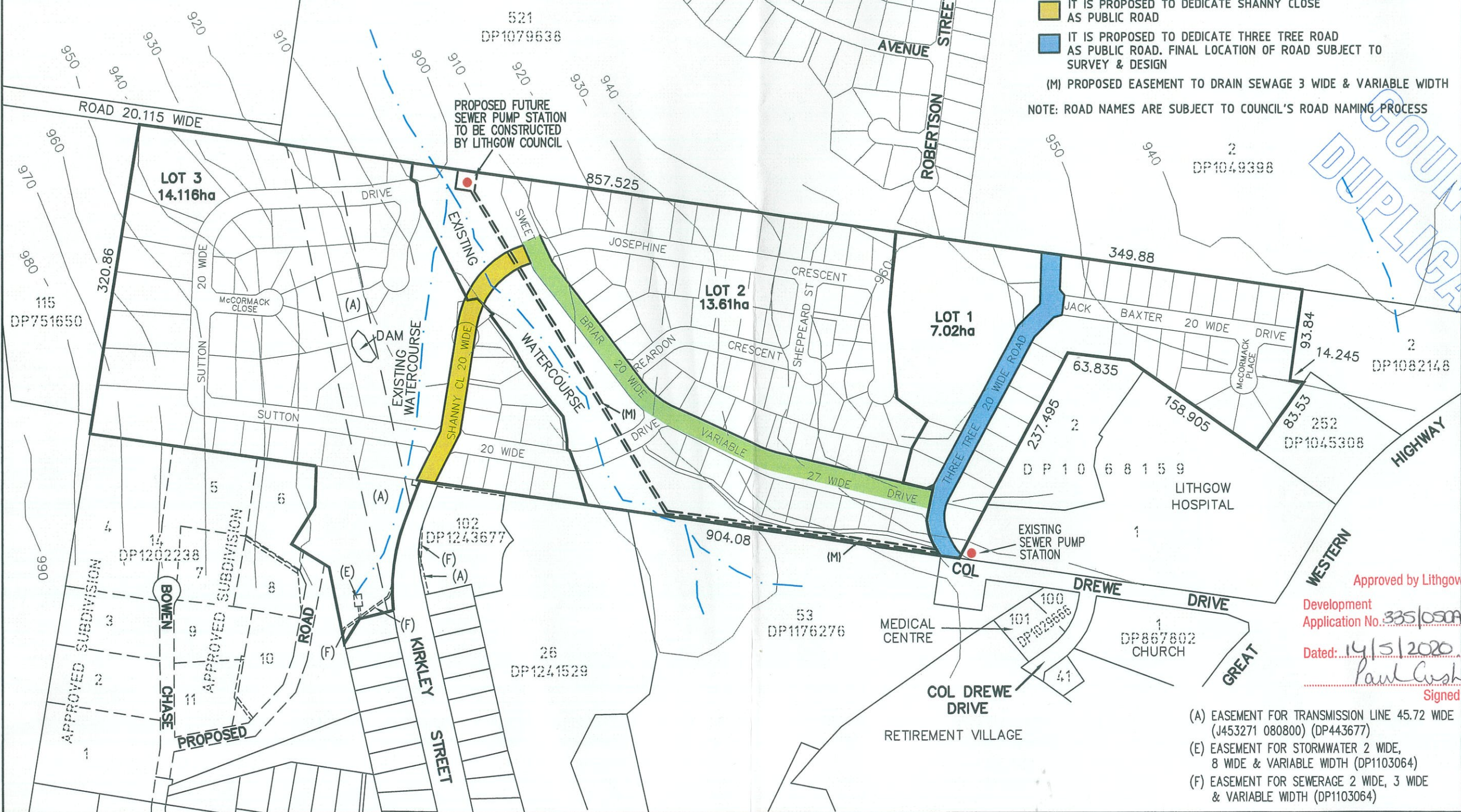

- KEY**
- PROPOSED RIGHT OF WAY 20 WIDE BURDENS LOT 2 TO PROVIDE LEGAL ACCESS BETWEEN SHANNY CLOSE, THREE TREE ROAD & COL DREWE DRIVE TO BE RELEASED WHEN BRIAR DRIVE IS CREATED AS PUBLIC ROAD
 - IT IS PROPOSED TO DEDICATE SHANNY CLOSE AS PUBLIC ROAD
 - IT IS PROPOSED TO DEDICATE THREE TREE ROAD AS PUBLIC ROAD. FINAL LOCATION OF ROAD SUBJECT TO SURVEY & DESIGN
 - (M) PROPOSED EASEMENT TO DRAIN SEWAGE 3 WIDE & VARIABLE WIDTH
- NOTE: ROAD NAMES ARE SUBJECT TO COUNCIL'S ROAD NAMING PROCESS



COUNCIL'S
DUPLICATE

Approved by Lithgow City Council
 Development Application No. 335/05/ACC (40025/19)
 Dated: 14/5/2020
 Paul Crushel
 Signed

- (A) EASEMENT FOR TRANSMISSION LINE 45.72 WIDE (J453271 080800) (DP443677)
- (E) EASEMENT FOR STORMWATER 2 WIDE, 8 WIDE & VARIABLE WIDTH (DP1103064)
- (F) EASEMENT FOR SEWERAGE 2 WIDE, 3 WIDE & VARIABLE WIDTH (DP1103064)

IMPORTANT NOTES

- THIS PLAN HAS BEEN PREPARED FOR DEVELOPMENT APPLICATION PURPOSES ONLY
- ALL DIMENSIONS AND AREAS SHOWN ARE SUBJECT TO SURVEY
- DO NOT RELY ON THIS PLAN FOR THE LOCATION & TYPE OF EASEMENTS THAT MAY AFFECT THE LAND. THESE SHOULD BE ASCERTAINED BY SURVEY SEARCH AND/OR FIELD SURVEY.
- FUTURE EASEMENTS MAY BE REQUIRED FOR SERVICING OR OTHER REASONS, & AS SUCH ARE SUBJECT TO FINAL SURVEY AND/OR ENGINEERING DESIGN.
- THE LOCATION OF BUILDINGS IS INDICATIVE ONLY AND TRUE POSITION IN RELATION TO BOUNDARIES IS SUBJECT TO SURVEY

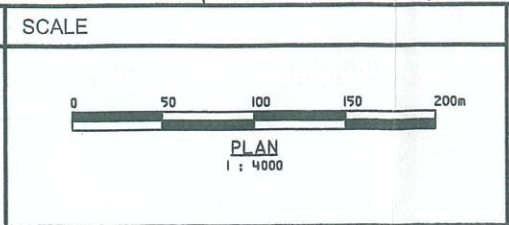

PROPOSED SUBDIVISION OF EN GLOBO LOTS 3 AND 4
 IN DA 335/05 AND LOT 101 DP 1243677 - LITHGOW

FIGURE 4 - PROPOSED 3 LOT ENGLOBO SUBDIVISION

DATE: 9.04.2020 REFERENCE: 13031DA SHEET: 4 OF 4

PETER BASHA

PLANNING & DEVELOPMENT
 Phone : 6361 2955 Fax: 6360 4700
 P.O. BOX 1827 ORANGE, NSW 2800