

# Contract for the sale and purchase of land 2019 edition

TERM	MEANING OF TERM	NSW DAN:
Vendor's agent	First National Real Estate 3 Wolgan Street, Portland NSW 2847	Phone: 02 6355 5125 Fax: Ref:
Co-agent Vendor	LITHGOW CITY COUNCIL ABN 59 986 092 492 180 Mort Street, Lithgow NSW 2790 Pursuant to the power of section 713 of Local Government Act 1993	
Vendor's solicitor	MCANENY LAWYERS SUTHERLAND PO BOX 373 SUTHERLAND NSW 1499	Phone: 02 9545 3115 Fax: Ref: 104348
Date for completion	42nd day after the contract date (clause 15)	
Land (address, plan details and title reference)	Palmers Oakey Road PALMERS OAKY NSW 2795 27/755795	
Improvements	<input checked="" type="checkbox"/> VACANT POSSESSION <input type="checkbox"/> subject to existing tenancies <input type="checkbox"/> HOUSE <input type="checkbox"/> garage <input type="checkbox"/> carport <input type="checkbox"/> home unit <input type="checkbox"/> carspace <input type="checkbox"/> storage space <input type="checkbox"/> none <input type="checkbox"/> other:	
Attached copies	documents in the List of Documents as marked or numbered: other documents:	

**A real estate agent is permitted by legislation to fill up the items in this box in a sale of residential property.**

Inclusions	<input type="checkbox"/> blinds <input type="checkbox"/> dishwasher <input type="checkbox"/> light fittings <input type="checkbox"/> stove <input type="checkbox"/> built-in wardrobes <input type="checkbox"/> fixed floor coverings <input type="checkbox"/> range hood <input type="checkbox"/> pool equipment <input type="checkbox"/> clothes line <input type="checkbox"/> insect screens <input type="checkbox"/> solar panels <input type="checkbox"/> TV antenna <input type="checkbox"/> curtains <input type="checkbox"/> other:
Exclusions	
Purchaser	
Purchaser's solicitor	
Price	\$
Deposit	\$ (10% of the price, unless otherwise stated)
Balance	\$
Contract date	(if not stated, the date this contract was made)

Buyer's agent	Phone: Fax: Ref:
---------------	------------------------

Vendor	<div style="border: 1px dashed black; padding: 5px; display: inline-block;"> <b>GST AMOUNT</b> (optional)                      The price includes                      GST of: \$                 </div>	Witness
Purchaser	<input type="checkbox"/> JOINT TENANTS <input type="checkbox"/> tenants in common <input type="checkbox"/> in unequal shares	Witness

## Choices

Vendor agrees to accept a **deposit-bond** (clause 3) ☒ NO ☐ yes

**Nominated Electronic Lodgment Network (ELN)** (clause 30)

**Electronic transaction** (clause 30)

☐ no ☒ YES

(if no, vendor must provide further details, such as the proposed applicable waiver, in the space below, or serve within 14 days of the contract date):

**Tax information (the parties promise this is correct as far as each party is aware)**

**Land tax** is adjustable

☐ NO ☐ yes

**GST:** Taxable supply

☐ NO ☐ yes in full ☐ yes to an extent

Margin scheme will be used in making the taxable supply

☐ NO ☐ yes

This sale is not a taxable supply because (one or more of the following may apply) the sale is:

- ☐ not made in the course or furtherance of an enterprise that the vendor carries on (section 9-5(b))
- ☐ by a vendor who is neither registered nor required to be registered for GST (section 9-5(d))
- ☐ GST-free because the sale is the supply of a going concern under section 38-325
- ☐ GST-free because the sale is subdivided farm land or farm land supplied for farming under Subdivision 38-O
- ☐ input taxed because the sale is of eligible residential premises (sections 40-65, 40-75(2) and 195-1)

Purchaser must make an **GSTRW payment**  
(GST residential withholding payment)

☐ NO ☐ yes (if yes, vendor must provide further details)

If the further details below are not fully completed at the contract date, the vendor must provide all these details in a separate notice within 14 days of the contract date.

**GSTRW payment (GST residential withholding payment) – further details**

Frequently the supplier will be the vendor. However, sometimes further information will be required as to which entity is liable for GST, for example, if the supplier is a partnership, a trust, part of a GST group or a participant in a GST joint venture.

Supplier's name:

Supplier's ABN:

Supplier's GST branch number (if applicable):

Supplier's business address:

Supplier's email address:

Supplier's phone number:

Supplier's proportion of **GSTRW payment**: \$

**If more than one supplier, provide the above details for each supplier.**

Amount purchaser must pay – price multiplied by the **GSTRW rate** (residential withholding rate):\$

Amount must be paid: ☐ AT COMPLETION ☐ at another time (specify):

Is any of the consideration not expressed as an amount in money? ☐ NO ☐ yes

If "yes", the GST inclusive market value of the non-monetary consideration: \$

Other details (including those required by regulation or the ATO forms):

## List of Documents

<p><b>General</b></p> <p><input checked="" type="checkbox"/> 1 property certificate for the land</p> <p><input checked="" type="checkbox"/> 2 plan of the land</p> <p><input type="checkbox"/> 3 unregistered plan of the land</p> <p><input type="checkbox"/> 4 plan of land to be subdivided</p> <p><input type="checkbox"/> 5 document that is to be lodged with a relevant plan</p> <p><input checked="" type="checkbox"/> 6 section 10.7(2) planning certificate under Environmental Planning and Assessment Act 1979</p> <p><input checked="" type="checkbox"/> 7 additional information included in that certificate under section 10.7(5)</p> <p><input type="checkbox"/> 8 sewerage infrastructure location diagram (service location diagram)</p> <p><input type="checkbox"/> 9 sewer lines location diagram (sewerage service diagram)</p> <p><input type="checkbox"/> 10 document that created or may have created an easement, profit à prendre, restriction on use or positive covenant disclosed in this contract</p> <p><input type="checkbox"/> 11 <i>planning agreement</i></p> <p><input type="checkbox"/> 12 section 88G certificate (positive covenant)</p> <p><input type="checkbox"/> 13 survey report</p> <p><input type="checkbox"/> 14 building information certificate or building certificate given under <i>legislation</i></p> <p><input type="checkbox"/> 15 lease (with every relevant memorandum or variation)</p> <p><input type="checkbox"/> 16 other document relevant to tenancies</p> <p><input type="checkbox"/> 17 licence benefiting the land</p> <p><input type="checkbox"/> 18 old system document</p> <p><input type="checkbox"/> 19 Crown purchase statement of account</p> <p><input type="checkbox"/> 20 building management statement</p> <p><input checked="" type="checkbox"/> 21 form of requisitions</p> <p><input type="checkbox"/> 22 <i>clearance certificate</i></p> <p><input checked="" type="checkbox"/> 23 land tax certificate</p> <p><b>Home Building Act 1989</b></p> <p><input type="checkbox"/> 24 insurance certificate</p> <p><input type="checkbox"/> 25 brochure or warning</p> <p><input type="checkbox"/> 26 evidence of alternative indemnity cover</p> <p><b>Swimming Pools Act 1992</b></p> <p><input type="checkbox"/> 27 certificate of compliance</p> <p><input type="checkbox"/> 28 evidence of registration</p> <p><input type="checkbox"/> 29 relevant occupation certificate</p> <p><input type="checkbox"/> 30 certificate of non-compliance</p> <p><input type="checkbox"/> 31 detailed reasons of non-compliance</p>	<p><b>Strata or community title (clause 23 of the contract)</b></p> <p><input type="checkbox"/> 32 property certificate for strata common property</p> <p><input type="checkbox"/> 33 plan creating strata common property</p> <p><input type="checkbox"/> 34 strata by-laws</p> <p><input type="checkbox"/> 35 strata development contract or statement</p> <p><input type="checkbox"/> 36 strata management statement</p> <p><input type="checkbox"/> 37 strata renewal proposal</p> <p><input type="checkbox"/> 38 strata renewal plan</p> <p><input type="checkbox"/> 39 leasehold strata - lease of lot and common property</p> <p><input type="checkbox"/> 40 property certificate for neighbourhood property</p> <p><input type="checkbox"/> 41 plan creating neighbourhood property</p> <p><input type="checkbox"/> 42 neighbourhood development contract</p> <p><input type="checkbox"/> 43 neighbourhood management statement</p> <p><input type="checkbox"/> 44 property certificate for precinct property</p> <p><input type="checkbox"/> 45 plan creating precinct property</p> <p><input type="checkbox"/> 46 precinct development contract</p> <p><input type="checkbox"/> 47 precinct management statement</p> <p><input type="checkbox"/> 48 property certificate for community property</p> <p><input type="checkbox"/> 49 plan creating community property</p> <p><input type="checkbox"/> 50 community development contract</p> <p><input type="checkbox"/> 51 community management statement</p> <p><input type="checkbox"/> 52 document disclosing a change of by-laws</p> <p><input type="checkbox"/> 53 document disclosing a change in a development or management contract or statement</p> <p><input type="checkbox"/> 54 document disclosing a change in boundaries</p> <p><input type="checkbox"/> 55 information certificate under Strata Schemes Management Act 2015</p> <p><input type="checkbox"/> 56 information certificate under Community Land Management Act 1989</p> <p><input type="checkbox"/> 57 disclosure statement - off the plan contract</p> <p><input type="checkbox"/> 58 other document relevant to off the plan contract</p> <p><b>Other</b></p> <p><input type="checkbox"/> 59</p>
--	--

**HOLDER OF STRATA OR COMMUNITY TITLE RECORDS – Name, address, email address and telephone number**

**IMPORTANT NOTICE TO VENDORS AND PURCHASERS**

Before signing this contract you should ensure that you understand your rights and obligations, some of which are not written in this contract but are implied by law.

**WARNING—SMOKE ALARMS**

The owners of certain types of buildings and strata lots must have smoke alarms (or in certain cases heat alarms) installed in the building or lot in accordance with regulations under the *Environmental Planning and Assessment Act 1979*. It is an offence not to comply. It is also an offence to remove or interfere with a smoke alarm or heat alarm. Penalties apply.

**WARNING—LOOSE-FILL ASBESTOS INSULATION**

Before purchasing land that includes any residential premises (within the meaning of Division 1A of Part 8 of the *Home Building Act 1989*) built before 1985, a purchaser is strongly advised to consider the possibility that the premises may contain loose-fill asbestos insulation (within the meaning of Division 1A of Part 8 of the *Home Building Act 1989*). In particular, a purchaser should:

- (a) search the Register required to be maintained under Division 1A of Part 8 of the *Home Building Act 1989*, and
- (b) ask the relevant local council whether it holds any records showing that the residential premises contain loose-fill asbestos insulation.

For further information about loose-fill asbestos insulation (including areas in which residential premises have been identified as containing loose-fill asbestos insulation), contact NSW Fair Trading.

### **COOLING OFF PERIOD (PURCHASER'S RIGHTS)**

1. This is the statement required by section 66X of the *Conveyancing Act 1919* and applies to a contract for the sale of residential property.
2. **EXCEPT** in the circumstances listed in paragraph 3, the purchaser may rescind the contract at any time before 5 pm on—
  - (a) the tenth business day after the day on which the contract was made—in the case of an off the plan contract, or
  - (b) the fifth business day after the day on which the contract was made—in any other case.
3. There is **NO COOLING OFF PERIOD**:
  - (a) if, at or before the time the contract is made, the purchaser gives to the vendor (or the vendor's solicitor or agent) a certificate that complies with section 66W of the Act, or
  - (b) if the property is sold by public auction, or
  - (c) if the contract is made on the same day as the property was offered for sale by public auction but passed in, or
  - (d) if the contract is made in consequence of the exercise of an option to purchase the property, other than an option that is void under section 66ZG of the Act.
4. A purchaser exercising the right to cool off by rescinding the contract will forfeit to the vendor 0.25% of the purchase price of the property. The vendor is entitled to recover the amount forfeited from any amount paid by the purchaser as a deposit under the contract and the purchaser is entitled to a refund of any balance.

### **DISPUTES**

If you get into a dispute with the other party, the Law Society and Real Estate Institute encourage you to use informal procedures such as negotiation, independent expert appraisal, the Law Society Conveyancing Dispute Resolution Scheme or mediation (for example mediation under the Law Society Mediation Program).

### **AUCTIONS**

Regulations made under the Property, Stock and Business Agents Act 2002 prescribe a number of conditions applying to sales by auction.

**WARNINGS**

1. **Various Acts of Parliament and other matters can affect the rights of the parties to this contract. Some important matters are actions, claims, decisions, licences, notices, orders, proposals or rights of way involving:**

<b>APA Group</b>	<b>NSW Department of Education</b>
<b>Australian Taxation Office</b>	<b>NSW Fair Trading</b>
<b>Council</b>	<b>Owner of adjoining land</b>
<b>County Council</b>	<b>Privacy</b>
<b>Department of Planning, Industry and Environment</b>	<b>Public Works Advisory</b>
<b>Department of Primary Industries</b>	<b>Subsidence Advisory NSW</b>
<b>Electricity and gas</b>	<b>Telecommunications</b>
<b>Land &amp; Housing Corporation</b>	<b>Transport for NSW</b>
<b>Local Land Services</b>	<b>Water, sewerage or drainage authority</b>

**If you think that any of these matters affects the property, tell your solicitor.**
2. **A lease may be affected by the Agricultural Tenancies Act 1990, the Residential Tenancies Act 2010 or the Retail Leases Act 1994.**
3. **If any purchase money is owing to the Crown, it will become payable before obtaining consent, or if no consent is needed, when the transfer is registered.**
4. **If a consent to transfer is required under legislation, see clause 27 as to the obligations of the parties.**
5. **The vendor should continue the vendor's insurance until completion. If the vendor wants to give the purchaser possession before completion, the vendor should first ask the insurer to confirm this will not affect the insurance.**
6. **The purchaser will usually have to pay transfer duty (and sometimes surcharge purchaser duty) on this contract. If duty is not paid on time, a purchaser may incur penalties.**
7. **If the purchaser agrees to the release of deposit, the purchaser's right to recover the deposit may stand behind the rights of others (for example the vendor's mortgagee).**
8. **The purchaser should arrange insurance as appropriate.**
9. **Some transactions involving personal property may be affected by the Personal Property Securities Act 2009.**
10. **A purchaser should be satisfied that finance will be available at the time of completing the purchase.**
11. **Where the market value of the property is at or above a legislated amount, the purchaser may have to comply with a foreign resident capital gains withholding payment obligation (even if the vendor is not a foreign resident). If so, this will affect the amount available to the vendor on completion.**
12. **Purchasers of some residential properties may have to withhold part of the purchase price to be credited towards the GST liability of the vendor. If so, this will also affect the amount available to the vendor. More information is available from the ATO.**

The vendor sells and the purchaser buys the *property* for the price under these provisions instead of Schedule 3 Conveyancing Act 1919, subject to any *legislation* that cannot be excluded.

## 1 Definitions (a term in *italics* is a defined term)

In this contract, these terms (in any form) mean –

<i>adjustment date</i>	the earlier of the giving of possession to the purchaser or completion;
<i>bank</i>	the Reserve Bank of Australia or an authorised deposit-taking institution which is a bank, a building society or a credit union;
<i>business day</i>	any day except a bank or public holiday throughout NSW or a Saturday or Sunday;
<i>cheque</i>	a cheque that is not postdated or stale;
<i>clearance certificate</i>	a certificate within the meaning of s14-220 of Schedule 1 to the <i>TA Act</i> , that covers one or more days falling within the period from and including the contract date to completion;
<i>deposit-bond</i>	a deposit bond or guarantee from an issuer, with an expiry date and for an amount each approved by the vendor;
<i>depositholder</i>	vendor's agent (or if no vendor's agent is named in this contract, the vendor's <i>solicitor</i> , or if no vendor's <i>solicitor</i> is named in this contract, the buyer's agent);
<i>document of title</i>	document relevant to the title or the passing of title;
<i>FRCGW percentage</i>	the percentage mentioned in s14-200(3)(a) of Schedule 1 to the <i>TA Act</i> (12.5% as at 1 July 2017);
<i>FRCGW remittance</i>	a remittance which the purchaser must make under s14-200 of Schedule 1 to the <i>TA Act</i> , being the lesser of the <i>FRCGW percentage</i> of the price (inclusive of GST, if any) and the amount specified in a <i>variation served by a party</i> ;
<i>GST Act</i>	A New Tax System (Goods and Services Tax) Act 1999;
<i>GST rate</i>	the rate mentioned in s4 of A New Tax System (Goods and Services Tax Imposition - General) Act 1999 (10% as at 1 July 2000);
<i>GSTRW payment</i>	a payment which the purchaser must make under s14-250 of Schedule 1 to the <i>TA Act</i> (the price multiplied by the <i>GSTRW rate</i> );
<i>GSTRW rate</i>	the rate determined under ss14-250(6), (8) or (9) of Schedule 1 to the <i>TA Act</i> (as at 1 July 2018, usually 7% of the price if the margin scheme applies, 1/11 <sup>th</sup> if not);
<i>legislation</i>	an Act or a by-law, ordinance, regulation or rule made under an Act;
<i>normally</i>	subject to any other provision of this contract;
<i>party</i>	each of the vendor and the purchaser;
<i>property</i>	the land, the improvements, all fixtures and the inclusions, but not the exclusions;
<i>planning agreement</i>	a valid voluntary agreement within the meaning of s7.4 of the Environmental Planning and Assessment Act 1979 entered into in relation to the <i>property</i> ;
<i>requisition</i>	an objection, question or requisition (but the term does not include a claim);
<i>rescind</i>	rescind this contract from the beginning;
<i>serve</i>	serve in writing on the other <i>party</i> ;
<i>settlement cheque</i>	an unendorsed <i>cheque</i> made payable to the person to be paid and – <ul style="list-style-type: none"> <li>• issued by a <i>bank</i> and drawn on itself; or</li> <li>• if authorised in writing by the vendor or the vendor's <i>solicitor</i>, some other <i>cheque</i>;</li> </ul>
<i>solicitor</i>	in relation to a <i>party</i> , the <i>party's</i> solicitor or licensed conveyancer named in this contract or in a notice <i>served by the party</i> ;
<i>TA Act</i>	Taxation Administration Act 1953;
<i>terminate</i>	terminate this contract for breach;
<i>variation</i>	a variation made under s14-235 of Schedule 1 to the <i>TA Act</i> ;
<i>within</i>	in relation to a period, at any time before or during the period; and
<i>work order</i>	a valid direction, notice or order that requires work to be done or money to be spent on or in relation to the <i>property</i> or any adjoining footpath or road (but the term does not include a notice under s22E of the Swimming Pools Act 1992 or clause 22 of the Swimming Pools Regulation 2018).

## 2 Deposit and other payments before completion

- 2.1 The purchaser must pay the deposit to the *depositholder* as stakeholder.
- 2.2 *Normally*, the purchaser must pay the deposit on the making of this contract, and this time is essential.
- 2.3 If this contract requires the purchaser to pay any of the deposit by a later time, that time is also essential.
- 2.4 The purchaser can pay any of the deposit by giving cash (up to \$2,000) or by unconditionally giving a *cheque* to the *depositholder* or to the vendor, vendor's agent or vendor's *solicitor* for sending to the *depositholder* or by payment by electronic funds transfer to the *depositholder*.
- 2.5 If any of the deposit is not paid on time or a *cheque* for any of the deposit is not honoured on presentation, the vendor can *terminate*. This right to *terminate* is lost as soon as the deposit is paid in full.
- 2.6 If the vendor accepts a bond or guarantee for the deposit, clauses 2.1 to 2.5 do not apply.

- 2.7 If the vendor accepts a bond or guarantee for part of the deposit, clauses 2.1 to 2.5 apply only to the balance.
- 2.8 If any of the deposit or of the balance of the price is paid before completion to the vendor or as the vendor directs, it is a charge on the land in favour of the purchaser until *termination* by the vendor or completion, subject to any existing right.
- 2.9 If each *party* tells the *depositholder* that the deposit is to be invested, the *depositholder* is to invest the deposit (at the risk of the *party* who becomes entitled to it) with a *bank*, in an interest-bearing account in NSW, payable at call, with interest to be reinvested, and pay the interest to the *parties* equally, after deduction of all proper government taxes and financial institution charges and other charges.

### 3 Deposit-bond

- 3.1 This clause applies only if this contract says the vendor has agreed to accept a *deposit-bond* for the deposit (or part of it).
- 3.2 The purchaser must provide the original *deposit-bond* to the vendor's *solicitor* (or if no *solicitor* the *depositholder*) at or before the making of this contract and this time is essential.
- 3.3 If the *deposit-bond* has an expiry date and completion does not occur by the date which is 14 days before the expiry date, the purchaser must *serve* a replacement *deposit-bond* at least 7 days before the expiry date. The time for service is essential.
- 3.4 The vendor must approve a replacement *deposit-bond* if –
- 3.4.1 it is from the same issuer and for the same amount as the earlier *deposit-bond*; and
  - 3.4.2 it has an expiry date at least three months after its date of issue.
- 3.5 A breach of clauses 3.2 or 3.3 entitles the vendor to *terminate*. The right to *terminate* is lost as soon as –
- 3.5.1 the purchaser *serves* a replacement *deposit-bond*; or
  - 3.5.2 the deposit is paid in full under clause 2.
- 3.6 Clauses 3.3 and 3.4 can operate more than once.
- 3.7 If the purchaser *serves* a replacement *deposit-bond*, the vendor must *serve* the earlier *deposit-bond*.
- 3.8 The amount of any *deposit-bond* does not form part of the price for the purposes of clause 16.7.
- 3.9 The vendor must give the purchaser the *deposit-bond* –
- 3.9.1 on completion; or
  - 3.9.2 if this contract is *rescinded*.
- 3.10 If this contract is *terminated* by the vendor –
- 3.10.1 *normally*, the vendor can immediately demand payment from the issuer of the *deposit-bond*; or
  - 3.10.2 if the purchaser *serves* prior to *termination* a notice disputing the vendor's right to *terminate*, the vendor must forward the *deposit-bond* (or its proceeds if called up) to the *depositholder* as stakeholder.
- 3.11 If this contract is *terminated* by the purchaser –
- 3.11.1 *normally*, the vendor must give the purchaser the *deposit-bond*; or
  - 3.11.2 if the vendor *serves* prior to *termination* a notice disputing the purchaser's right to *terminate*, the vendor must forward the *deposit-bond* (or its proceeds if called up) to the *depositholder* as stakeholder.

### 4 Transfer

- 4.1 *Normally*, the purchaser must *serve* at least 14 days before the date for completion –
- 4.1.1 the form of transfer; and
  - 4.1.2 particulars required to register any mortgage or other dealing to be lodged with the transfer by the purchaser or the purchaser's mortgagee.
- 4.2 If any information needed for the form of transfer is not disclosed in this contract, the vendor must *serve* it.
- 4.3 If the purchaser *serves* a form of transfer and the transferee is not the purchaser, the purchaser must give the vendor a direction signed by the purchaser personally for this form of transfer.
- 4.4 The vendor can require the purchaser to include a form of covenant or easement in the transfer only if this contract contains the wording of the proposed covenant or easement, and a description of the land benefited.

### 5 Requisitions

- 5.1 If a form of *requisitions* is attached to this contract, the purchaser is taken to have made those *requisitions*.
- 5.2 If the purchaser is or becomes entitled to make any other *requisition*, the purchaser can make it only by *serving* it –
- 5.2.1 if it arises out of this contract or it is a general question about the *property* or title - *within* 21 days after the contract date;
  - 5.2.2 if it arises out of anything *served* by the vendor - *within* 21 days after the later of the contract date and that *service*; and
  - 5.2.3 in any other case - *within* a reasonable time.

### 6 Error or misdescription

- 6.1 *Normally*, the purchaser can (but only before completion) claim compensation for an error or misdescription in this contract (as to the *property*, the title or anything else and whether substantial or not).
- 6.2 This clause applies even if the purchaser did not take notice of or rely on anything in this contract containing or giving rise to the error or misdescription.
- 6.3 However, this clause does not apply to the extent the purchaser knows the true position.



## 7 Claims by purchaser

*Normally*, the purchaser can make a claim (including a claim under clause 6) before completion only by *serving* it with a statement of the amount claimed, and if the purchaser makes one or more claims before completion –

- 7.1 the vendor can *rescind* if in the case of claims that are not claims for delay –
  - 7.1.1 the total amount claimed exceeds 5% of the price;
  - 7.1.2 the vendor *serves* notice of intention to *rescind*; and
  - 7.1.3 the purchaser does not *serve* notice waiving the claims *within* 14 days after that *service*; and
- 7.2 if the vendor does not *rescind*, the *parties* must complete and if this contract is completed –
  - 7.2.1 the lesser of the total amount claimed and 10% of the price must be paid out of the price to and held by the *depositholder* until the claims are finalised or lapse;
  - 7.2.2 the amount held is to be invested in accordance with clause 2.9;
  - 7.2.3 the claims must be finalised by an arbitrator appointed by the *parties* or, if an appointment is not made *within* 1 month of completion, by an arbitrator appointed by the President of the Law Society at the request of a *party* (in the latter case the *parties* are bound by the terms of the Conveyancing Arbitration Rules approved by the Law Society as at the date of the appointment);
  - 7.2.4 the purchaser is not entitled, in respect of the claims, to more than the total amount claimed and the costs of the purchaser;
  - 7.2.5 net interest on the amount held must be paid to the *parties* in the same proportion as the amount held is paid; and
  - 7.2.6 if the *parties* do not appoint an arbitrator and neither *party* requests the President to appoint an arbitrator *within* 3 months after completion, the claims lapse and the amount belongs to the vendor.

## 8 Vendor's rights and obligations

- 8.1 The vendor can *rescind* if –
  - 8.1.1 the vendor is, on reasonable grounds, unable or unwilling to comply with a *requisition*;
  - 8.1.2 the vendor *serves* a notice of intention to *rescind* that specifies the *requisition* and those grounds; and
  - 8.1.3 the purchaser does not *serve* a notice waiving the *requisition* *within* 14 days after that *service*.
- 8.2 If the vendor does not comply with this contract (or a notice under or relating to it) in an essential respect, the purchaser can *terminate* by *serving* a notice. After the *termination* –
  - 8.2.1 the purchaser can recover the deposit and any other money paid by the purchaser under this contract;
  - 8.2.2 the purchaser can sue the vendor to recover damages for breach of contract; and
  - 8.2.3 if the purchaser has been in possession a *party* can claim for a reasonable adjustment.

## 9 Purchaser's default

If the purchaser does not comply with this contract (or a notice under or relating to it) in an essential respect, the vendor can *terminate* by *serving* a notice. After the *termination* the vendor can –

- 9.1 keep or recover the deposit (to a maximum of 10% of the price);
- 9.2 hold any other money paid by the purchaser under this contract as security for anything recoverable under this clause –
  - 9.2.1 for 12 months after the *termination*; or
  - 9.2.2 if the vendor commences proceedings under this clause *within* 12 months, until those proceedings are concluded; and
- 9.3 sue the purchaser either –
  - 9.3.1 where the vendor has resold the *property* under a contract made *within* 12 months after the *termination*, to recover –
    - the deficiency on resale (with credit for any of the deposit kept or recovered and after allowance for any capital gains tax or goods and services tax payable on anything recovered under this clause); and
    - the reasonable costs and expenses arising out of the purchaser's non-compliance with this contract or the notice and of resale and any attempted resale; or
  - 9.3.2 to recover damages for breach of contract.

## 10 Restrictions on rights of purchaser

- 10.1 The purchaser cannot make a claim or *requisition* or *rescind* or *terminate* in respect of –
  - 10.1.1 the ownership or location of any fence as defined in the Dividing Fences Act 1991;
  - 10.1.2 a service for the *property* being a joint service or passing through another property, or any service for another property passing through the *property* ('service' includes air, communication, drainage, electricity, garbage, gas, oil, radio, sewerage, telephone, television or water service);
  - 10.1.3 a wall being or not being a party wall in any sense of that term or the *property* being affected by an easement for support or not having the benefit of an easement for support;
  - 10.1.4 any change in the *property* due to fair wear and tear before completion;
  - 10.1.5 a promise, representation or statement about this contract, the *property* or the title, not set out or referred to in this contract;
  - 10.1.6 a condition, exception, reservation or restriction in a Crown grant;

- 10.1.7 the existence of any authority or licence to explore or prospect for gas, minerals or petroleum; any
- 10.1.8 easement or restriction on use the substance of either of which is disclosed in this contract or any non-compliance with the easement or restriction on use; or
- 10.1.9 anything the substance of which is disclosed in this contract (except a caveat, charge, mortgage, priority notice or writ).

- 10.2 The purchaser cannot *rescind* or *terminate* only because of a defect in title to or quality of the inclusions.
- 10.3 *Normally*, the purchaser cannot make a claim or *requisition* or *rescind* or *terminate* or require the vendor to change the nature of the title disclosed in this contract (for example, to remove a caution evidencing qualified title, or to lodge a plan of survey as regards limited title).

## 11 Compliance with work orders

- 11.1 *Normally*, the vendor must by completion comply with a *work order* made on or before the contract date and if this contract is completed the purchaser must comply with any other *work order*.
- 11.2 If the purchaser complies with a *work order*, and this contract is *rescinded* or *terminated*, the vendor must pay the expense of compliance to the purchaser.

## 12 Certificates and inspections

- The vendor must do everything reasonable to enable the purchaser, subject to the rights of any tenant –
- 12.1 to have the *property* inspected to obtain any certificate or report reasonably required;
- 12.2 to apply (if necessary in the name of the vendor) for –
  - 12.2.1 any certificate that can be given in respect of the *property* under *legislation*; or
  - 12.2.2 a copy of any approval, certificate, consent, direction, notice or order in respect of the *property* given under *legislation*, even if given after the contract date; and
- 12.3 to make 1 inspection of the *property* in the 3 days before a time appointed for completion.

## 13 Goods and services tax (GST)

- 13.1 Terms used in this clause which are not defined elsewhere in this contract and have a defined meaning in the *GST Act* have the same meaning in this clause.
- 13.2 *Normally*, if a *party* must pay the price or any other amount to the other *party* under this contract, GST is not to be added to the price or amount.
- 13.3 If under this contract a *party* must make an adjustment or payment for an expense of another party or pay an expense payable by or to a third party (for example, under clauses 14 or 20.7) –
  - 13.3.1 the *party* must adjust or pay on completion any GST added to or included in the expense; but
  - 13.3.2 the amount of the expense must be reduced to the extent the party receiving the adjustment or payment (or the representative member of a GST group of which that party is a member) is entitled to an input tax credit for the expense; and
  - 13.3.3 if the adjustment or payment under this contract is consideration for a taxable supply, an amount for GST must be added at the *GST rate*.
- 13.4 If this contract says this sale is the supply of a going concern –
  - 13.4.1 the *parties* agree the supply of the *property* is a supply of a going concern;
  - 13.4.2 the vendor must, between the contract date and completion, carry on the enterprise conducted on the land in a proper and business-like way;
  - 13.4.3 if the purchaser is not registered by the date for completion, the *parties* must complete and the purchaser must pay on completion, in addition to the price, an amount being the price multiplied by the *GST rate* ("the retention sum"). The retention sum is to be held by the *depositholder* and dealt with as follows –
    - if *within* 3 months of completion the purchaser *serves* a letter from the Australian Taxation Office stating the purchaser is registered with a date of effect of registration on or before completion, the *depositholder* is to pay the retention sum to the purchaser; but
    - if the purchaser does not *serve* that letter *within* 3 months of completion, the *depositholder* is to pay the retention sum to the vendor; and
  - 13.4.4 if the vendor, despite clause 13.4.1, *serves* a letter from the Australian Taxation Office stating the vendor has to pay GST on the supply, the purchaser must pay to the vendor on demand the amount of GST assessed.
- 13.5 *Normally*, the vendor promises the margin scheme will not apply to the supply of the *property*.
- 13.6 If this contract says the margin scheme is to apply in making the taxable supply, the *parties* agree that the margin scheme is to apply to the sale of the *property*.
- 13.7 If this contract says the sale is not a taxable supply –
  - 13.7.1 the purchaser promises that the *property* will not be used and represents that the purchaser does not intend the *property* (or any part of the *property*) to be used in a way that could make the sale a taxable supply to any extent; and
  - 13.7.2 the purchaser must pay the vendor on completion in addition to the price an amount calculated by multiplying the price by the *GST rate* if this sale is a taxable supply to any extent because of –
    - a breach of clause 13.7.1; or
    - something else known to the purchaser but not the vendor.
- 13.8 If this contract says this sale is a taxable supply in full and does not say the margin scheme applies to the *property*, the vendor must pay the purchaser on completion an amount of one-eleventh of the price if –

- 13.8.1 this sale is not a taxable supply in full; or
- 13.8.2 the margin scheme applies to the *property* (or any part of the *property*).
- 13.9 If this contract says this sale is a taxable supply to an extent –
- 13.9.1 clause 13.7.1 does not apply to any part of the *property* which is identified as being a taxable supply; and
- 13.9.2 the payments mentioned in clauses 13.7 and 13.8 are to be recalculated by multiplying the relevant payment by the proportion of the price which represents the value of that part of the *property* to which the clause applies (the proportion to be expressed as a number between 0 and 1). Any evidence of value must be obtained at the expense of the vendor.
- 13.10 *Normally*, on completion the vendor must give the recipient of the supply a tax invoice for any taxable supply by the vendor by or under this contract.
- 13.11 The vendor does not have to give the purchaser a tax invoice if the margin scheme applies to a taxable supply.
- 13.12 If the vendor is liable for GST on rents or profits due to issuing an invoice or receiving consideration before completion, any adjustment of those amounts must exclude an amount equal to the vendor's GST liability.
- 13.13 If the purchaser must make a *GSTRW payment* the purchaser must –
- 13.13.1 at least 5 days before the date for completion, *serve* evidence of submission of a *GSTRW payment* notification form to the Australian Taxation Office by the purchaser or, if a direction under clause 4.3 has been *served*, by the transferee named in the transfer *served* with that direction;
- 13.13.2 produce on completion a *settlement cheque* for the *GSTRW payment* payable to the Deputy Commissioner of Taxation;
- 13.13.3 forward the *settlement cheque* to the payee immediately after completion; and
- 13.13.4 *serve* evidence of receipt of payment of the *GSTRW payment* and a copy of the settlement date confirmation form submitted to the Australian Taxation Office.

## 14 Adjustments

- 14.1 *Normally*, the vendor is entitled to the rents and profits and will be liable for all rates, water, sewerage and drainage service and usage charges, land tax, levies and all other periodic outgoings up to and including the *adjustment date* after which the purchaser will be entitled and liable.
- 14.2 The *parties* must make any necessary adjustment on completion.
- 14.3 If an amount that is adjustable under this contract has been reduced under *legislation*, the *parties* must on completion adjust the reduced amount.
- 14.4 The *parties* must not adjust surcharge land tax (as defined in the Land Tax Act 1956) but must adjust any other land tax for the year current at the *adjustment date* –
- 14.4.1 only if land tax has been paid or is payable for the year (whether by the vendor or by a predecessor in title) and this contract says that land tax is adjustable;
- 14.4.2 by adjusting the amount that would have been payable if at the start of the year –
- the person who owned the land owned no other land;
  - the land was not subject to a special trust or owned by a non-concessional company; and
  - if the land (or part of it) had no separate taxable value, by calculating its separate taxable value on a proportional area basis.
- 14.5 If any other amount that is adjustable under this contract relates partly to the land and partly to other land, the *parties* must adjust it on a proportional area basis.
- 14.6 *Normally*, the vendor can direct the purchaser to produce a *settlement cheque* on completion to pay an amount adjustable under this contract and if so –
- 14.6.1 the amount is to be treated as if it were paid; and
- 14.6.2 the *cheque* must be forwarded to the payee immediately after completion (by the purchaser if the *cheque* relates only to the *property* or by the vendor in any other case).
- 14.7 If on completion the last bill for a water, sewerage or drainage usage charge is for a period ending before the *adjustment date*, the vendor is liable for an amount calculated by dividing the bill by the number of days in the period then multiplying by the number of unbilled days up to and including the *adjustment date*.
- 14.8 The vendor is liable for any amount recoverable for work started on or before the contract date on the *property* or any adjoining footpath or road.

## 15 Date for completion

The *parties* must complete by the date for completion and, if they do not, a *party* can *serve* a notice to complete if that *party* is otherwise entitled to do so.

## 16 Completion

### • Vendor

- 16.1 On completion the vendor must give the purchaser any *document of title* that relates only to the *property*.
- 16.2 If on completion the vendor has possession or control of a *document of title* that relates also to other property, the vendor must produce it as and where necessary.
- 16.3 *Normally*, on completion the vendor must cause the legal title to the *property* (being an estate in fee simple) to pass to the purchaser free of any mortgage or other interest, subject to any necessary registration.
- 16.4 The legal title to the *property* does not pass before completion.

- 16.5 If the vendor gives the purchaser a document (other than the transfer) that needs to be lodged for registration, the vendor must pay the lodgment fee to the purchaser.
- 16.6 If a *party serves* a land tax certificate showing a charge on any of the land, by completion the vendor must do all things and pay all money required so that the charge is no longer effective against the land.
- **Purchaser**
- 16.7 On completion the purchaser must pay to the vendor, by cash (up to \$2,000) or *settlement cheque* –
- 16.7.1 the price less any:
- deposit paid;
  - *FRCGW remittance* payable;
  - *GSTRW payment*; and
  - amount payable by the vendor to the purchaser under this contract; and
- 16.7.2 any other amount payable by the purchaser under this contract.
- 16.8 If the vendor requires more than 5 *settlement cheques*, the vendor must pay \$10 for each extra *cheque*.
- 16.9 If any of the deposit is not covered by a bond or guarantee, on completion the purchaser must give the vendor an order signed by the purchaser authorising the *depositholder* to account to the vendor for the deposit.
- 16.10 On completion the deposit belongs to the vendor.
- **Place for completion**
- 16.11 *Normally*, the *parties* must complete at the completion address, which is –
- 16.11.1 if a special completion address is stated in this contract - that address; or
- 16.11.2 if none is stated, but a first mortgagee is disclosed in this contract and the mortgagee would usually discharge the mortgage at a particular place - that place; or
- 16.11.3 in any other case - the vendor's *solicitor's* address stated in this contract.
- 16.12 The vendor by reasonable notice can require completion at another place, if it is in NSW, but the vendor must pay the purchaser's additional expenses, including any agency or mortgagee fee.
- 16.13 If the purchaser requests completion at a place that is not the completion address, and the vendor agrees, the purchaser must pay the vendor's additional expenses, including any agency or mortgagee fee.
- 17 Possession**
- 17.1 *Normally*, the vendor must give the purchaser vacant possession of the *property* on completion.
- 17.2 The vendor does not have to give vacant possession if –
- 17.2.1 this contract says that the sale is subject to existing tenancies; and
- 17.2.2 the contract discloses the provisions of the tenancy (for example, by attaching a copy of the lease and any relevant memorandum or variation).
- 17.3 *Normally*, the purchaser can claim compensation (before or after completion) or *rescind* if any of the land is affected by a protected tenancy (a tenancy affected by Schedule 2, Part 7 of the Residential Tenancies Act 2010).
- 18 Possession before completion**
- 18.1 This clause applies only if the vendor gives the purchaser possession of the *property* before completion.
- 18.2 The purchaser must not before completion –
- 18.2.1 let or part with possession of any of the *property*;
- 18.2.2 make any change or structural alteration or addition to the *property*; or
- 18.2.3 contravene any agreement between the *parties* or any direction, document, *legislation*, notice or order affecting the *property*.
- 18.3 The purchaser must until completion –
- 18.3.1 keep the *property* in good condition and repair having regard to its condition at the giving of possession; and
- 18.3.2 allow the vendor or the vendor's authorised representative to enter and inspect it at all reasonable times.
- 18.4 The risk as to damage to the *property* passes to the purchaser immediately after the purchaser enters into possession.
- 18.5 If the purchaser does not comply with this clause, then without affecting any other right of the vendor –
- 18.5.1 the vendor can before completion, without notice, remedy the non-compliance; and
- 18.5.2 if the vendor pays the expense of doing this, the purchaser must pay it to the vendor with interest at the rate prescribed under s101 Civil Procedure Act 2005.
- 18.6 If this contract is *rescinded* or *terminated* the purchaser must immediately vacate the *property*.
- 18.7 If the *parties* or their *solicitors* on their behalf do not agree in writing to a fee or rent, none is payable.
- 19 Rescission of contract**
- 19.1 If this contract expressly gives a *party* a right to *rescind*, the *party* can exercise the right –
- 19.1.1 only by *serving* a notice before completion; and
- 19.1.2 in spite of any making of a claim or *requisition*, any attempt to satisfy a claim or *requisition*, any arbitration, litigation, mediation or negotiation or any giving or taking of possession.
- 19.2 *Normally*, if a *party* exercises a right to *rescind* expressly given by this contract or any *legislation* –
- 19.2.1 the deposit and any other money paid by the purchaser under this contract must be refunded;
- 19.2.2 a *party* can claim for a reasonable adjustment if the purchaser has been in possession;
- 19.2.3 a *party* can claim for damages, costs or expenses arising out of a breach of this contract; and
- 19.2.4 a *party* will not otherwise be liable to pay the other *party* any damages, costs or expenses.

**20 Miscellaneous**

- 20.1 The *parties* acknowledge that anything stated in this contract to be attached was attached to this contract by the vendor before the purchaser signed it and is part of this contract.
- 20.2 Anything attached to this contract is part of this contract.
- 20.3 An area, bearing or dimension in this contract is only approximate.
- 20.4 If a *party* consists of 2 or more persons, this contract benefits and binds them separately and together.
- 20.5 A *party's solicitor* can receive any amount payable to the *party* under this contract or direct in writing that it is to be paid to another person.
- 20.6 A document under or relating to this contract is –
- 20.6.1 signed by a *party* if it is signed by the *party* or the *party's solicitor* (apart from a direction under clause 4.3);
  - 20.6.2 *served* if it is *served* by the *party* or the *party's solicitor*;
  - 20.6.3 *served* if it is *served* on the *party's solicitor*, even if the *party* has died or any of them has died;
  - 20.6.4 *served* if it is *served* in any manner provided in s170 of the Conveyancing Act 1919;
  - 20.6.5 *served* if it is sent by email or fax to the *party's solicitor*, unless in either case it is not received;
  - 20.6.6 *served* on a person if it (or a copy of it) comes into the possession of the person; and
  - 20.6.7 *served* at the earliest time it is *served*, if it is *served* more than once.
- 20.7 An obligation to pay an expense of another *party* of doing something is an obligation to pay –
- 20.7.1 if the *party* does the thing personally - the reasonable cost of getting someone else to do it; or
  - 20.7.2 if the *party* pays someone else to do the thing - the amount paid, to the extent it is reasonable.
- 20.8 Rights under clauses 11, 13, 14, 17, 24, 30 and 31 continue after completion, whether or not other rights continue.
- 20.9 The vendor does not promise, represent or state that the purchaser has any cooling off rights.
- 20.10 The vendor does not promise, represent or state that any attached survey report is accurate or current.
- 20.11 A reference to any *legislation* (including any percentage or rate specified in *legislation*) is also a reference to any corresponding later *legislation*.
- 20.12 Each *party* must do whatever is necessary after completion to carry out the *party's* obligations under this contract.
- 20.13 Neither taking possession nor *serving* a transfer of itself implies acceptance of the *property* or the title.
- 20.14 The details and information provided in this contract (for example, on pages 1 - 3) are, to the extent of each *party's* knowledge, true, and are part of this contract.
- 20.15 Where this contract provides for choices, a choice in BLOCK CAPITALS applies unless a different choice is marked.

**21 Time limits in these provisions**

- 21.1 If the time for something to be done or to happen is not stated in these provisions, it is a reasonable time.
- 21.2 If there are conflicting times for something to be done or to happen, the latest of those times applies.
- 21.3 The time for one thing to be done or to happen does not extend the time for another thing to be done or to happen.
- 21.4 If the time for something to be done or to happen is the 29th, 30th or 31st day of a month, and the day does not exist, the time is instead the last day of the month.
- 21.5 If the time for something to be done or to happen is a day that is not a *business day*, the time is extended to the next *business day*, except in the case of clauses 2 and 3.2.
- 21.6 *Normally*, the time by which something must be done is fixed but not essential.

**22 Foreign Acquisitions and Takeovers Act 1975**

- 22.1 The purchaser promises that the Commonwealth Treasurer cannot prohibit and has not prohibited the transfer under the Foreign Acquisitions and Takeovers Act 1975.
- 22.2 This promise is essential and a breach of it entitles the vendor to *terminate*.

**23 Strata or community title****• Definitions and modifications**

- 23.1 This clause applies only if the land (or part of it) is a lot in a strata, neighbourhood, precinct or community scheme (or on completion is to be a lot in a scheme of that kind).
- 23.2 In this contract –
- 23.2.1 'change', in relation to a scheme, means –
    - a registered or registrable change from by-laws set out in this contract;
    - a change from a development or management contract or statement set out in this contract; or
    - a change in the boundaries of common property;
  - 23.2.2 'common property' includes association property for the scheme or any higher scheme;
  - 23.2.3 'contribution' includes an amount payable under a by-law;
  - 23.2.4 'information certificate' includes a certificate under s184 Strata Schemes Management Act 2015 and s26 Community Land Management Act 1989;
  - 23.2.5 'information notice' includes a strata information notice under s22 Strata Schemes Management Act 2015 and a notice under s47 Community Land Management Act 1989;

- 23.2.6 'normal expenses', in relation to an owners corporation for a scheme, means normal operating expenses usually payable from the administrative fund of an owners corporation for a scheme of the same kind;
- 23.2.7 'owners corporation' means the owners corporation or the association for the scheme or any higher scheme;
- 23.2.8 'the *property*' includes any interest in common property for the scheme associated with the lot; and
- 23.2.9 'special expenses', in relation to an owners corporation, means its actual, contingent or expected expenses, except to the extent they are –
- normal expenses;
  - due to fair wear and tear;
  - disclosed in this contract; or
  - covered by moneys held in the capital works fund.
- 23.3 Clauses 11, 14.8 and 18.4 do not apply to an obligation of the owners corporation, or to property insurable by it.
- 23.4 Clauses 14.4.2 and 14.5 apply but on a unit entitlement basis instead of an area basis.
- **Adjustments and liability for expenses**
- 23.5 The *parties* must adjust under clause 14.1 –
- 23.5.1 a regular periodic contribution;
- 23.5.2 a contribution which is not a regular periodic contribution but is disclosed in this contract; and
- 23.5.3 on a unit entitlement basis, any amount paid by the vendor for a normal expense of the owners corporation to the extent the owners corporation has not paid the amount to the vendor.
- 23.6 If a contribution is not a regular periodic contribution and is not disclosed in this contract –
- 23.6.1 the vendor is liable for it if it was determined on or before the contract date, even if it is payable by instalments; and
- 23.6.2 the purchaser is liable for all contributions determined after the contract date.
- 23.7 The vendor must pay or allow to the purchaser on completion the amount of any unpaid contributions for which the vendor is liable under clause 23.6.1.
- 23.8 *Normally*, the purchaser cannot make a claim or *requisition* or *rescind* or *terminate* in respect of –
- 23.8.1 an existing or future actual, contingent or expected expense of the owners corporation;
- 23.8.2 a proportional unit entitlement of the lot or a relevant lot or former lot, apart from a claim under clause 6; or
- 23.8.3 a past or future change in the scheme or a higher scheme.
- 23.9 However, the purchaser can *rescind* if –
- 23.9.1 the special expenses of the owners corporation at the later of the contract date and the creation of the owners corporation when calculated on a unit entitlement basis (and, if more than one lot or a higher scheme is involved, added together), less any contribution paid by the vendor, are more than 1% of the price;
- 23.9.2 in the case of the lot or a relevant lot or former lot in a higher scheme, a proportional unit entitlement for the lot is disclosed in this contract but the lot has a different proportional unit entitlement at the contract date or at any time before completion;
- 23.9.3 a change before the contract date or before completion in the scheme or a higher scheme materially prejudices the purchaser and is not disclosed in this contract; or
- 23.9.4 a resolution is passed by the owners corporation before the contract date or before completion to give to the owners in the scheme for their consideration a strata renewal plan that has not lapsed at the contract date and there is not attached to this contract a strata renewal proposal or the strata renewal plan.
- **Notices, certificates and inspections**
- 23.10 The purchaser must give the vendor 2 copies of an information notice addressed to the owners corporation and signed by the purchaser.
- 23.11 The vendor must complete and sign 1 copy of the notice and give it to the purchaser on completion.
- 23.12 Each *party* can sign and give the notice as agent for the other.
- 23.13 The vendor must *serve* an information certificate issued after the contract date in relation to the lot, the scheme or any higher scheme at least 7 days before the date for completion.
- 23.14 The purchaser does not have to complete earlier than 7 days after *service* of the certificate and clause 21.3 does not apply to this provision. On completion the purchaser must pay the vendor the prescribed fee for the certificate.
- 23.15 The vendor authorises the purchaser to apply for the purchaser's own certificate.
- 23.16 The vendor authorises the purchaser to apply for and make an inspection of any record or other document in the custody or control of the owners corporation or relating to the scheme or any higher scheme.
- **Meetings of the owners corporation**
- 23.17 If a general meeting of the owners corporation is convened before completion –
- 23.17.1 if the vendor receives notice of it, the vendor must immediately notify the purchaser of it; and
- 23.17.2 after the expiry of any cooling off period, the purchaser can require the vendor to appoint the purchaser (or the purchaser's nominee) to exercise any voting rights of the vendor in respect of the lot at the meeting.

**24 Tenancies**

- 24.1 If a tenant has not made a payment for a period preceding or current at the *adjustment date* –
- 24.1.1 for the purposes of clause 14.2, the amount is to be treated as if it were paid; and
- 24.1.2 the purchaser assigns the debt to the vendor on completion and will if required give a further assignment at the vendor's expense.
- 24.2 If a tenant has paid in advance of the *adjustment date* any periodic payment in addition to rent, it must be adjusted as if it were rent for the period to which it relates.
- 24.3 If the *property* is to be subject to a tenancy on completion or is subject to a tenancy on completion –
- 24.3.1 the vendor authorises the purchaser to have any accounting records relating to the tenancy inspected and audited and to have any other document relating to the tenancy inspected;
- 24.3.2 the vendor must *serve* any information about the tenancy reasonably requested by the purchaser before or after completion; and
- 24.3.3 *normally*, the purchaser can claim compensation (before or after completion) if –
- a disclosure statement required by the Retail Leases Act 1994 was not given when required;
  - such a statement contained information that was materially false or misleading;
  - a provision of the lease is not enforceable because of a non-disclosure in such a statement; or
  - the lease was entered into in contravention of the Retail Leases Act 1994.
- 24.4 If the *property* is subject to a tenancy on completion –
- 24.4.1 the vendor must allow or transfer –
- any remaining bond money or any other security against the tenant's default (to the extent the security is transferable);
  - any money in a fund established under the lease for a purpose and compensation for any money in the fund or interest earned by the fund that has been applied for any other purpose; and
  - any money paid by the tenant for a purpose that has not been applied for that purpose and compensation for any of the money that has been applied for any other purpose;
- 24.4.2 if the security is not transferable, each *party* must do everything reasonable to cause a replacement security to issue for the benefit of the purchaser and the vendor must hold the original security on trust for the benefit of the purchaser until the replacement security issues;
- 24.4.3 the vendor must give to the purchaser –
- a proper notice of the transfer (an attornment notice) addressed to the tenant;
  - any certificate given under the Retail Leases Act 1994 in relation to the tenancy;
  - a copy of any disclosure statement given under the Retail Leases Act 1994;
  - a copy of any document served on the tenant under the lease and written details of its service, if the document concerns the rights of the landlord or the tenant after completion; and
  - any document served by the tenant under the lease and written details of its service, if the document concerns the rights of the landlord or the tenant after completion;
- 24.4.4 the vendor must comply with any obligation to the tenant under the lease, to the extent it is to be complied with by completion; and
- 24.4.5 the purchaser must comply with any obligation to the tenant under the lease, to the extent that the obligation is disclosed in this contract and is to be complied with after completion.

**25 Qualified title, limited title and old system title**

- 25.1 This clause applies only if the land (or part of it) –
- 25.1.1 is under qualified, limited or old system title; or
- 25.1.2 on completion is to be under one of those titles.
- 25.2 The vendor must *serve* a proper abstract of title *within 7 days* after the contract date.
- 25.3 If an abstract of title or part of an abstract of title is attached to this contract or has been lent by the vendor to the purchaser before the contract date, the abstract or part is *served* on the contract date.
- 25.4 An abstract of title can be or include a list of documents, events and facts arranged (apart from a will or codicil) in date order, if the list in respect of each document –
- 25.4.1 shows its date, general nature, names of parties and any registration number; and
- 25.4.2 has attached a legible photocopy of it or of an official or registration copy of it.
- 25.5 An abstract of title –
- 25.5.1 must start with a good root of title (if the good root of title must be at least 30 years old, this means 30 years old at the contract date);
- 25.5.2 in the case of a leasehold interest, must include an abstract of the lease and any higher lease;
- 25.5.3 *normally*, need not include a Crown grant; and
- 25.5.4 need not include anything evidenced by the Register kept under the Real Property Act 1900.
- 25.6 In the case of land under old system title –
- 25.6.1 in this contract 'transfer' means conveyance;
- 25.6.2 the purchaser does not have to *serve* the form of transfer until after the vendor has *served* a proper abstract of title; and
- 25.6.3 each vendor must give proper covenants for title as regards that vendor's interest.
- 25.7 In the case of land under limited title but not under qualified title –

- 25.7.1 *normally*, the abstract of title need not include any document which does not show the location, area or dimensions of the land (for example, by including a metes and bounds description or a plan of the land);
- 25.7.2 clause 25.7.1 does not apply to a document which is the good root of title; and
- 25.7.3 the vendor does not have to provide an abstract if this contract contains a delimitation plan (whether in registrable form or not).

25.8 The vendor must give a proper covenant to produce where relevant.

25.9 The vendor does not have to produce or covenant to produce a document that is not in the possession of the vendor or a mortgagee.

25.10 If the vendor is unable to produce an original document in the chain of title, the purchaser will accept a photocopy from the Registrar-General of the registration copy of that document.

## **26 Crown purchase money**

26.1 This clause applies only if purchase money is payable to the Crown, whether or not due for payment.

26.2 The vendor is liable for the money, except to the extent this contract says the purchaser is liable for it.

26.3 To the extent the vendor is liable for it, the vendor is liable for any interest until completion.

26.4 To the extent the purchaser is liable for it, the *parties* must adjust any interest under clause 14.1.

## **27 Consent to transfer**

27.1 This clause applies only if the land (or part of it) cannot be transferred without consent under *legislation* or a *planning agreement*.

27.2 The purchaser must properly complete and then *serve* the purchaser's part of an application for consent to transfer of the land (or part of it) *within 7 days* after the contract date.

27.3 The vendor must apply for consent *within 7 days* after *service* of the purchaser's part.

27.4 If consent is refused, either *party* can *rescind*.

27.5 If consent is given subject to one or more conditions that will substantially disadvantage a *party*, then that *party* can *rescind within 7 days* after receipt by or *service* upon the *party* of written notice of the conditions.

27.6 If consent is not given or refused –

27.6.1 *within 42 days* after the purchaser *serves* the purchaser's part of the application, the purchaser can *rescind*; or

27.6.2 *within 30 days* after the application is made, either *party* can *rescind*.

27.7 Each period in clause 27.6 becomes 90 days if the land (or part of it) is –

27.7.1 under a *planning agreement*; or

27.7.2 in the Western Division.

27.8 If the land (or part of it) is described as a lot in an unregistered plan, each time in clause 27.6 becomes the later of the time and 35 days after creation of a separate folio for the lot.

27.9 The date for completion becomes the later of the date for completion and 14 days after *service* of the notice granting consent to transfer.

## **28 Unregistered plan**

28.1 This clause applies only if some of the land is described as a lot in an unregistered plan.

28.2 The vendor must do everything reasonable to have the plan registered *within 6 months* after the contract date, with or without any minor alteration to the plan or any document to be lodged with the plan validly required or made under *legislation*.

28.3 If the plan is not registered *within* that time and in that manner –

28.3.1 the purchaser can *rescind*; and

28.3.2 the vendor can *rescind*, but only if the vendor has complied with clause 28.2 and with any *legislation* governing the rescission.

28.4 Either *party* can *serve* notice of the registration of the plan and every relevant lot and plan number.

28.5 The date for completion becomes the later of the date for completion and 21 days after *service* of the notice.

28.6 Clauses 28.2 and 28.3 apply to another plan that is to be registered before the plan is registered.

## **29 Conditional contract**

29.1 This clause applies only if a provision says this contract or completion is conditional on an event.

29.2 If the time for the event to happen is not stated, the time is 42 days after the contract date.

29.3 If this contract says the provision is for the benefit of a *party*, then it benefits only that *party*.

29.4 If anything is necessary to make the event happen, each *party* must do whatever is reasonably necessary to cause the event to happen.

29.5 A *party* can *rescind* under this clause only if the *party* has substantially complied with clause 29.4.

29.6 If the event involves an approval and the approval is given subject to a condition that will substantially disadvantage a *party* who has the benefit of the provision, the *party* can *rescind within 7 days* after either *party* *serves* notice of the condition.

29.7 If the *parties* can lawfully complete without the event happening –

29.7.1 if the event does not happen *within* the time for it to happen, a *party* who has the benefit of the provision can *rescind within 7 days* after the end of that time;

29.7.2 if the event involves an approval and an application for the approval is refused, a *party* who has the benefit of the provision can *rescind within 7 days* after either *party* *serves* notice of the refusal; and



- 29.7.3 the date for completion becomes the later of the date for completion and 21 days after the earliest of –
- either *party serving* notice of the event happening;
  - every *party* who has the benefit of the provision *serving* notice waiving the provision; or
  - the end of the time for the event to happen.
- 29.8 If the *parties* cannot lawfully complete without the event happening –
- 29.8.1 if the event does not happen *within* the time for it to happen, either *party* can *rescind*;
- 29.8.2 if the event involves an approval and an application for the approval is refused, either *party* can *rescind*;
- 29.8.3 the date for completion becomes the later of the date for completion and 21 days after either *party* serves notice of the event happening.
- 29.9 A *party* cannot *rescind* under clauses 29.7 or 29.8 after the event happens.
- 30 Electronic transaction**
- 30.1 This *Conveyancing Transaction* is to be conducted as an *electronic transaction* if –
- 30.1.1 this contract says that it is an *electronic transaction*;
- 30.1.2 the *parties* otherwise agree that it is to be conducted as an *electronic transaction*; or
- 30.1.3 the *conveyancing rules* require it to be conducted as an *electronic transaction*.
- 30.2 However, this *Conveyancing Transaction* is not to be conducted as an *electronic transaction* –
- 30.2.1 if the land is not *electronically tradeable* or the transfer is not eligible to be lodged electronically; or
- 30.2.2 if, at any time after the *effective date*, but at least 14 days before the date for completion, a *party* serves a notice stating a valid reason why it cannot be conducted as an *electronic transaction*.
- 30.3 If, because of clause 30.2.2, this *Conveyancing Transaction* is not to be conducted as an *electronic transaction* –
- 30.3.1 each *party* must –
- bear equally any disbursements or fees; and
  - otherwise bear that *party's* own costs;
- incurred because this *Conveyancing Transaction* was to be conducted as an *electronic transaction*; and
- 30.3.2 if a *party* has paid all of a disbursement or fee which, by reason of this clause, is to be borne equally by the *parties*, that amount must be adjusted under clause 14.2.
- 30.4 If this *Conveyancing Transaction* is to be conducted as an *electronic transaction* –
- 30.4.1 to the extent that any other provision of this contract is inconsistent with this clause, the provisions of this clause prevail;
- 30.4.2 *normally*, words and phrases used in this clause 30 (italicised and in Title Case, such as *Electronic Workspace* and *Lodgment Case*) have the same meaning which they have in the *participation rules*;
- 30.4.3 the *parties* must conduct the *electronic transaction* –
- in accordance with the *participation rules* and the *ECNL*; and
  - using the nominated *ELN*, unless the *parties* otherwise agree;
- 30.4.4 a *party* must pay the fees and charges payable by that *party* to the *ELNO* and the *Land Registry* as a result of this transaction being an *electronic transaction*;
- 30.4.5 any communication from one *party* to another *party* in the *Electronic Workspace* made –
- after the *effective date*; and
  - before the receipt of a notice given under clause 30.2.2;
- is taken to have been received by that *party* at the time determined by s13A of the *Electronic Transactions Act 2000*; and
- 30.4.6 a document which is an *electronic document* is served as soon as it is first *Digitally Signed* in the *Electronic Workspace* on behalf of the *party* required to serve it.
- 30.5 *Normally*, the vendor must *within 7 days* of the *effective date* –
- 30.5.1 create an *Electronic Workspace*;
- 30.5.2 *populate* the *Electronic Workspace* with *title data*, the date for completion and, if applicable, *mortgagee details*; and
- 30.5.3 invite the purchaser and any *discharging mortgagee* to the *Electronic Workspace*.
- 30.6 If the vendor has not created an *Electronic Workspace* in accordance with clause 30.5, the purchaser may create an *Electronic Workspace*. If the purchaser creates the *Electronic Workspace* the purchaser must –
- 30.6.1 *populate* the *Electronic Workspace* with *title data*;
- 30.6.2 create and *populate* an *electronic transfer*;
- 30.6.3 *populate* the *Electronic Workspace* with the date for completion and a nominated *completion time*; and
- 30.6.4 invite the vendor and any *incoming mortgagee* to join the *Electronic Workspace*.
- 30.7 *Normally*, *within 7 days* of receiving an invitation from the vendor to join the *Electronic Workspace*, the purchaser must –
- 30.7.1 join the *Electronic Workspace*;
- 30.7.2 create and *populate* an *electronic transfer*;
- 30.7.3 invite any *incoming mortgagee* to join the *Electronic Workspace*; and
- 30.7.4 *populate* the *Electronic Workspace* with a nominated *completion time*.

- 30.8 If the purchaser has created the *Electronic Workspace* the vendor must *within 7 days* of being invited to the *Electronic Workspace* –
- 30.8.1 join the *Electronic Workspace*;
  - 30.8.2 *populate* the *Electronic Workspace* with *mortgagee details*, if applicable; and
  - 30.8.3 invite any *discharging mortgagee* to join the *Electronic Workspace*.
- 30.9 To complete the financial settlement schedule in the *Electronic Workspace* –
- 30.9.1 the purchaser must provide the vendor with *adjustment figures* at least *2 business days* before the date for completion;
  - 30.9.2 the vendor must confirm the *adjustment figures* at least *1 business day* before the date for completion; and
  - 30.9.3 if the purchaser must make a *GSTRW payment* or an *FRCGW remittance*, the purchaser must *populate* the *Electronic Workspace* with the payment details for the *GSTRW payment* or *FRCGW remittance* payable to the Deputy Commissioner of Taxation at least *2 business days* before the date for completion.
- 30.10 Before completion, the *parties* must ensure that –
- 30.10.1 all *electronic documents* which a *party* must *Digitally Sign* to complete the *electronic transaction* are *populated* and *Digitally Signed*;
  - 30.10.2 all certifications required by the *ECNL* are properly given; and
  - 30.10.3 they do everything else in the *Electronic Workspace* which that *party* must do to enable the *electronic transaction* to proceed to completion.
- 30.11 If completion takes place in the *Electronic Workspace* –
- 30.11.1 payment electronically on completion of the price in accordance with clause 16.7 is taken to be payment by a single *settlement cheque*;
  - 30.11.2 the completion address in clause 16.11 is the *Electronic Workspace*; and
  - 30.11.3 clauses 13.13.2 to 13.13.4, 16.8, 16.12, 16.13 and 31.2.2 to 31.2.4 do not apply.
- 30.12 If the computer systems of any of the *Land Registry*, the *ELNO* or the Reserve Bank of Australia are inoperative for any reason at the *completion time* agreed by the *parties*, a failure to complete this contract for that reason is not a default under this contract on the part of either *party*.
- 30.13 If the computer systems of the *Land Registry* are inoperative for any reason at the *completion time* agreed by the *parties*, and the *parties* choose that financial settlement is to occur despite this, then on financial settlement occurring –
- 30.13.1 all *electronic documents Digitally Signed* by the vendor, the *certificate of title* and any discharge of mortgage, withdrawal of caveat or other *electronic document* forming part of the *Lodgment Case* for the *electronic transaction* shall be taken to have been unconditionally and irrevocably delivered to the purchaser or the purchaser's mortgagee at the time of financial settlement together with the right to deal with the land comprised in the *certificate of title*; and
  - 30.13.2 the vendor shall be taken to have no legal or equitable interest in the *property*.
- 30.14 A *party* who holds a *certificate of title* must act in accordance with any *Prescribed Requirement* in relation to the *certificate of title* but if there is no *Prescribed Requirement*, the vendor must serve the *certificate of title* after completion.
- 30.15 If the *parties* do not agree about the delivery before completion of one or more documents or things that cannot be delivered through the *Electronic Workspace*, the *party* required to deliver the documents or things –
- 30.15.1 holds them on completion in escrow for the benefit of; and
  - 30.15.2 must immediately after completion deliver the documents or things to, or as directed by; the *party* entitled to them.
- 30.16 In this clause 30, these terms (in any form) mean –
- |                              |   |
|------------------------------|---|
| <i>adjustment figures</i>    | details of the adjustments to be made to the price under clause 14;   |
| <i>certificate of title</i>  | the paper duplicate of the folio of the register for the land which exists immediately prior to completion and, if more than one, refers to each such paper duplicate;  |
| <i>completion time</i>       | the time of day on the date for completion when the <i>electronic transaction</i> is to be settled;   |
| <i>conveyancing rules</i>    | the rules made under s12E of the Real Property Act 1900;  |
| <i>discharging mortgagee</i> | any discharging mortgagee, chargee, covenant chargee or caveator whose provision of a <i>Digitally Signed</i> discharge of mortgage, discharge of charge or withdrawal of caveat is required in order for unencumbered title to the <i>property</i> to be transferred to the purchaser; |
| <i>ECNL</i>                  | the Electronic Conveyancing National Law (NSW);   |
| <i>effective date</i>        | the date on which the <i>Conveyancing Transaction</i> is agreed to be an <i>electronic transaction</i> under clause 30.1.2 or, if clauses 30.1.1 or 30.1.3 apply, the contract date;  |
| <i>electronic document</i>   | a dealing as defined in the Real Property Act 1900 which may be created and <i>Digitally Signed</i> in an <i>Electronic Workspace</i> ;   |
| <i>electronic transfer</i>   | a transfer of land under the Real Property Act 1900 for the <i>property</i> to be prepared and <i>Digitally Signed</i> in the <i>Electronic Workspace</i> established for the purposes of the <i>parties' Conveyancing Transaction</i> ;  |

<i>electronic transaction</i>	a <i>Conveyancing Transaction</i> to be conducted for the <i>parties</i> by their legal representatives as <i>Subscribers</i> using an <i>ELN</i> and in accordance with the <i>ECNL</i> and the <i>participation rules</i> ;
<i>electronically tradeable</i>	a land title that is Electronically Tradeable as that term is defined in the <i>conveyancing rules</i> ;
<i>incoming mortgagee</i>	any mortgagee who is to provide finance to the purchaser on the security of the <i>property</i> and to enable the purchaser to pay the whole or part of the price;
<i>mortgagee details</i>	the details which a <i>party</i> to the <i>electronic transaction</i> must provide about any <i>discharging mortgagee</i> of the <i>property</i> as at completion;
<i>participation rules</i>	the participation rules as determined by the <i>ECNL</i> ;
<i>populate</i>	to complete data fields in the <i>Electronic Workspace</i> ; and
<i>title data</i>	the details of the title to the <i>property</i> made available to the <i>Electronic Workspace</i> by the <i>Land Registry</i> .

### 31 Foreign Resident Capital Gains Withholding

- 31.1 This clause applies only if –
- 31.1.1 the sale is not an excluded transaction within the meaning of s14-215 of Schedule 1 to the *TA Act*; and
- 31.1.2 a *clearance certificate* in respect of every vendor is not attached to this contract.
- 31.2 The purchaser must –
- 31.2.1 at least 5 days before the date for completion, serve evidence of submission of a purchaser payment notification to the Australian Taxation Office by the purchaser or, if a direction under clause 4.3 has been served, by the transferee named in the transfer served with that direction;
- 31.2.2 produce on completion a *settlement cheque* for the *FRCGW remittance* payable to the Deputy Commissioner of Taxation;
- 31.2.3 forward the *settlement cheque* to the payee immediately after completion; and
- 31.2.4 serve evidence of receipt of payment of the *FRCGW remittance*.
- 31.3 The vendor cannot refuse to complete if the purchaser complies with clauses 31.2.1 and 31.2.2.
- 31.4 If the vendor serves any *clearance certificate* or *variation*, the purchaser does not have to complete earlier than 7 days after that service and clause 21.3 does not apply to this provision.
- 31.5 If the vendor serves in respect of every vendor either a *clearance certificate* or a *variation* to 0.00 percent, clauses 31.2 and 31.3 do not apply.

### 32 Residential off the plan contract

- 32.1 This clause applies if this contract is an off the plan contract within the meaning of Division 10 of Part 4 of the Conveyancing Act 1919 (the Division).
- 32.2 No provision of this contract has the effect of excluding, modifying or restricting the operation of the Division.
- 32.3 If the purchaser makes a claim for compensation under the terms prescribed by clause 6A of the Conveyancing (Sale of Land) Regulation 2017 –
- 32.3.1 the purchaser cannot make a claim under this contract about the same subject matter, including a claim under clauses 6 or 7; and
- 32.3.2 the claim for compensation is not a claim under this contract.
- 32.4 This clause does not apply to a contract made before the commencement of the amendments to the Division under the Conveyancing Legislation Amendment Act 2018.

## SPECIAL CONDITIONS

### Conditions of sale of land by auction

---

If the property is or is intended to be sold at auction:

Bidders record means the bidders record to be kept pursuant to clause 13 of the *Property, Stock and Business Agents Regulation 2014* and section 68 of the *Property, Stock and Business Agents Act 2002*:

1. The following conditions are prescribed as applicable to and in respect of the sale by auction of land or livestock:
    - a) The vendor's reserve price must be given in writing to the auctioneer before the auction commences;
    - b) A bid for the vendor cannot be made unless the auctioneer has, before the commencement of the auction, announced clearly and precisely the number of bids that may be made by or on behalf of the vendor;
    - c) The highest bidder is the purchaser, subject to any reserve price;
    - d) In the event of a disputed bid, the auctioneer is the sole arbitrator and the auctioneer's decision is final;
    - e) The auctioneer may refuse to accept any bid that, in the auctioneer's opinion, is not in the best interests of the vendor;
    - f) A bidder is taken to be a principal unless before bidding, the bidder has given to the auctioneer a copy of a written authority to bid for or on behalf of another person;
    - g) A bid cannot be made or accepted after the fall of the hammer;
    - h) As soon as practicable after the fall of the hammer the purchaser is to sign the agreement (if any) for sale.
  2. The following conditions, in addition to those prescribed by subclause 1, are prescribed as applicable to and in respect of the sale by auction of residential property or rural land:
    - (a) All bidders must be registered in the bidders record and display an identifying number when making a bid;
-

- (b) Subject to subclause 3, the auctioneer may make only one vendor bid at an auction for the sale of residential property or rural land and no other vendor bid may be made by the auctioneer or any other person; and
  - (c) Immediately before making a vendor bid the auctioneer must announce that the bid is made on behalf seller or announce 'vendor bid'.
- 3. The following conditions, in addition to those prescribed by subclauses 1 and 2 are prescribed as applicable to and in respect of the sale by auction of co-owned residential property or rural land or the sale of such land by a seller as executor or administrator:
  - a) More than one vendor bid may be made to purchase interest of a co-owner;
  - b) A bid by or on behalf of an executor or administrator may be made to purchase in that capacity;
  - c) Before the commencement of the auction, the auctioneer must announce that bids to purchase the interest of another co-owner or to purchase as executor or administrator may be made by or on behalf of the seller;
  - d) Before the commencement of the auction, the auctioneer must announce the bidder registration number of any co-owner, executor or administrator or any person registered to bid on behalf of any co-owner, executor or administrator.

and: (*purchaser*)

## Real Estate Agents

## Notice to Complete

34.1 The vendor shall be at liberty at any time prior to the expiration of the Notice to withdraw the Notice without prejudice to their continuing right to give any further such notice.

35 Provided that the vendor is ready, willing and able to give title to the purchaser, if this contract is not completed for any reason (other than the vendor's default) on or before the Completion date as a result of the default of the purchaser, then: -

35.2 In addition to any other right which the vendor may have under this contract or otherwise the purchaser will on completion of this contract pay to the vendor interest on the balance of the purchase price at the rate of 10% per annum calculated on daily balances, commencing on the

Completion date and continuing until completion of this Contract. This interest is a genuine pre-estimate of liquidated damages and will be deemed to be part balance of purchase money due and payable on completion, and a further sum of \$330.00 (including GST) for the vendor's additional legal costs associated with the purchaser's failure to complete on time.

- 35.3 The liquidated damages payable under 35.2 are agreed by the parties to be a genuine pre-estimate of the vendor's actual damages.

### **Settlement Costs**

- 36 In the event the vendor is required by the purchaser to attend settlement at a place other than at the vendors Solicitors office or that of the vendors discharging Mortgagee or their agent/ the purchaser shall pay the vendors costs incurred by such attendance. The purchaser agrees the vendors costs noted at \$88.00

- 36.1 If the purchaser's representative, for whatsoever reason, falls to attend when arranged or cancels settlement on the completion date without giving the vendor's Solicitor notice of at least one (1) day, the purchaser will, at the actual settlement, pay to the vendor's Solicitor or representative the sum of \$88.00 (including GST) together with any of the vendor's agency fees incurred in respect of the said cancelled settlement.

### **Property sold in present condition**

- 37 The Purchaser acknowledges that in entering into this Contract he has relied upon his own enquiries relating to the property and on his own inspection of the property and the Purchaser further acknowledges that he accepts the property and all improvement thereon and any chattels or things included in this Contract in their present condition, subject to fair wear and tear.

### **Capacity**

- 38 Without in any way limiting, negating or restricting any rights or remedies which would have been available to either party at law or in equity had this clause not been included, if either party (and if more than one person comprises that first party then any one of them) prior to completion:

- 38.1 dies or becomes mentally ill, then the other party may rescind this contract by written notice to the first party's solicitor and thereupon this contract will be at an end and the provisions of clause 19 apply; or

38.2 being a company, has a summons or application for its winding up presented or has a liquidator, receiver or voluntary administrator of it appointed, or enters into any deed of company arrangement or scheme of arrangement with its creditors, then the first party will be in default under this contract.

### **Swimming Pool**

39 The purchaser cannot make any objection, requisition or claim or rescind or terminate if the swimming pool on the property does not comply with the requirements of the Swimming Pools Act 1992.

### **Reduced deposit**

40 The vendor agrees to accept the deposit of \$                      in lieu of the ten percent (10%) deposit only whilst the Purchaser continues to perform his obligations pursuant to the Contract for Sale. Immediately upon any default by the Purchaser the balance of the ten percent (10%) deposit will become payable and the Vendors rights pursuant to clause 9.1 hereof shall be to recover a deposit equivalent to ten percent (10%) of the purchase price.

### **41 Deposit Power Guarantee**

In the event that the Vendor agrees to accept a Deposit Power Guarantee the following Conditions shall apply: -

- (a) The delivery of the Guarantee no later than the time the deposit is required to be paid under this Contract to the "Deposit Holder" nominated in this Contract to hold the deposit as stakeholder shall, to the extent of the amount guaranteed under the Guarantee, be deemed to be payment of the deposit in accordance with this Contract.
- (b) On completion of this Contract, the Purchaser shall pay to the Vendor, in addition to all other monies payable under this Contract, the amount stipulated in the Guarantee, either by way of cash or unendorsed bank cheque.

### **42 Requisitions on Title**

The purchaser agrees that the only form of requisitions on title that the purchaser may make pursuant to clause 5 shall be those requisitions contained and annexed to this contract.

### **43 Exclusion of pre-contractual representations**

- (a) This contract constitutes the entire agreement between the Vendor and the Purchaser relating to the sale of the property. The parties have not entered into and are not bound by any collateral or other agreement, apart from this contract.



The parties are not bound by any warranty, representation, collateral agreement or implied term under the general law or imposed by legislation unless:

- i. such warranty, representation, agreement or term is contained in the express terms of this contract; or
  - ii. it is an implied term or warranty imposed by statute which is mandatory and cannot be excluded by the parties' agreement.
- (b) The Purchaser acknowledges that the Purchaser, when entering into this contract relied exclusively on the following matters independently of any statements, inducements or representations made by or on behalf of the Vendor (including by any estate agent acting on behalf Vendor):
- i. the inspection of and investigations relating to the land made by or on behalf of the Purchaser;
  - ii. the warranties and representations expressly contained in this contract;
  - iii. the skill and judgment of the Purchaser, its consultants and representatives; and
  - iv. opinions or advice obtained by the Purchaser independently of the Vendor or of the Vendor's agents or employees.

#### 44 **Inspections by the purchaser**

- (a) The Purchaser acknowledges that the Vendor:
- i. is exercising power of sale under the *Local Government Act 1993*;
  - ii. has never occupied the property; and
  - iii. does not have any direct knowledge of the property.
- (b) The Purchaser has inspected the property or been given the opportunity to inspect the property and is satisfied regarding all defects both latent and patent.
- (c) The Purchaser acknowledges that in entering into this contract, the Purchaser:
- i. does not rely on any representations, inducements or warranties made by the Vendor or its agents or representatives, except those expressly set out in this contract;
  - ii. has relied entirely on the Purchaser's enquiries relating to the property;
  - iii. accepts the property in its present state of repair or condition including, but not limited to, its suitability for the purposes of the Purchaser, the improvements erected on the property, any contamination relating to, caused by, or affecting the property or any proposed work to be done to the property;
  - iv. accepts the property subject to the encumbrances disclosed in the contract, except for any encumbrances to be discharged on completion; and
  - v. cannot require the Vendor either before or after completion to repair or replace any defect or damage to the property existing as at the date of this contract or to comply with or pay for any costs arising from any

*work order*, including any *work order* issued before the date of this contract.

- (d) The Purchaser accepts the property subject to the disclosures contained in this clause and must not make any objection, requisition or claim for compensation or rescind or terminate this contract or delay completion because of any matter arising either directly or indirectly from the matters disclosed or referred to in this clause.

#### 45 **Acknowledgment of non-compliance**

- (a) The Vendor discloses that it is not aware whether the improvements comply with all relevant legislation.
- (b) The Vendor discloses that it is not aware whether there is any encroachment by or on the property.
- (c) The Purchaser must make its own enquiries and satisfy itself regarding all aspects disclosed in this clause and the Purchaser accepts the property subject to the disclosures contained in this clause and must not make any objection, requisition or claim for compensation or rescind or terminate this contract or delay completion because of any matter arising either directly or indirectly from the matters disclosed in this clause.

#### 46 **Furnishing, fittings and property**

- (a) The subject matter of this sale is land and fixtures only and does not include any furnishings, fittings, good or personalty on the property. The Purchaser must not require the Vendor to remove any furnishings, fittings, goods, rubbish or personalty at any time. The Purchaser must not make any objection, requisition or claim for compensation nor delay completion because there are any such furnishings, fittings, goods, personalty or rubbish on the property on completion or which remain there after completion.
- (b) The Purchaser acknowledges that the Vendor will not prior to completion:
  - i. mow any lawns or remove any garden refuse and other rubbish from the property;
  - ii. if any services to the property are disconnected, do anything or pay any amounts for the reconnection of those services; and
  - iii. provide any keys or remote-control devices which may be missing for any lock/door/window on the property.

#### 47 **Smoke alarms**

- (a) The Vendor does not warrant that any building erected on the land complies with the *Environmental Planning and Assessment Regulation 2000* (NSW)

(Regulation) which requires the installation of smoke alarms or heat alarms in certain buildings or parts of buildings,

- (b) The Purchaser must make its own enquiries as to whether any building erected on the property complies with the Regulation and accepts the property and must complete the contract whether or not the Regulation has been complied with.
- (c) The Purchaser must not make any objection, requisition or claim for compensation or seek to delay completion, rescind or terminate this contract because of any matter disclosed in this clause.

#### 48 **Council exercising power of sale**

- (a) If any proceedings to set aside this contract or restrain completion of it are commenced in any court of competent jurisdiction or if any order is made setting aside this contract or restraining completion of it, the Vendor may by written notice to the Purchaser rescind this contract and the provisions of clause 19 will apply. The Vendor's decision will be final and binding on the Purchaser.
- (b) If the Vendor exercising power of sale decides it is prevented from completing this contract by the completion date for any reason (and the Vendor's decision will be final and binding on the Purchaser), the Vendor may by written notice to the Purchaser rescind this contract and the provisions of clause 19 will apply.
- (c) Despite anything else contained in this contract, the Purchaser agrees that if the Vendor is restricted or prohibited through any means in giving title in accordance with this contract by the completion date, then the completion date may be extended at any time including without limitation after the completion date (by the Vendor giving written notice), for such period of time as the Vendor may reasonably require in all of the circumstances to give title to the Purchaser. However, if the Vendor is not able to deliver title and effect completion within 4 months of the date of this contract, then either party may rescind this contract by notice in writing to the other and clause 19 will apply.
- (d) The Purchaser acknowledges and agrees that any rescission of this contract by the Vendor pursuant to this clause:
  - i. will not be a breach of this contract; and
  - ii. the Purchaser waives any rights it may have to claim for damages, costs or expenses arising directly or indirectly from any rescission of this contract by the Vendor pursuant to this clause.

#### 49 **Caveats and writs**

- (a) The Vendor discloses that under the *Local Government Act 1993* and specifically section 723 thereof:

- i. the Vendor is not required to provide to the Purchaser a withdrawal of any caveat which is registered on the title to the property;
  - ii. the Vendor is not required to provide a cancellation of any writ which is registered on the title to the property;
  - iii. the Vendor is not required to provide a Discharge of any Mortgage or other charge registered on the title to the property.
- (b) The Purchaser must not make any objection, requisition or claim for compensation or rescind or terminate this contract or delay completion because of the matters disclosed in this clause.

## 50 **Environmental liability**

- (a) **No Vendor's Warranty** — No representation or warranty is given by the Vendor in relation to:
- i. any Activity on or before completion;
  - ii. the existence or extent of Contamination emanating from, on, in, under or over the or any Affected Land;
  - iii. the status of compliance with any Environmental Law applicable (now or after completion) to the property or any Affected Land;
  - iv. Liabilities for any Activity or Contamination on or before completion with respect to the property or Affected Land; or
  - v. the extent to which the property or Affected Land is the subject of or cause of harm to the Environment.
- (b) **Purchaser relies on own enquiries** — The Purchaser relies on its own inspections and enquiries and has, to the extent required, effected tests to satisfy itself in relation to all issues relating to the Environment.
- (c) **Environmental Laws** includes any Law relating to any aspect of the Environment;
- (d) **Law** includes any law (including common and criminal laws) directive, Act of Parliament, statute, enactment, legislation, order, ordinance, regulation, rule, by-law, proclamation, notice, Authority approval, statutory instrument, proclamation or delegated or subordinate legislation of the Commonwealth or of any State or Territory of Australia or any Municipal Government or of any Authority; and
- (e) **Liability** or **Liabilities** means all threatened or actual actions, proceedings, demands, notices, costs and expenses (investigation costs, clean-up costs, rehabilitation costs, remediation costs and all legal and consultants expenses incurred), loss or damage.

## 51 **Amendment by solicitor**

Each party hereto authorises his, her or their solicitor or any employee of that solicitor up until the date of this contract to make alterations to this contract including the addition of annexures after execution up until the date of this contract and any such alterations shall be binding upon the party deemed hereby to have authorised the same

and any annexure so added shall form part of this contract as if the same was annexed prior to the contract being executed.

## 52 **Completion**

Completion of this contract shall take place on or before the due date for completion specified on the front page of this contract PROVIDED THAT if completion does not take place as aforesaid:

- (a) either party may give to the other a written notice requiring completion of this contract to take place at the expiration of fourteen (14) days after receipt of such notice and in this regard the time nominated for completion shall be deemed to be of the essence of this agreement. A notice to complete of such duration is considered by the parties to be reasonable and sufficient to render the time for completion essential.

The said notice shall be deemed to have been received by the other party forty-eight (48) hours after the same shall have been posted by prepaid post to such party at the address shown or forwarded through the services of the Australian Document Exchange Pty Limited to the delivery box of the solicitor for the respective party; and

- (b) if the Purchaser shall not complete this purchase by the completion date, without default by the Vendor, the Purchaser shall pay to the Vendor on completion, in addition to the balance of purchase money, an amount calculated as interest on the balance of purchase money at the rate of 10% per annum, computed at a daily rate from the day immediately after the completion date to the day on which this sale shall be completed. It is agreed that this amount is a genuine pre-estimate of the Vendor's loss of interest for the purchase money and liability for rates and outgoings.

## 53 **Company**

If the Purchaser is a company then that person or those persons who have signed this agreement either as Directors of the Purchaser company or on behalf of the Purchaser company or as separate guarantors hereby acknowledge that the Vendor has entered into this contract only on the basis that the Director(s) or other person(s) who have signed this contract do hereby themselves personally guarantee the Purchaser's performance of this contract. In consideration of the Vendor entering into this contract, such person or persons as have affixed their signatures to this contract as guarantors or as a Director or a Secretary or for and on behalf of the Purchaser company, do hereby in their own right guarantee to the Vendor the performance and observance by the Purchaser of all terms, conditions and provisions contained in this contract and on the part of the Purchaser to be performed and observed. It is agreed that this guarantee shall not be affected or vitiated in any way by any time or other indulgence given by the Vendor to the Purchaser. It is further agreed that this guarantee shall bind the said person or persons, their executors, administrators and

assigns jointly and each of them severally and the contents of this clause shall not merge on completion.

**54 Utility services**

- (a) With the exception of any drainage and/or sewer location diagram annexed to the Contract, the Vendor discloses, and the Purchaser acknowledges that the Vendor has no knowledge of the services for electricity, gas, stormwater, sewer and telecommunications (“Utility Services”) currently servicing the property.
- (b) The Purchaser shall not make any objection, requisition or claim for compensation in respect to the existence or location of Utility Services.

**55 Sale Price less than \$10,000.00**

Should the sale price of the land be less than or equal to \$10,000.00, the Purchaser agrees to pay the full sale price as a deposit in lieu of the 10% deposit on the day of the auction, and contracts will be exchanged on this same day. The deposit will be held by the nominated real estate agent until the calculations of rates and charges owing to the date of the settlement are finalised.

**56 Amendments to Clause 17**

Clause 17.1 be deleted and replaced with:

Vacant possession is the responsibility of the purchaser. Vendor is not required to give vacant possession on completion.

Clause 17.2 be amended as follows:

17.2 The vendor does not have to give vacant possession if –

- 17.2.1 this contract says that the sale is subject to existing tenancies; and
- 17.2.2 this contract is not required to disclose the provisions of tenancy (for example, by attaching a copy of the lease and any relevant memorandum or variation)

Clause 17.3 be amended as follows:

The purchaser is to exercise due diligence and carry out any searches and or inspections, at their expense, to ensure it meets with their requirements prior to auction. The purchaser cannot claim compensation (before or after completion) from the vendor or *rescind* if any of the land affected by a protected tenancy (a tenancy affected by Part 2, 3, 4 or 5 *Landlord and Tenant (Amendment) Act 1948*). The purchaser can commence proceedings at their own expense to obtain vacant possession affected by any protected or unknown tenancies or squatters.

## NSW LRS - Title Search

NEW SOUTH WALES LAND REGISTRY SERVICES - TITLE SEARCH  
-----FOLIO: 27/755795  
-----

SEARCH DATE	TIME	EDITION NO	DATE
-----	----	-----	-----
5/5/2021	3:10 PM	-	-

VOL 58 FOL 79 IS THE CURRENT CERTIFICATE OF TITLE

LAND  
-----LOT 27 IN DEPOSITED PLAN 755795  
LOCAL GOVERNMENT AREA LITHGOW CITY  
PARISH OF TURON COUNTY OF ROXBURGH  
(FORMERLY KNOWN AS PORTION 27)  
TITLE DIAGRAM CROWN PLAN 522.1496FIRST SCHEDULE  
-----

WILLIAM TACKE

(T 267798)

SECOND SCHEDULE (1 NOTIFICATION)  
-----

1 RESERVATIONS AND CONDITIONS IN THE CROWN GRANT(S)

NOTATIONS  
-----

UNREGISTERED DEALINGS: NIL

\*\*\* END OF SEARCH \*\*\*

PRINTED ON 5/5/2021

© Office of the Registrar-General 2021

SAI Global Property Division an approved NSW Information Broker hereby certifies that the information contained in this document has been provided electronically by the Registrar General in accordance with section 96B(2) of the Real Property Act 1900.



## **CERTIFICATE ORDER SUMMARY**

### **Transaction Details**

Date: 23/07/2021 12:58

Order No. 69389705

Certificate No: 105359782

Your Reference: 104348 contract

Certificate Ordered: NSW LRS - Copy of Plan or Plan Documents - Crown Plan 522-1496

Available: Y

Size (KB): 190

Number of Pages: 1

Scan Date and Time: 24/11/2012 01:56

© Office of the Registrar-General 2021

Dye & Durham Property Pty Ltd an approved NSW Information Broker hereby certifies that the information contained in this document has been provided electronically by the Registrar General in accordance with section 96B(2) of the Real Property Act 1900.

49/12  
64

Bathurst

Turon  
Plan of 1038 Co: Roxburgh Parish ~~Dutree~~ half a mile from the Junction  
of Palmers Oaky Creek with the Turon applied for under 8 Clause by H. Simpson

Scale 4 chs to an Inch

Note :- For connection  $\frac{1}{2}$ , see R. 530a. 1496. roll  
For additions  $\frac{1}{2}$  in red. see 65. 20518 in S.B. 9. 4199.

Name of Parish altered

9/10/64

From Turon R. 5. 17° 30' W. 6. 92  
from Southern Cor. of R. 26

Under reference  
Anno 1864  
measured plan of  
boundary between  
connection in  
made (?)

R 522-1496

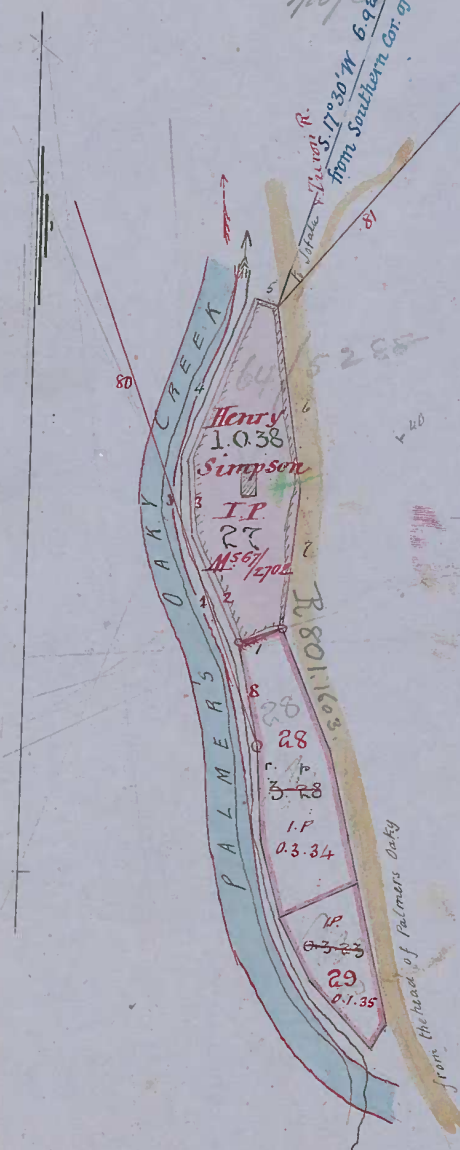

TRAVERSE

1	E 18° N	2.00
2	N 23.30° W	2.60
3	N 1.15° W	1.55
4	N 20.00° E	3.30
5	E 16° 05'	.50
6	S 0° E	4.00
7	S 4.50° W	3.09
8	N 18° 25' W	2.37
80	N 19° W	24.00
81	N 40° E	4.00

PLAN MICROFILMED  
NO ADDITIONS OR AMENDMENTS TO BE MADE

TRACED FOR D. S. O.

The Traverse Points are marked with split stakes  
No trees near. Circumferentor used. Fair garden land

Transmitted to the Acting Surveyor with

my letter No 54 dated 13 April 1864

Wm. B. B. B.

522-1496

Area of 20 Catalpa  
noted in report on Parish  
Catalpa  
Schedule for  
17/10/64

64-750  
sup

Lithgow City Council  
Po Box 19  
LITHGOW NSW 2790



## **PLANNING CERTIFICATE UNDER SECTION 10.7, ENVIRONMENTAL PLANNING AND ASSESSMENT ACT, 1979**

**CERTIFICATE NO: PLANC5-20-0231**

**YOUR REF:** Council sale of land  
**RECEIPT NO:**

**PROPERTY NO:** 104348  
**ISSUE DATE:** 01/07/2021

**PROPERTY ADDRESS:** Palmers Oakey Road PALMERS OAKEY NSW 2790  
**OWNER:** Mr W Tacke

**LAND PARCEL DESCRIPTIONS:** Lot 27 DP 755795

**IN ACCORDANCE WITH SECTION 10.7(2) OF THE ENVIRONMENTAL PLANNING AND ASSESSMENT ACT, 1979, IT IS CERTIFIED THAT AT THE DATE OF THIS CERTIFICATE THE FOLLOWING PRESCRIBED MATTERS RELATE TO THE LAND:**

### **1. Names of relevant planning instruments and DCPs**

- (1) The name of each planning instrument that applies to the carrying out of development on the land:**

LITHGOW LOCAL ENVIRONMENTAL PLAN 2014 (LEP)

RU2 Rural Landscape

**Further, the following State Environmental Planning Policies apply to the land:**

State Environmental Planning Policy (Affordable Rental Housing) 2009

State Environmental Planning Policy (Building Sustainability Index: BASIX) 2004

State Environmental Planning Policy (Concurrences and Consents) 2018

State Environmental Planning Policy (Educational Establishments and Child Care Facilities) 2017

State Environmental Planning Policy (Exempt and Complying Development Codes) 2008

State Environmental Planning Policy (Housing for Seniors or People with a Disability) 2004

State Environmental Planning Policy (Infrastructure) 2007



State Environmental Planning Policy (Koala Habitat Protection) 2020

State Environmental Planning Policy (Mining, Petroleum Production and Extractive Industries) 2007

State Environmental Planning Policy No 21 – Caravan Parks

State Environmental Planning Policy No 33 – Hazardous and Offensive Development

State Environmental Planning Policy No 36 – Manufactured Homes Estates

State Environmental Planning Policy No 50 – Canal Estate Development

State Environmental Planning Policy No 55 – Remediation of Land

State Environmental Planning Policy No 64 – Advertising and Signage

State Environmental Planning Policy No 65 – Design Quality of Residential Apartment Development

State Environmental Planning Policy No 70 – Affordable Housing (Revised Schemes)

State Environmental Planning Policy (Primary Production and Rural Development) 2019

State Environmental Planning Policy (State and Regional Development) 2011

State Environmental Planning Policy (State Significant Precincts) 2005

State Environmental Planning Policy (Vegetation in Non-Rural Areas) 2017

A copy of the SEPPs are available on the NSW Legislation website- [www.legislation.nsw.gov.au](http://www.legislation.nsw.gov.au)

**(2) The name of each proposed planning instrument that will apply to the carrying out of development on the land and that is or has been the subject of community consultation or on public exhibition under the Act (unless the Director- General has notified the council that the making of the proposed instrument has been deferred indefinitely or has not been approved):**

The following draft State Environmental Planning Policies apply to the land:

- Draft Design and Place SEPP
- Draft Environment SEPP
- Draft Housing Diversity SEPP
- Draft Remediation of Land SEPP
- Draft Short Term Accommodation SEPP

A copy of the draft SEPPs are available on the NSW Planning Portal website at <https://www.planningportal.nsw.gov.au/draftplans>

**(3) The name of each development control plan that applies to the carrying out on development on the land:**

Nil.

**Note:** All previous Lithgow City Council development control plans have been repealed and are currently under review. A new comprehensive development control plan for the Lithgow City Council area is expected to be considered by Council in 2021-2022.

**(4) Any proposed environmental planning instrument including a planning proposal for a LEP or a draft environmental planning instrument:**

Nil.

**2. Zoning and land use under relevant LEPs**

**(a) Identify the zone:**

RU2 RURAL LANDSCAPE

**(b) Development that may be carried out within the zone without the need for development consent:**

Extensive agriculture; Home occupations; Roads;

**(c) Development that may not be carried out within the zone except with development consent:**

Agricultural produce industries; Animal boarding or training establishments; Aquaculture; Bed and breakfast accommodation; Boat launching ramps; Boat sheds; Building identification signs; Business identification signs; Camping grounds; Cemeteries; Community facilities; Dual occupancies; Dwelling houses; Eco-tourist facilities; Environmental facilities; Environmental protection works; Farm buildings; Farm stay accommodation; Flood mitigation works; Forestry; Helipads; Home-based child care; Home businesses; Home industries; Information and education facilities; Jetties; Markets; Plant nurseries; Recreation areas; Roadside stalls; Secondary dwellings; Water recreation structures; Water supply systems

**(d) Development that is prohibited within the zone:**

Any development not specified in item (b) or (c).

**(e) Whether any development standards applying to the land fix minimum land dimensions for the erection of a dwelling- house on the land and, if so, the minimum land dimensions so fixed:**

40ha as per the Lot Size Map for Lithgow Local Environmental Plan 2014.

- Note:**
1. For zones R1 General Residential and R2 Low Density Residential, no minimum land size applies for a 'dwelling-house' and the above land size applies to the minimum lot size for the purpose of a Torrens Title subdivision or additional dwellings in relation to Clause 4.1A of LEP2014.
  2. A 'dwelling-house' may be permissible if it does not meet the minimum lot size for zones RU1, RU2, E3, E4, RU5 and R5 if it can comply with Clause 4.2A or 4.2B of LEP2014. A search in this regard may be sought separately from Council.

3. The above minimum land size is as per the 'Lot Size Map' for the purpose of a subdivision (Clause 4.1 of LEP2014) and does not necessarily state that a 'dwelling-house' is permissible in that particular zoning.

**(f) Whether the land includes or comprises of critical habitat:**

No.

**(g) Whether the land is in a conservation area (however described):**

No.

**(h) Whether an item of environmental heritage (however described) is situated on the land:**

No.

**2A. Zoning and land use under *State Environmental Planning Policy (Sydney Region Growth Centres) 2006***

**Is the land zoned under Part 3 of the *State Environmental Planning Policy (Sydney Region Growth Centres) 2006 (SEPP 2006)*, or a Precinct Plan (within the meaning of SEPP 2006), or a proposed Precinct Plan that is or has been the subject of community consultation or on public consultation?**

No.

**3. Complying Development**

**(1) Whether or not the land is land on which complying development may be carried out under each of the codes for complying development because of the provisions of clauses 1.17A (1) (c) to (e), (2), (3) and (4), 1.18 (1) (c3) and 1.19 of *State Environmental Planning Policy (Exempt and Complying Development Codes) 2008*:**

YES - Some developments may constitute Complying Development provided they comply with the provisions of the *State Environmental Planning Policy (Exempt and Complying Development Codes) 2008*.

**(2) If complying development may not be carried out on that land because of the provisions of clause 1.17A (1) (c) to (e), (2), (3) and (4), 1.18 (1) (c3) and 1.19 of that Policy, the reasons why it may not be carried out under that clause:**

N/A.

**Note:** The above responses apply only to the land exemptions for Exempt and Complying Development set out in clauses 1.17A (1) (c) to (e), (2), (3) and (4), 1.18 (1) (c3) and 1.19 of the *State Environmental Planning Policy (Exempt and Complying Development Codes) 2008*. Other clauses within the *State Environmental Planning Policy (Exempt and Complying Development Codes) 2008* may prohibit complying development from occurring on the subject land.

**4B. Annual charges under *Local Government Act 1993* for coastal protection services that relate to existing coastal protection works**

Not applicable to Lithgow City Council Local Government Area.

## **5. Mine Subsidence**

**Whether or not the land is proclaimed to be a mine subsidence district within the meaning of the *Coal Mine Subsidence Compensation Act 2017*.**

No.

## **6. Road widening and road realignment**

**Whether or not the land affected by any road widening or road realignment under:**

- a) Division 2 of Part 3 of the *Roads Act 1993*, or**
- b) any environmental planning instrument, or**
- c) any resolution of council:**

The property fronts a Council managed road. No widening or realignment is proposed by Council for this road as at the date of this certificate.

## **7. Council and other public authority policies on hazard risk restrictions**

**Whether land is affected by a policy:**

- a) adopted by council, or**
- b) adopted by another public authority and notified to council for the express purpose of its adoption by that authority being referred to in planning certificates issued by the council,**

**that restricts the development of the land because of the likelihood of landslip, tidal inundation, subsidence, acid sulphate soils or any other risk (other than flooding):**

No.

## **7A. Flood related development controls information**

- (1) Whether or not development on the land or part of the land for the purpose of dwelling houses, dual occupancies, multi dwelling housing or residential flat buildings (not including development for the purpose of group homes or seniors housing) is subject to flood related development controls:**

No. The Council does not hold any recent flood study or definitive flood level data relating to the land subject to this certificate.

- (2) Whether or not development on that land or part of the land for any other purpose is subject to flood related development controls:**

No. The Council does not hold any recent flood study or definitive flood level data relating to the land subject to this certificate.

## **8. Land reserved for acquisition**

**Whether or not any environmental planning instrument or proposed environmental planning instrument referred to in clause 1 makes provisions in relation to the acquisition of the land by a public authority, as referred to in section 27 of the Act:**

No.

## 9. Contributions Plans

**The name of each contributions plan applying to the land:**

Lithgow Section 94A (Section 7.12) Development Contributions Plan 2015 applies to this land.

## 9A. Biodiversity Certified Land

**If the land is biodiversity certified land (within the meaning of Part 5 of the *Biodiversity Conservation Act 2016*)** Note: Biodiversity certified land includes land certified under Part 7AA of the *Threatened Species Conservation Act 1995* that is taken to be certified under Part 8 of the *Biodiversity Conservation Act 2016*:

No.

## 10. Biodiversity stewardship sites

**If the land is a biodiversity stewardship site under a biodiversity stewardship agreement under Part 5 of the *Biodiversity Conservation Act 2016* (but only if the Council has been notified of the existence of the agreement by the Chief Executive of the office of Environment & Heritage).** Note: Biodiversity stewardship agreements include biobanking agreements under Part 7A of the *Threatened Species Conservation Act 1995* that is taken to be biodiversity stewardship agreements under Part 5 of the *Biodiversity Conservation Act 2016*:

No.

## 10A. Native vegetation clearing set asides

**If the land contains a set aside area under section 60ZC of the *Local Land Services Act 2013* (but only if the council has been notified of the existence of the set aside area by Local Land Services or it is registered in the public register under that section):**

No.

## 11. Bush Fire Prone Land

**If any of the land is bush fire prone land (as defined in the Act):**

Yes - The land is entirely bushfire prone as identified on Council's adopted bushfire mapping.

## 12. Property Vegetation Plans

**If the land is land to which a property vegetation plan under *The Native Vegetation Act 2003* (and that continues in force) applies (but only if Council has been notified of the existence of the plan by the person or body that approved the plan under that Act):**

No.

## 13. Orders under *Trees (Disputes Between Neighbours) Act 2006*

**Whether an order has been made under the *Trees (Disputes Between Neighbours) Act 2006* to carry out work in relation to a tree on the land (but only if the Council has been notified of the order):**

No.



**14. Directions under Part 3A**

**Is there a direction by the Minister in force under Section 75P (2) (c1) of the Act that a provision of an environmental planning instrument prohibiting or restricting the carrying out of a project or a stage of a project on the land under Part 4 of the Act does not have effect:**

No.

**15. Site compatibility certificates and conditions for seniors housing**

**If the land is land to which *State Environmental Planning policy (Housing for Seniors or People with a Disability) 2004* applies:**

No.

**16. Site compatibility certificates for infrastructure, schools or TAFE establishments**

**If the land has a valid site compatibility certificate (infrastructure or site compatibility certificate (schools or TAFE establishment):**

No.

**17. Site compatibility certificates and conditions for affordable rental housing**

**If the land is land to which a site compatibility certificate was issued under *State Environmental Planning Policy (Affordable Rental Housing)* :**

No.

**18. Is there any development plan adopted by a relevant authority regarding paper subdivisions that apply to this land?**

No.

**19. Is there a current site verification certificate of which Council is aware, in respect of the land? If there is, what are the particulars of the certificate?**

No.

**20. The following matters are prescribed by *Environmental Planning and Assessment Amendment (Loose-fill Asbestos Insulation) Regulation 2016* as additional matters to be specified in a planning certificate:**

**Is the property listed on the NSW Fair Trading Loose-Fill Asbestos Insulation Public Register?**

No.

## **21. Affected Building notices and building product rectification orders**

**Is Council aware of any affected building notice, building product rectification order or notice of intention to make a building product rectification order that is in force in respect of the land, as per the *Building Products (Safety) Act 2017*?**

No.

### **NOTE:**

**The following matters are prescribed by section 59 (2) of the *Contaminated Land Management Act 1997* as additional matters to be specified in a planning certificate:**

**a) Is the land significantly contaminated land within the meaning of the *Contaminated Land Management Act 1997*— or is the land (or part of the land) significantly contaminated land at the date when the certificate is issued?**

No.

**b) Is the land subject to a management order within the meaning of the *Contaminated Land Management Act 1997*— or is the land subject to such an order at the date when the certificate is issued?**

No.

**c) Is the land subject of an approved voluntary management proposal within the meaning of *Contaminated Land Management Act 1997*— or is the land subject to such an order at the date when the certificate is issued?**

No.

**d) Is the land to subject to an ongoing maintenance order within the meaning of *Contaminated Land Management Act 1997*— or is the land subject to such an order at the date when the certificate is issued?**

No.

- e) Is the land to subject of a site audit statement within the meaning of **Contaminated Land Management Act 1997**— or has a copy of such a statement been provided to council?

No.

---

  
\_\_\_\_\_  
for the GENERAL MANAGER  
LITHGOW CITY COUNCIL

For any further information, please contact the Environment & Development Department on (02) 63549999.

DISCLAIMER

THIS SECTION 10.7 CERTIFICATE CONTAINS INFORMATION PROVIDED TO LITHGOW CITY COUNCIL BY OTHER AUTHORITIES AND IS AS CURRENT AS THE LATEST INFORMATION AVAILABLE TO COUNCIL AT THE TIME OF PRODUCTION OF THIS DOCUMENT. IT IS STRONGLY RECOMMENDED THAT YOU CONTACT THE RELEVANT AUTHORITIES TO CONFIRM THE ACCURACY OF THE INFORMATION.

## **SECTION 10.7(5) ADVICE**

<b>(a) Has any development consent with respect to the land been granted within the previous five years?</b>	<b>NO</b>
<b>(b) Additional information</b>	<p>Threatened species and Endangered Ecological Communities currently exist within the Lithgow Local Government Area. Information on species reported and their localities can be found on the NSW Office of Environment and Heritage website below: <a href="http://www.environment.nsw.gov.au/wildlifeatlas/about.htm">http://www.environment.nsw.gov.au/wildlifeatlas/about.htm</a></p>
	<p><b>Information regarding loose-fill asbestos insulation</b> Some residential homes located in the Lithgow Local Government Area have been identified as containing loose-fill asbestos insulation, for example in the roof space. NSW Fair Trading maintains a Register of homes that are affected by loose-fill asbestos insulation. You should make your own enquiries as to the age of the buildings on the land to which this certificate relates and, if it contains a building constructed prior to 1980, Council strongly recommends that any potential purchaser obtain advice from a licensed asbestos assessor to determine whether loose-fill asbestos is present in any building on the land and, if so, the health risks (if any) this may pose for the building's occupants. Please contact NSW Fair Trading for further information.</p>

Council Sale of Land  
Property No: 104348  
Customer Services



Lithgow City Council  
Po Box 19  
LITHGOW NSW 2790

## APPLICATION FOR DRAINAGE DIAGRAM

**APPLICATION NO: DD-20-0486**

OWNER: Mr W Tacke  
PROPERTY: Palmers Oakey Road PALMERS OAKEY NSW 2790  
Lot 27 DP 755795

**DRAINAGE DIAGRAM: NIL**

Perusal of Council's records reveals that the sewer is unavailable at this location and consequently, the above premises is not connected to Council's sewer.

For any further information, please contact Customer Services Division, telephone (02) 63549999.

  
for Craig Butler  
GENERAL MANAGER  
09/07/2021

DISCLAIMER-THIS CERTIFICATE CONTAINS INFORMATION PROVIDED TO LITHGOW CITY COUNCIL BY OTHER AUTHORITIES AND IS AS CURRENT AS THE LATEST INFORMATION AVAILABLE TO COUNCIL AT THE TIME OF PRODUCTION OF THIS DOCUMENT. IT IS STRONGLY RECOMMENDED THAT YOU CONTACT THE RELEVANT AUTHORITIES TO CONFIRM THE ACCURACY OF THE INFORMATION.

## RESIDENTIAL PROPERTY REQUISITIONS ON TITLE

Vendor: **LITHGOW CITY COUNCIL ABN 59 986 092 492**  
Purchaser:  
Property: **PALMERS OAKEY ROAD, PALMERS OAKEY NSW 2790**  
Dated: 26 July 2021

---

### Possession and tenancies

1. Vacant possession of the property must be given on completion unless the Contract provides otherwise.
2. Is anyone in adverse possession of the property or any part of it?
3.
  - (a) What are the nature and provisions of any tenancy or occupancy?
  - (b) If they are in writing, all relevant documentation should be produced, found in order and handed over on completion with notices of attornment.
  - (c) Please specify any existing breaches.
  - (d) All rent should be paid up to or beyond the date of completion.
  - (e) Please provide details of any bond together with the Rental Bond Board's reference number.
  - (f) If any bond money is held by the Rental Bond Board, the appropriate transfer documentation duly signed should be handed over on completion.
4. Is the property affected by a protected tenancy? (A tenancy affected by Parts 2, 3, 4 or 5 of the *Landlord and Tenant (Amendment) Act 1948*.)
5. If the tenancy is subject to the *Residential Tenancies Act 2010 (NSW)*:
  - (a) has either the vendor or any predecessor or the tenant applied to the Consumer, Trader and Tenancy Tribunal for an order?
  - (b) have any orders been made by the Consumer, Trader and Tenancy Tribunal? If so, please provide details.

### Title

6. Subject to the Contract, on completion the vendor should be registered as proprietor in fee simple of the property free from all encumbrances.
7. On or before completion, any mortgage or caveat or writ must be discharged, withdrawn or cancelled as the case may be) or, in the case of a mortgage or caveat, an executed discharge or withdrawal handed over on completion.
8. Are there any proceedings pending or concluded that could result in the recording of any writ on the title to the property or in the General Register of Deeds? If so, full details should be provided at least 14 days prior to completion.
9. When and where may the title documents be inspected?
10. Are the inclusions or fixtures subject to any charge or hiring agreement? If so, details must be given and any indebtedness discharged prior to completion or title transferred unencumbered to the vendor prior to completion.

### Adjustments

11. All outgoings referred to in clause 14.1 of the Contract must be paid up to and including the date of completion.
12. Is the vendor liable to pay land tax or is the property otherwise charged or liable to be charged with land tax? If so:
  - (a) to what year has a return been made?
  - (b) what is the taxable value of the property for land tax purposes for the current year?

### Survey and building

13. Subject to the Contract, survey should be satisfactory and show that the whole of the property is available and that there are no encroachments by or upon the property and that all improvements comply with local government/planning legislation.
14. Is the vendor in possession of a survey report? If so, please produce a copy for inspection prior to completion. The original should be handed over on completion.
15.
  - (a) Have the provisions of the Local Government Act, the Environmental Planning and

*Assessment Act 1979* and their regulations been complied with?

- (b) Is there any matter that could justify the making of an upgrading or demolition order in respect of any building or structure?
  - (c) Has the vendor a Building Certificate which relates to all current buildings or structures? If so, it should be handed over on completion. Please provide a copy in advance.
  - (d) Has the vendor a Final Occupation Certificate issued under the *Environmental Planning and Assessment Act 1979* for all current buildings or structures? If so, it should be handed over on completion. Please provide a copy in advance.
  - (e) In respect of any residential building work carried out in the last 7 years:
    - (i) please identify the building work carried out;
    - (ii) when was the building work completed?
    - (iii) please state the builder's name and licence number;
    - (iv) please provide details of insurance under the *Home Building Act 1989*.
16. Has the vendor (or any predecessor) entered into any agreement with or granted any indemnity to the Council or any other authority concerning any development on the property?
17. If a swimming pool is included in the property:
- (a) when did construction of the swimming pool commence?
  - (b) is the swimming pool surrounded by a barrier which complies with the requirements of the *Swimming Pools Act 1992*?
  - (c) if the swimming pool has been approved under the *Local Government Act 1993*, please provide details.
  - (d) are there any outstanding notices or orders?
- 18.
- (a) To whom do the boundary fences belong?
  - (b) Are there any party walls?
  - (c) If the answer to Requisition (b) is yes, specify what rights exist in relation to each party wall and produce any agreement. The benefit of any such agreement should be assigned to the purchaser on completion.
  - (d) Is the vendor aware of any dispute regarding boundary or dividing fences or party walls?
  - (e) Has the vendor received any notice, claim or proceedings under the *Dividing Fences Act 1991* or the *Encroachment of Buildings Act 1922*?

### **Affectations**

19. Is the vendor aware of any rights, licences, easements, covenants or restrictions as to use other than those disclosed in the Contract?
20. Is the vendor aware of:
- (a) any road, drain, sewer or storm water channel which intersects or runs through the land?
  - (b) any dedication to or use by the public of any right of way or other easement over any part of the land?
  - (c) any latent defects in the property?
21. Has the vendor any notice or knowledge that the property is affected by the following:
- (a) any resumption or acquisition or proposed resumption or acquisition?
  - (b) any notice requiring work to be done or money to be spent on the property or any footpath or road adjoining? If so, such notice must be complied with prior to completion.
  - (c) any work done or intended to be done on the property or the adjacent street which may create a charge on the property or the cost of which might be or become recoverable from the purchaser?
  - (d) any sum due to any local or public authority? If so, it must be paid prior to completion.
  - (e) any realignment or proposed realignment of any road adjoining the property?
  - (f) any contamination?
- 22.
- (a) Does the property have the benefit of water, sewerage, drainage, electricity, gas and telephone services?
  - (b) If so, do any of the connections for such services pass through any adjoining land?
  - (c) Do any service connections for any other property pass through the property?
23. Has any claim been made by any person to close, obstruct or limit access to or from the property or to an easement over any part of the property?

### **Capacity**

24. If the Contract discloses that the vendor is a trustee, evidence should be produced to establish the trustee's power of sale.

**Requisitions and transfer**

25. If the transfer or any other document to be handed over on completion is executed pursuant to a power of attorney, then at least 7 days prior to completion a copy of the registered power of attorney should be produced and found in order.
26. If the vendor has or is entitled to have possession of the title deeds the Certificate Authentication Code must be provided 7 days prior to settlement.
27. Searches, surveys, enquiries and inspection of title deeds must prove satisfactory.
28. The purchaser reserves the right to make further requisitions prior to completion.
29. Unless we are advised by you to the contrary prior to completion, it will be assumed that your replies to these requisitions remain unchanged as at completion date.





Revenue

Enquiry ID	3534553
Agent ID	112176669
Issue Date	23 Jul 2021
Correspondence ID	1730929526
Your reference	104348 contract

DYE & DURHAM PROPERTY PTY LTD  
Post Office Box A2151  
SYDNEY SOUTH NSW 1235

**Land Tax Certificate under section 47 of the *Land Tax Management Act, 1956*.**

This information is based on data held by Revenue NSW.

---

Land ID	Land address	Taxable land value
D755795/27	PALMERS OAKY RD PALMERS OAKY 2795	\$4 473

There is **no land tax** (including surcharge land tax) charged on the land up to and including the 2021 tax year.

---

Yours sincerely,

Scott Johnston

Chief Commissioner of State Revenue

## Important information

### Who is protected by a clearance certificate?

A clearance certificate states whether there is any land tax (including surcharge land tax) owing on a property. The certificate protects a purchaser from outstanding land tax liability by a previous owner, however it does not provide protection to the owner of the land.

### When is a certificate clear from land tax?

A certificate may be issued as 'clear' if:

- the land is not liable or is exempt from land tax
- the land tax has been paid
- Revenue NSW is satisfied payment of the tax is not at risk, or
- the owner of the land failed to lodge a land tax return when it was due, and the liability was not detected at the time the certificate was issued.

**Note:** A clear certificate does not mean that land tax was not payable, or that there is no land tax adjustment to be made on settlement if the contract for sale allows for it.

### When is a certificate not clear from land tax?

Under section 47 of the *Land Tax Management Act 1956*, land tax is a charge on land owned in NSW at midnight on 31 December of each year. The charge applies from the taxing date and does not depend on the issue of a land tax assessment notice. Land tax is an annual tax so a new charge may occur on the taxing date each year.

### How do I clear a certificate?

A charge is removed for this property when the outstanding land tax amount is processed and paid in full. Payment can be made during settlement via an accepted Electronic Lodgement Network or at an approved settlement room.

To determine the land tax amount payable, you must use one of the following approved supporting documents:

- Current year land tax assessment notice. This can only be used if the settlement date is no later than the first instalment date listed on the notice. If payment is made after this date interest may apply.
- Clearance quote or settlement letter which shows the amount to clear.

The charge on the land will be considered removed upon payment of the amount shown on these documents

### How do I get an updated certificate?

A certificate can be updated by re-processing the certificate through your Client Service Provider (CSP), or online at [www.revenue.nsw.gov.au](http://www.revenue.nsw.gov.au).

Please allow sufficient time for any payment to be processed prior to requesting a new version of the clearance certificate.

### Land value, tax rates and thresholds

The taxable land value shown on the clearance certificate is the value used by Revenue NSW when assessing land tax. Details on land tax rates and thresholds are available at [www.revenue.nsw.gov.au](http://www.revenue.nsw.gov.au).

## Contact details



Read more about Land Tax and use our online service at [www.revenue.nsw.gov.au](http://www.revenue.nsw.gov.au)



1300 139 816\*



Phone enquiries  
8:30 am - 5:00 pm, Mon. to Fri.

\* Overseas customers call +61 2 7808 6906  
Help in community languages is available.